

PRECEDENT: Bryant Park, New York City, New York

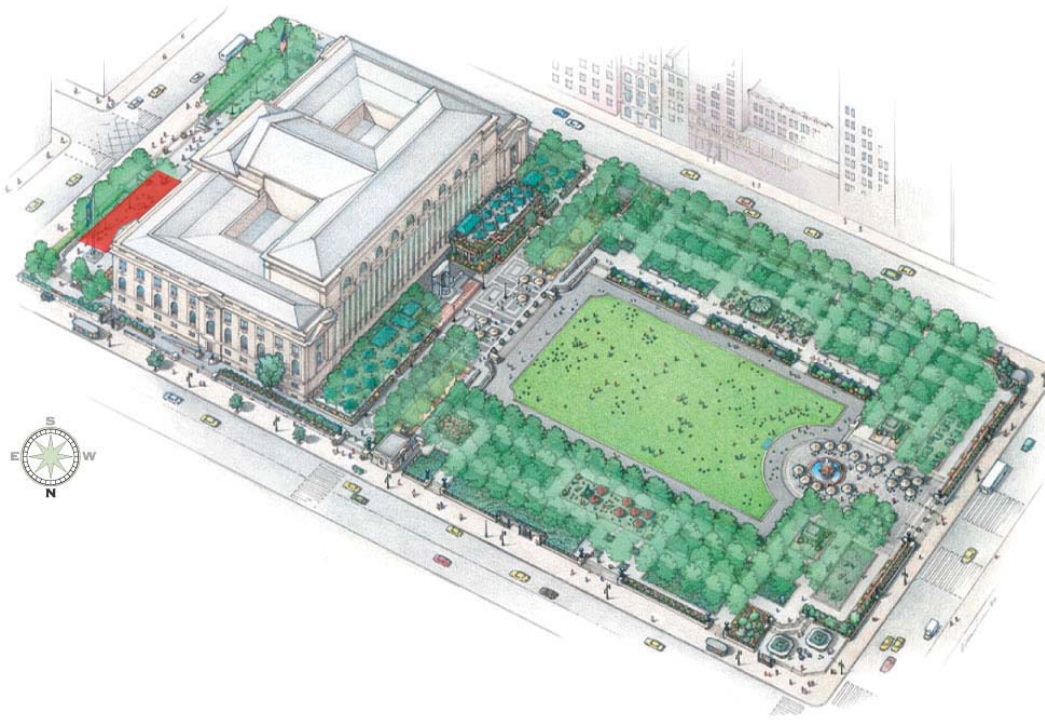

A 9.6 acre privately managed park though owned by NYC's Department of Parks and Recreation located in the borough of Manhattan. The park is built entirely over an underground structure that houses New York Public Library's archives which borders the eastern side. Since the park's renewal completed in 1992, it has received numerous awards and serves the public on a daily basis and hosts numerous large scale gatherings and events. The lawn is occasionally closed for maintenance.

PRECEDENT: Place des Vosges, Paris, France



Built in 1612 to celebrate the wedding of Henri IV and Anne of Austria. The architecture of surrounding buildings face onto the park which is a true square of (459 ft x 459 ft) 210,680 Square Feet. It is a public square that is bordered by allees of clipped linden trees set in gravel surrounding a large fountain and lawn.

PRECEDENT: Agnes Katz Plaza, Pittsburgh, Philadelphia



This plaza is 23,000 square foot public plaza in Pittsburgh that was created from a creative collaboration between landscape architect Dan Urban Kiley and sculptor Louise Bourgeois. It is an 'urban oasis' for the community and hosts many outdoor live performances.

PRECEDENT: Post Office Square, Boston, Massachusetts



A privately owned, but publicly accessible park in the financial district of Boston that is built upon a parking garage. Revenues from the parking fund maintain the park. It is a 1.7 acre park site that is popularly occupied during lunch hours. The park includes lawn, shade trees, display gardens, a cafe and a fountain.

PRECEDENT: Squares of Savannah, Georgia



Originally conceived in 1733 with original city planning of Savannah, Georgia. Currently, there are 22 squares in the city
Each varies in size, 200 lf x 100-300lf (2,000 - 6,000sf)
All squares are part of the historic district and vary in character. Ellis square was recently reclaimed and redeveloped with an interactive water feature.