

# COMO REGIONAL PARK McMURRAY AREA TRANSPORTATION IMPROVEMENTS

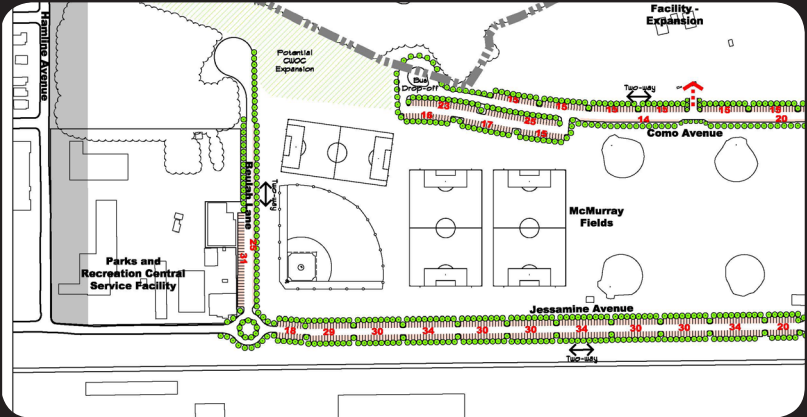







































































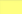





# Como Woodland & Outdoor Classroom

*Como Woodland and Outdoor Classroom is a 17¼ acre restored woodland which provides ecological education and historical interpretation, habitat for wildlife, and an urban woodland oasis for school children and adults.*

## Legend

- |   |   |
|---|---|
|  <b>CONIFEROUS FOREST</b> 1.9 ACRES<br>AN EXISTING GROVE OF CONIFEROUS TREES PROVIDES A SETTING FOR A DEVELOPED CONIFEROUS FOREST  |  <b>SITE BOUNDARY</b>          |
|  <b>DISPLAY GARDENS</b> .85 ACRES<br>CURRENTLY UTILIZED BY PARKS AND RECREATION GARDENERS, THIS SPACE CAN HIGHLIGHT USEFUL NATIVE SPECIES IN THE HOME LANDSCAPE.   |  <b>SHARED-USE TRAIL</b>       |
|  <b>TRANSITIONAL WOODLAND</b> 3.2 ACRES<br>WOODLAND OF VARIOUS SPECIES OF PLANTS NOT TYPICALLY FOUND AS A WOODLAND COMMUNITY.  |  <b>PEDESTRIAN TRAIL</b>       |
|  <b>OAK SAVANNA</b> 2.3 ACRES<br>THE TRANSITION BETWEEN FOREST AND GRASSLAND - A MIXTURE OF GRASSES AND TREES.   |  <b>GRAVEL TRAIL</b>         |
|  <b>OAK WOODLAND</b> 5.8 ACRES<br>THE NATIVE PLANT COMMUNITY PREDOMINANT IN THE AREA. OAK SPECIES AND RESPECTIVE UNDERSTORY PLANTINGS MAKE UP THIS COMMUNITY.  |  <b>BOARDWALK</b>            |
|  <b>SEDGE MEADOW</b> .35 ACRES<br>NORMALLY FOUND IN LOW-LYING, FLAT, RIVER OR STREAM BOTTOMS, THE PERPETUALLY SHADED, RICH, MOIST SOILS PROVIDE THE OPPORTUNITY TO EXHIBIT THIS PLANT COMMUNITY.                 |  <b>CLASSROOM STUDY AREA</b> |
|  <b>TALLGRASS PRAIRIE</b> .95 ACRES<br>A TYPE OF GRASSLAND DOMINATED BY HERBACEOUS PLANTS, ESPECIALLY GRASSES AND NEARLY ABSENT OF TREES.  |  <b>INTERPRETIVE AREA</b>    |
|  <b>EPHEMERAL WETLAND</b> 2.3 ACRES<br>EPHEMERAL WETLANDS TEMPORARILY HOLD WATER, OFTENTIMES, THESE WETLANDS DRY UP IN MID TO LATE SUMMER. THIS AREA MAY ALLOW BREEDING OF CERTAIN AMPHIBIANS AND INVERTEBRATES. |  <b>SHELTER/RESTROOMS</b>    |
|   |  <b>OVERLOOK AREA</b>        |
|   |  <b>ENTRANCE - PRIMARY</b>   |
|   |  <b>ENTRANCE - SECONDARY</b> |

BEULAH LN.

Existing Artificial Turf Soccer Fields

HORTON AVE.

Route of historic Como - Harriet Streetcar Line

Existing Tennis Courts

COMO AVE.

August 18, 2008



# COMO PARK

## Vehicular Circulation & Parking Study

# EX

Existing Conditions and  
Vehicular Circulation

# (+)

- \* 357 Ex. Parking Stalls
- \* Opportunity to acquire land along RR for parking
- \* Wooded Low area very suitable for additon to CWOC

# (-)

- \* Poor circulation pattern
- \* Unsafe intersection at Como and Beulah
- \* Poor layout of existing field parking
- \* Restricted visibility at Lexington and Jessamine under bridge
- \* Bleachers poorly oriented to fields
- \* Wooded Low area isolated
- \* Poor access to artificial turf fields

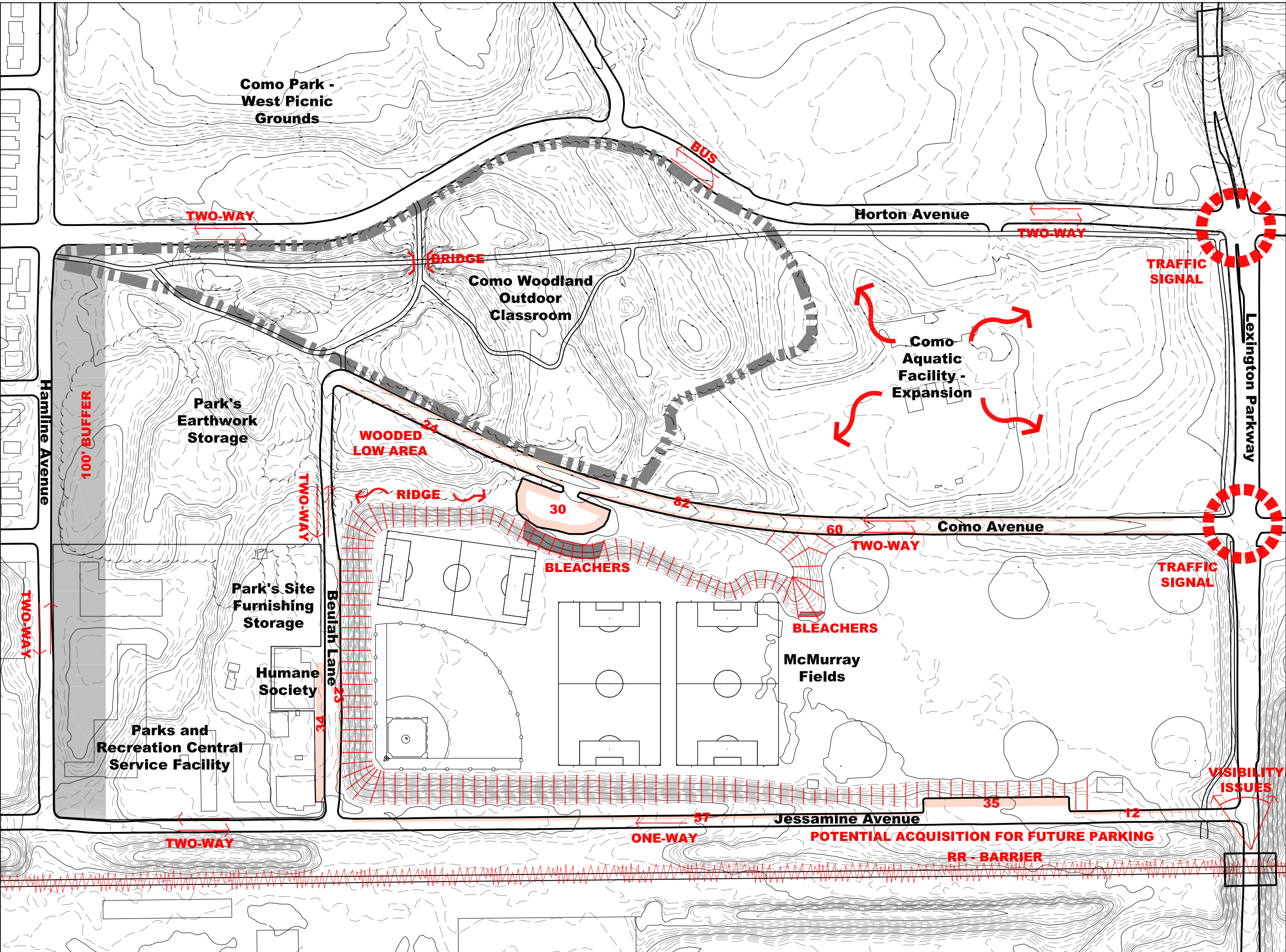
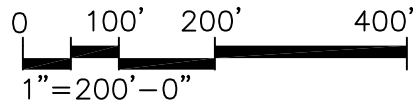



FIGURE 35: OVERALL SITE PLAN





## FEATURES

- Jessamine Ave returns to two way traffic and connects at intersection of Como and Lexington
- Section of Como and Beulah removed and cul-de-sac'd
- New parking lots at Como Pool, CWOC and the entire length of Jessamine
- Shared use trail connection between CWOC and Lexington Parkway tunnel

## LEGEND

- Existing trails
- Proposed Trails
- Removed Sections of Road
- Existing Roads
- Proposed Roads
- Fencing
- Railroad
- Building
- Drop-off point
- Parking

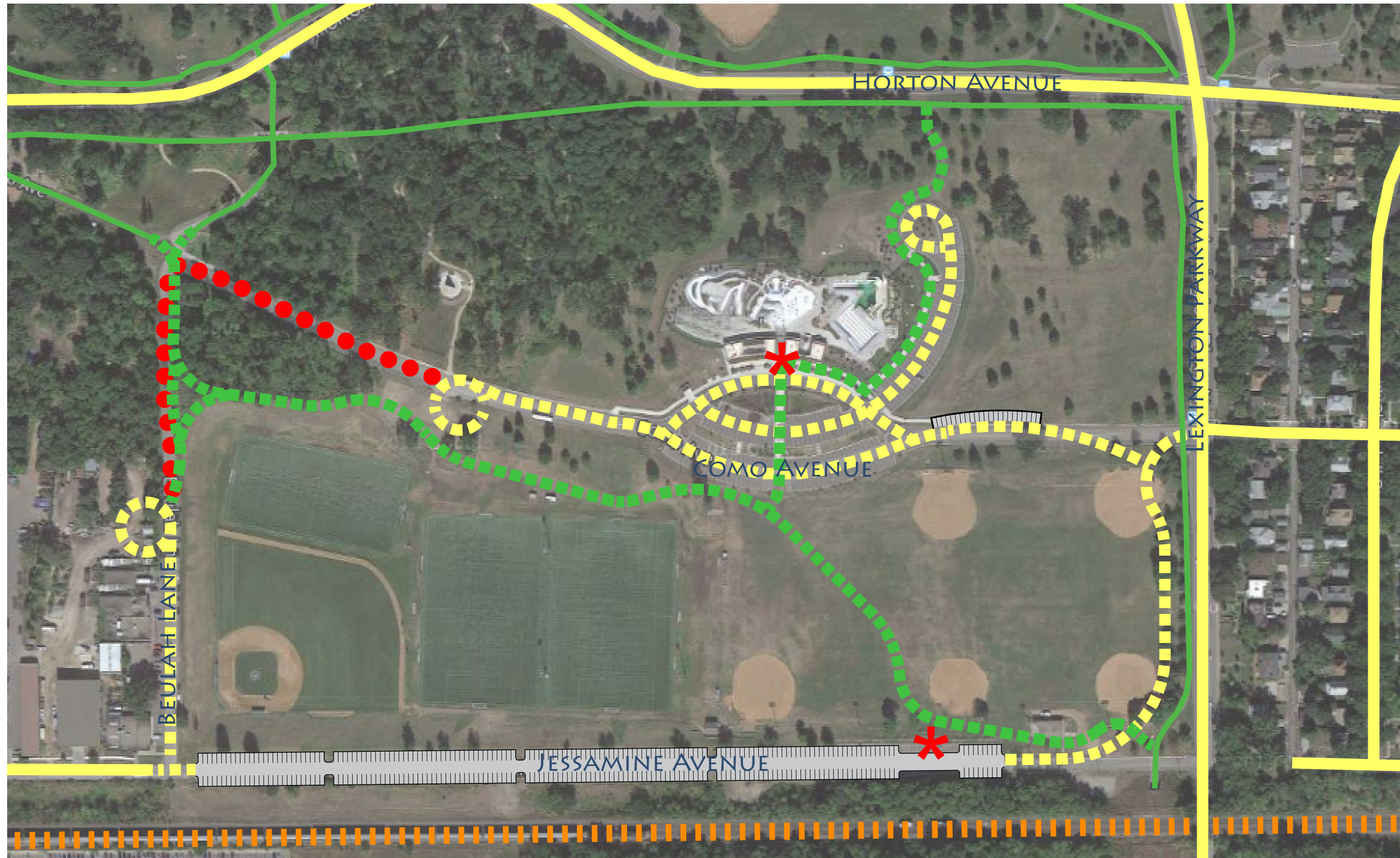

# Proposed Road Layout Plan - Developed with Pool Study

## COMO REGIONAL PARK - McMURRAY FIELD AREA

### TRANSPORTATION PLANNING

DEPARTMENT OF  
PARKS AND RECREATION -  
DESIGN and  
CONSTRUCTION  
SECTION

DECEMBER 2014





# Goals and Objectives

## **1. Improve site access and circulation**

- *Improve or remove site access points with limited visibility or poor alignment*
- *Provide parking in locations that is convenient to site uses*
- *Investigate opportunities to expand parking facilities in underutilized areas*
- *Provide sidewalk and trail connections to, and through, the site*
- *Provide opportunities for multi-modal transportation such as Como Shuttle/  
Circulator service and NiceRide*
- 
- 
-



# Goals and Objectives

## **2. Enhance user's experience of the facilities**

- *Improve access to soccer and baseball fields*
- *Provide attractive and informative signage where appropriate*
- *Provide attractive and adequate lighting for site users*
- *Provide accessibility for users of all abilities*
- *Introduce traffic calming measures*
- 
- 
-



# Goals and Objectives

## **3. Enhance the environment**

- *Integrate stormwater management*
- *Minimize impact to surrounding land uses*
- *Utilize vegetation to improve park experience*
- 
- 
-



# Project Schedule

## **Design**

*September 22, 2015 - Design Workshop #1*

*October 27, 2015 - Design Workshop #2*

*December 15, 2015 - Open House*

## **Construction Document preparation**

## **Bidding**

## **Construction**

*Summer 2016*



PRELIMINARY  
TRAFFIC  
DATA

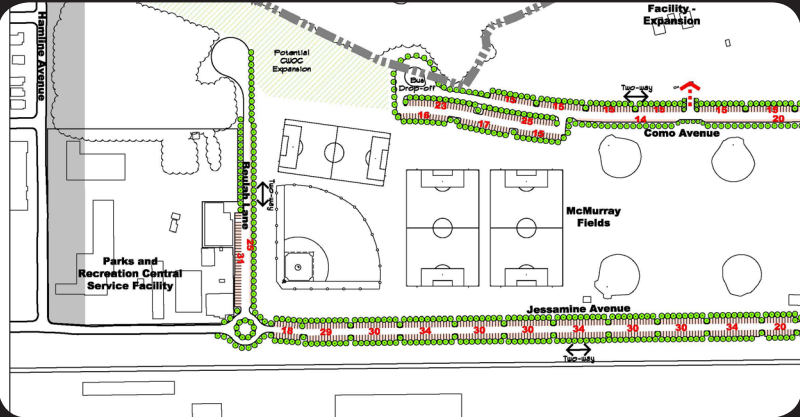



# Daily Traffic Volumes

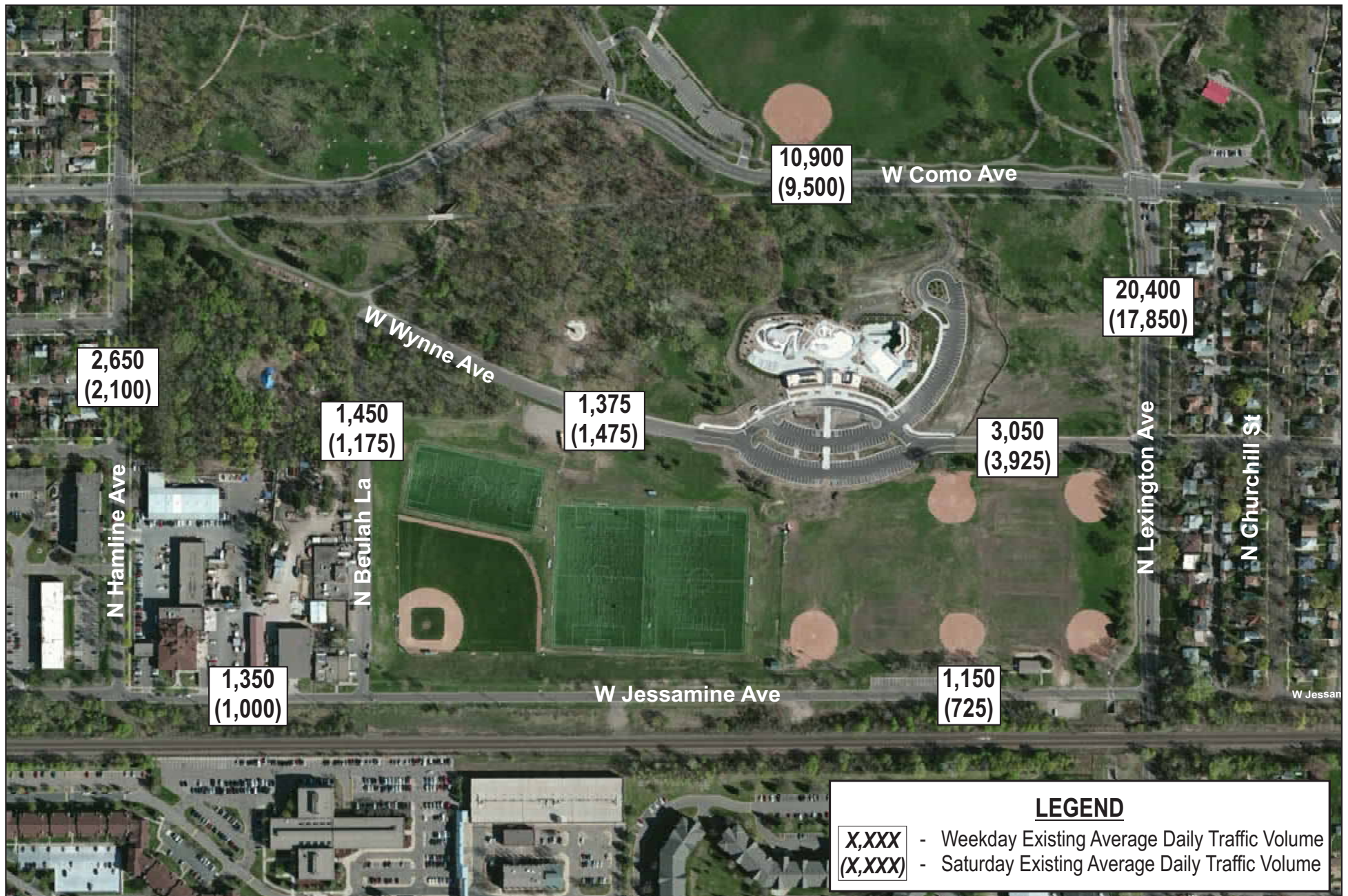



# Daily Volume Profiles

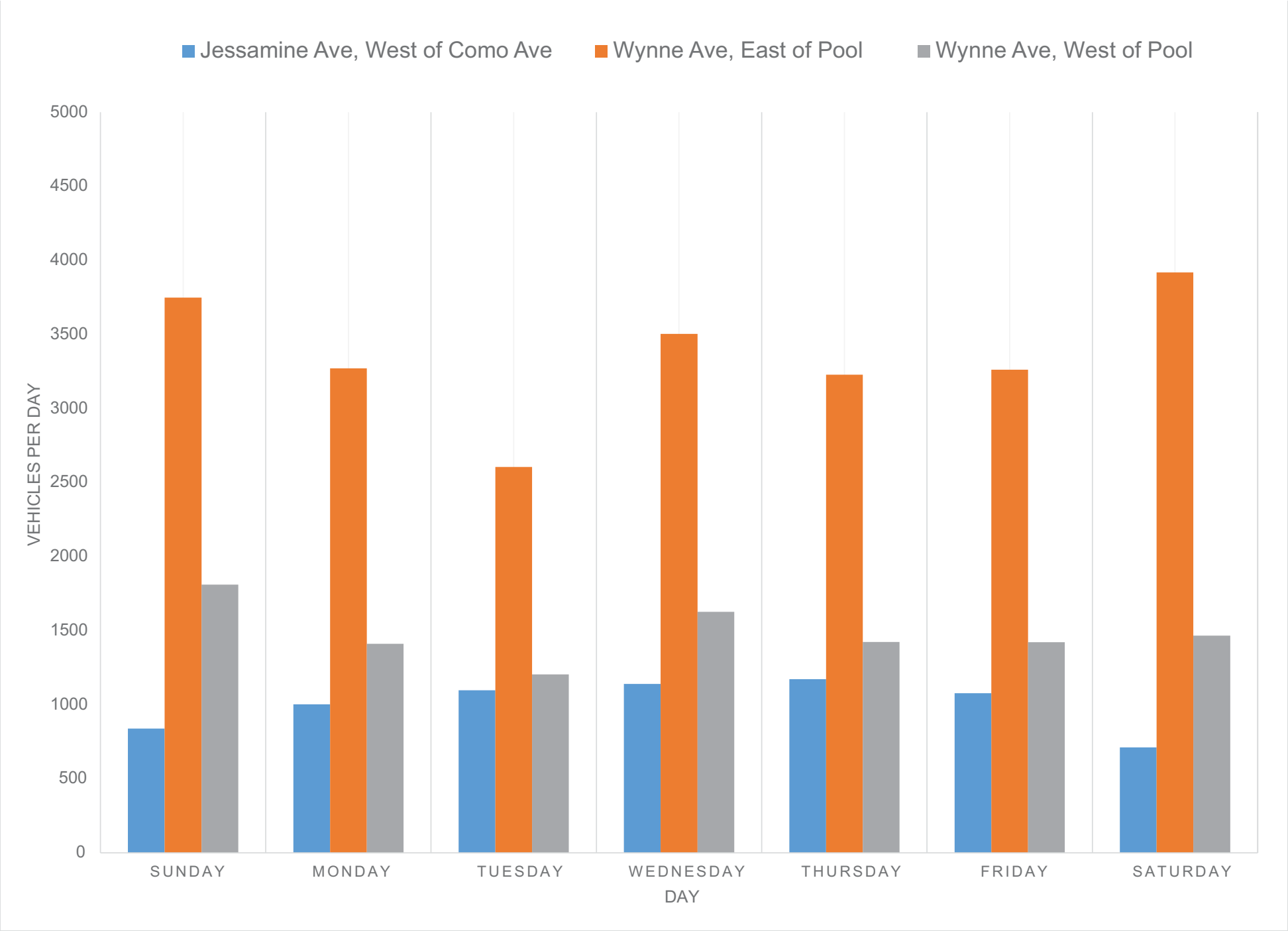



# Hourly Volume Profiles

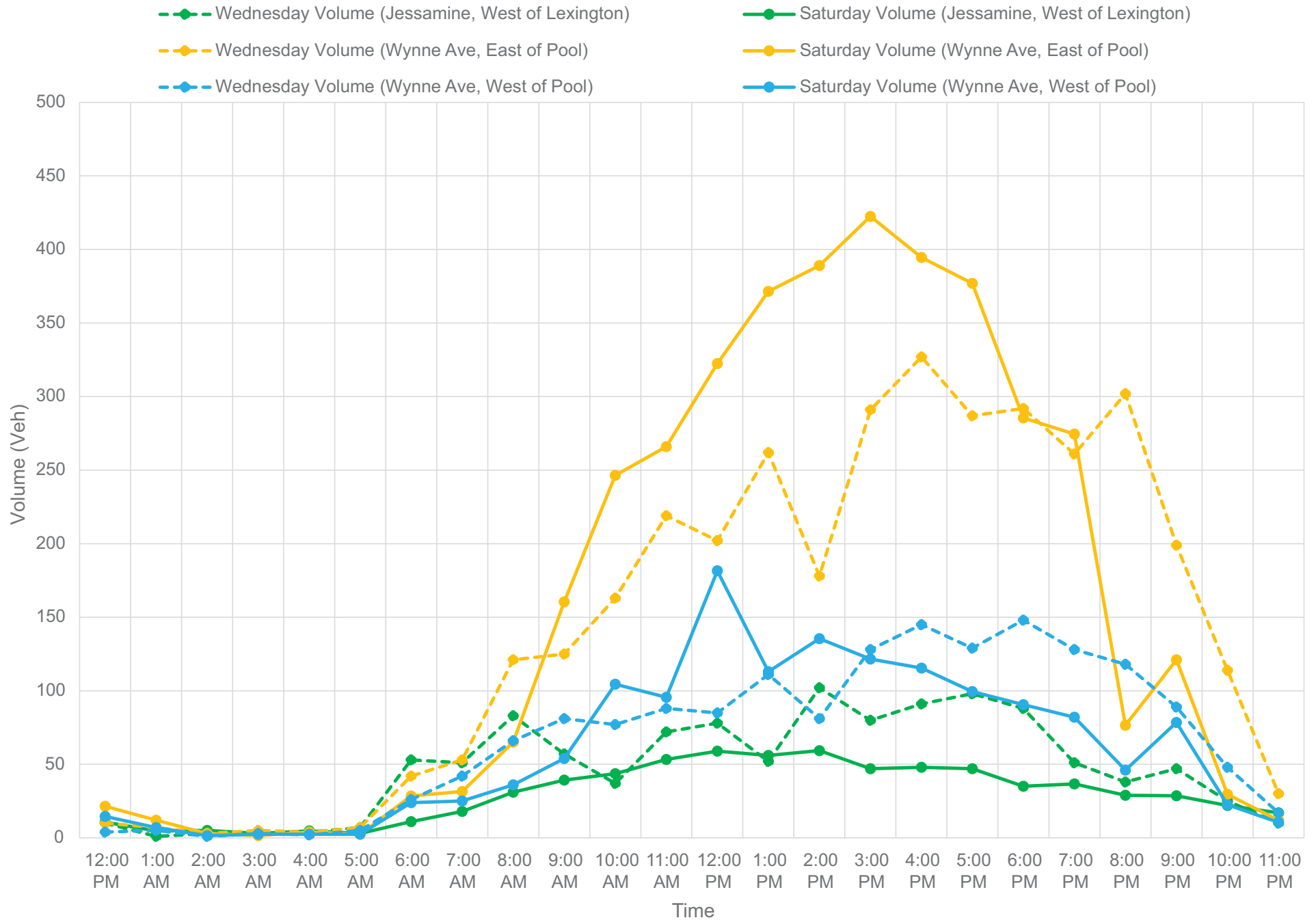



# Intersection Capacity Analysis

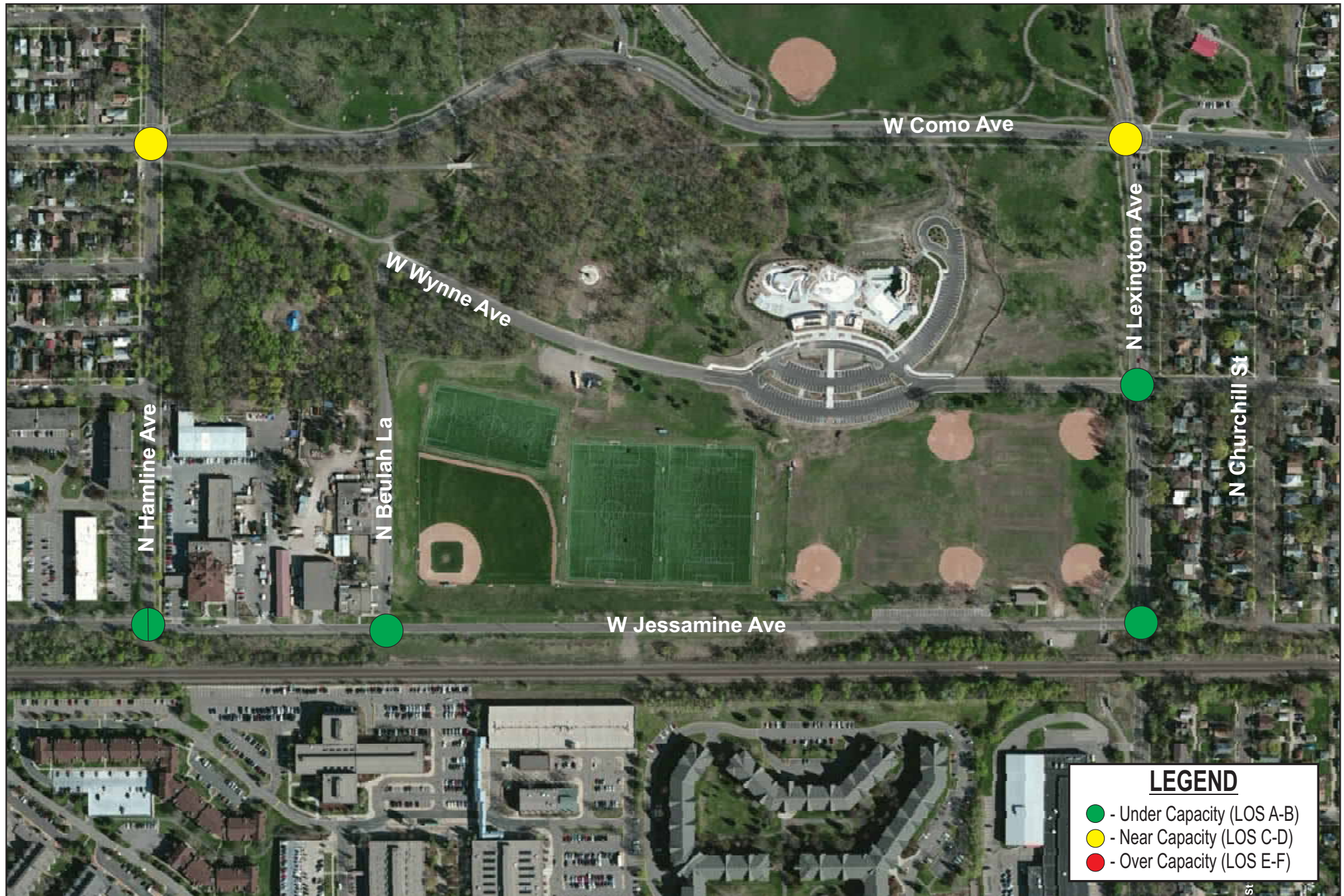



# Saturday 2:45 P.M. - Como Pool Peak

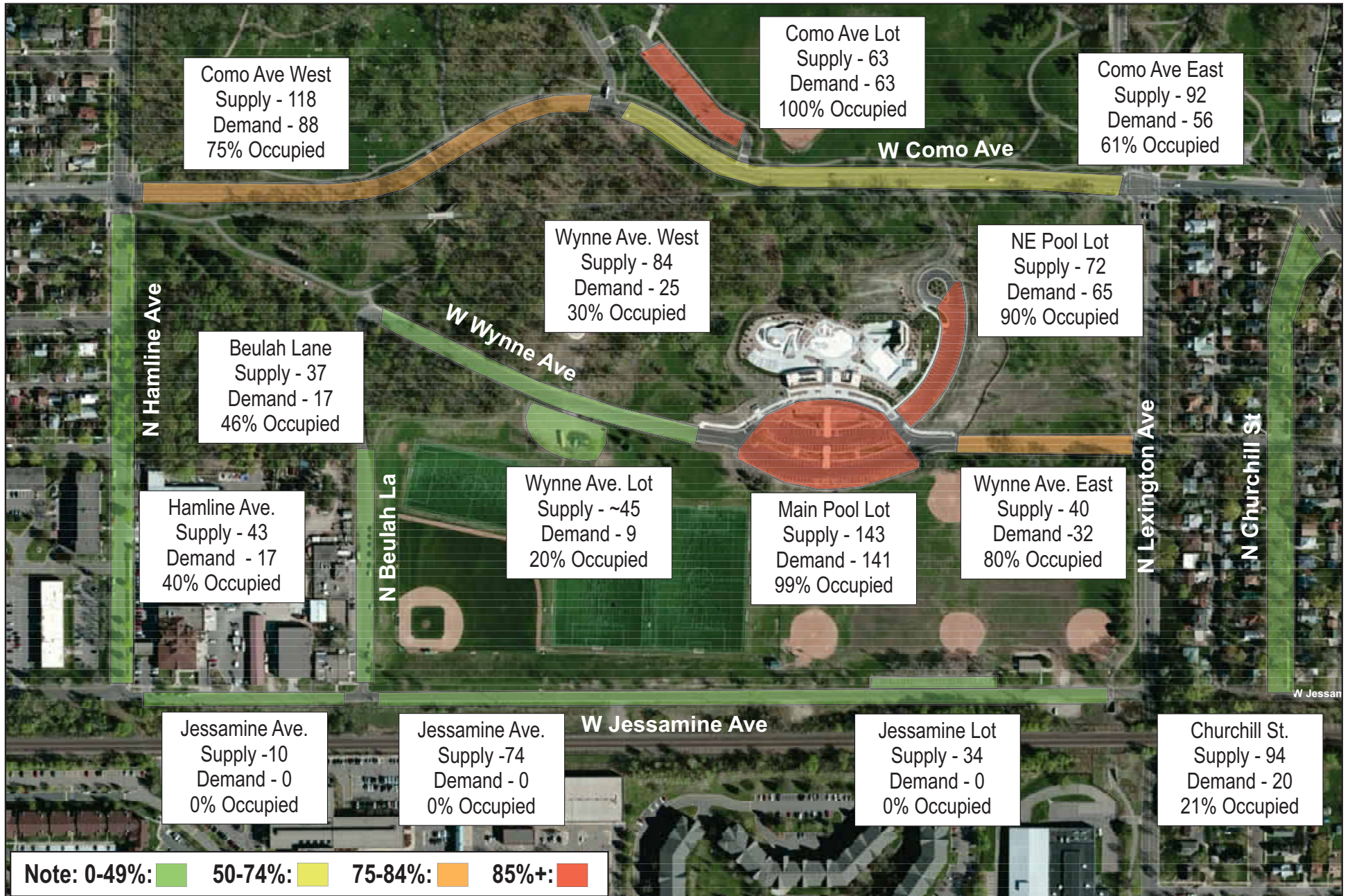



# Weekday 1:30 P.M. - Como Pool Peak

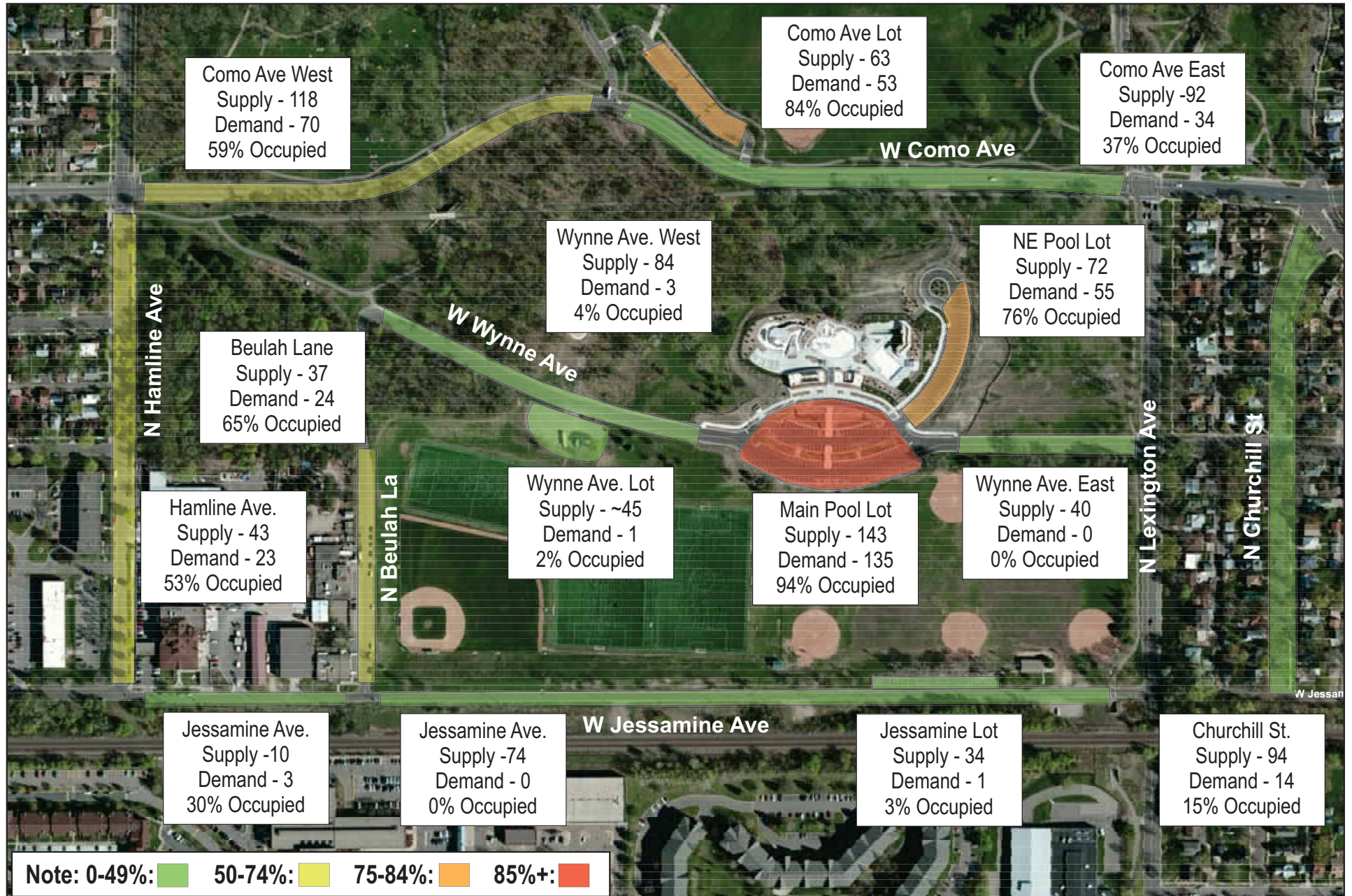



# Weekday 3:45 P.M. - Transition Period

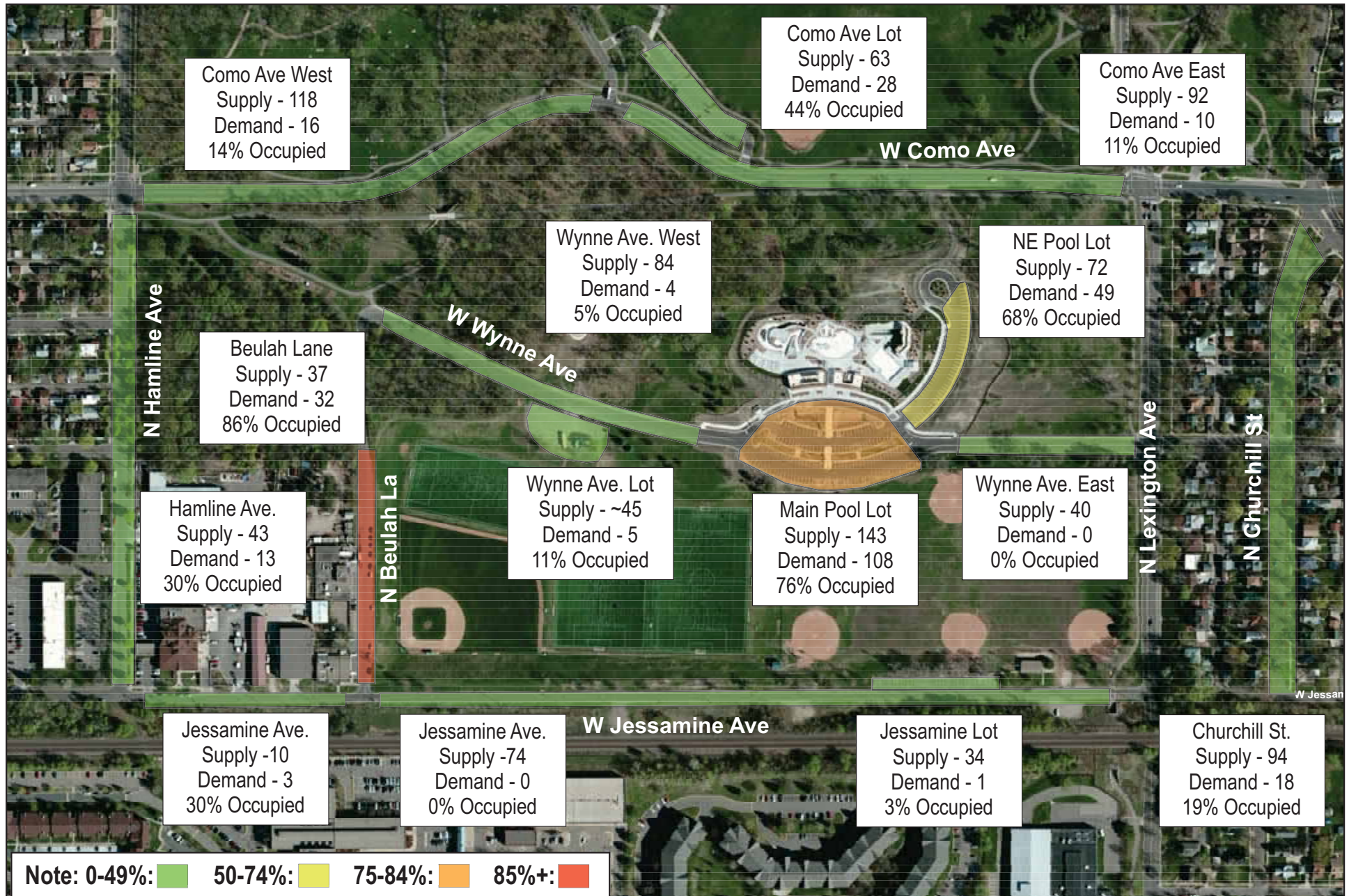



# Weekday 6:30 P.M. - McMurray Field Peak

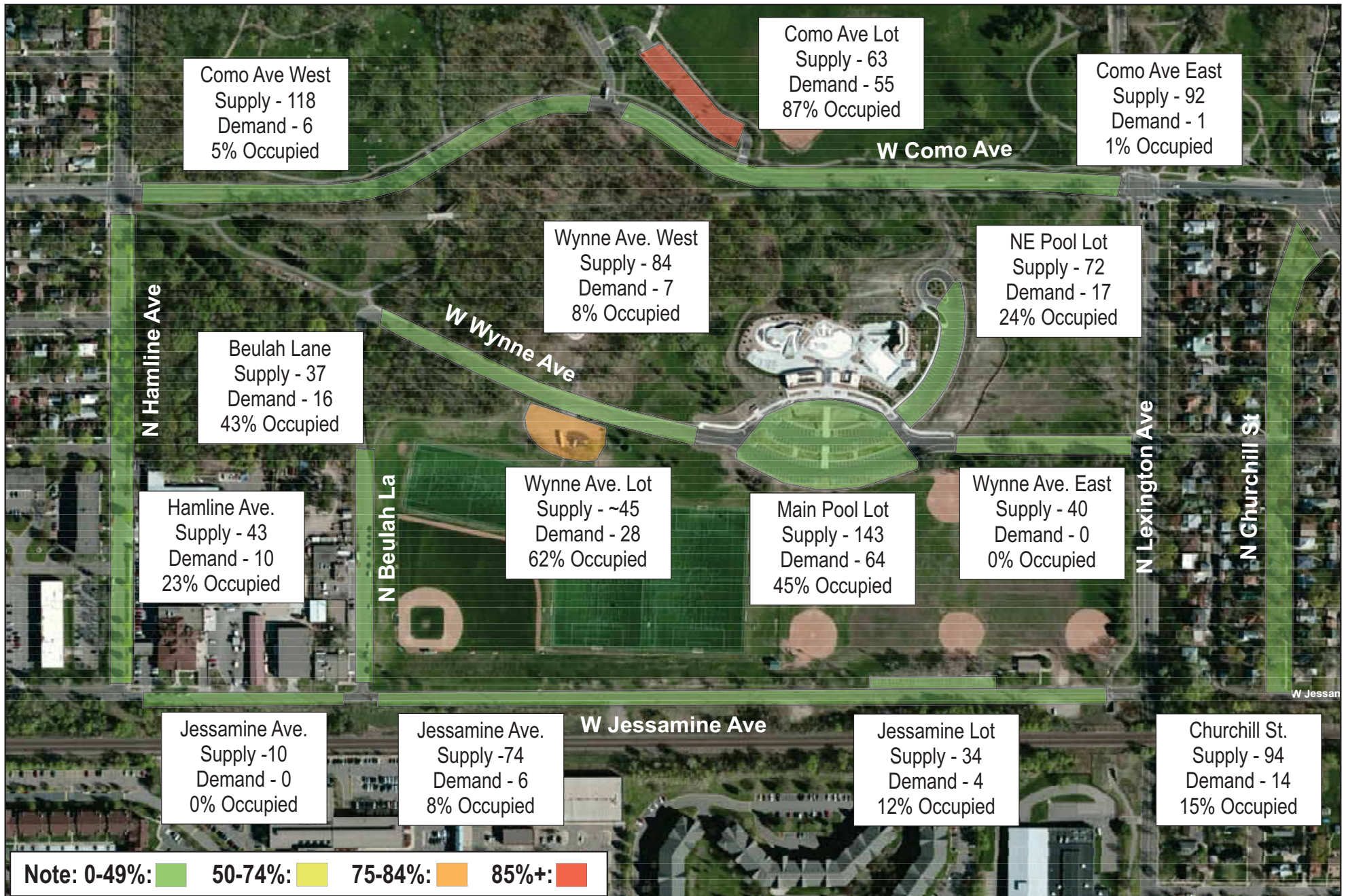



# POP-UP MEETING OVERVIEW AND FEEDBACK

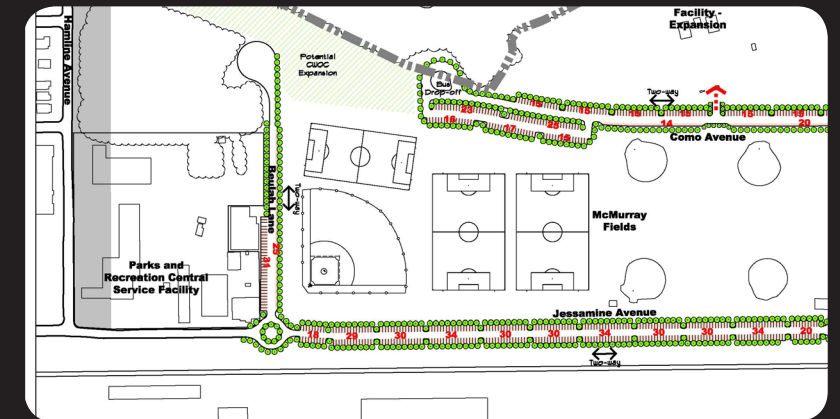
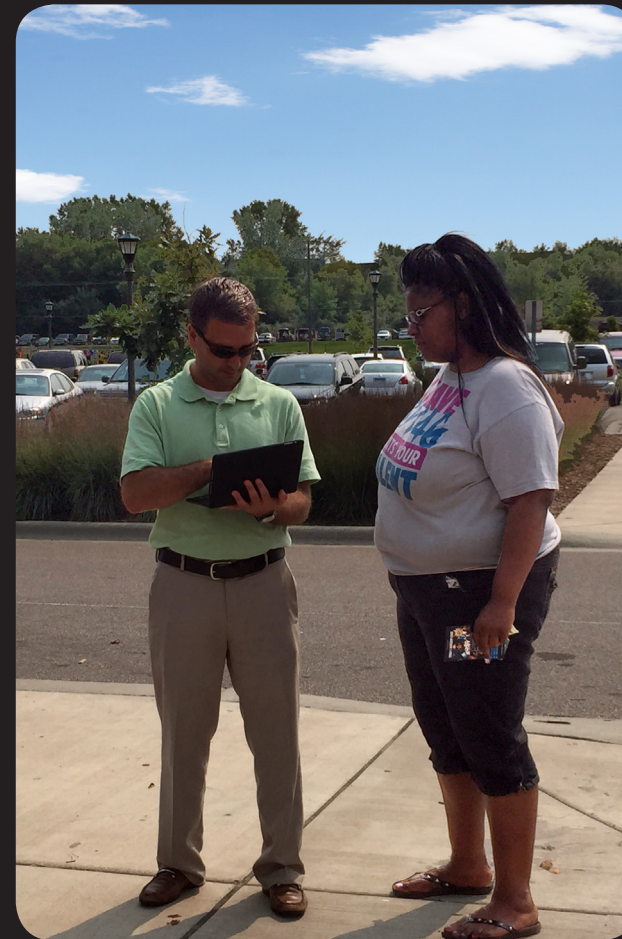



# Outreach Summary

## Overview

Meeting 1 – McMurray Fields Area  
Tuesday, August 25, 2015, 5:30 – 8:00 PM  
Surveys collected: 54

Meeting 2 – Como Pool  
Wednesday, August 26, 1:30 – 3:30 PM  
Surveys collected: 28

Meeting 3 – Como Pool  
Saturday, August 29, 1:00 – 3:00 PM  
Surveys collected: 29



## Responders

- **Most users are Saint Paul residents**
  - More people came from a distance for the fields than the pool
  - Users not from St. Paul mainly resided in eastern suburbs
- **Virtually all users arrived by car**
  - Users noted that this was necessary in order to transport items such as lawn chairs, coolers, pool items, etc.
- **Majority of field and pool users arrived in a carpool**



## Survey Results

- **Majority of park and pool users would not change the way they get to the area if bike/ped and bus improvements were made**
- **The supply of parking is generally adequate**
  - Although it can be limited during peak times (i.e. warm weather days and in between games)
  - People arrive early for games to ensure that adequate parking is available
- **McMurray Fields - hills leading down to the fields are a barrier to access, especially for elderly and/or handicapped persons**
- **Como Pool - Improvements to sidewalks, bike trails, and wayfinding are important**

## Suggestions for Improvements

- Staircase for easier field access along Jessamine Avenue and Wynne Avenue
- Ensure the fields are handicap accessible
- More seating at both the pool and field
- Public picnic area
- Field identification
- Additional restroom facilities
- Separate field and pool parking areas





# Existing Issues





# PRELIMINARY DESIGN CONCEPTS

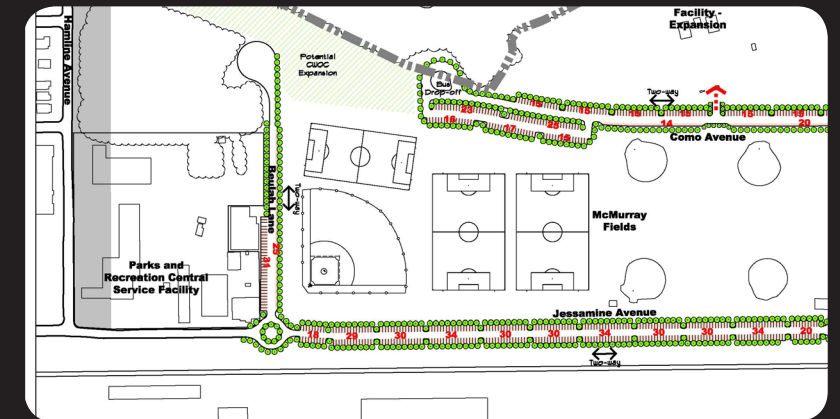
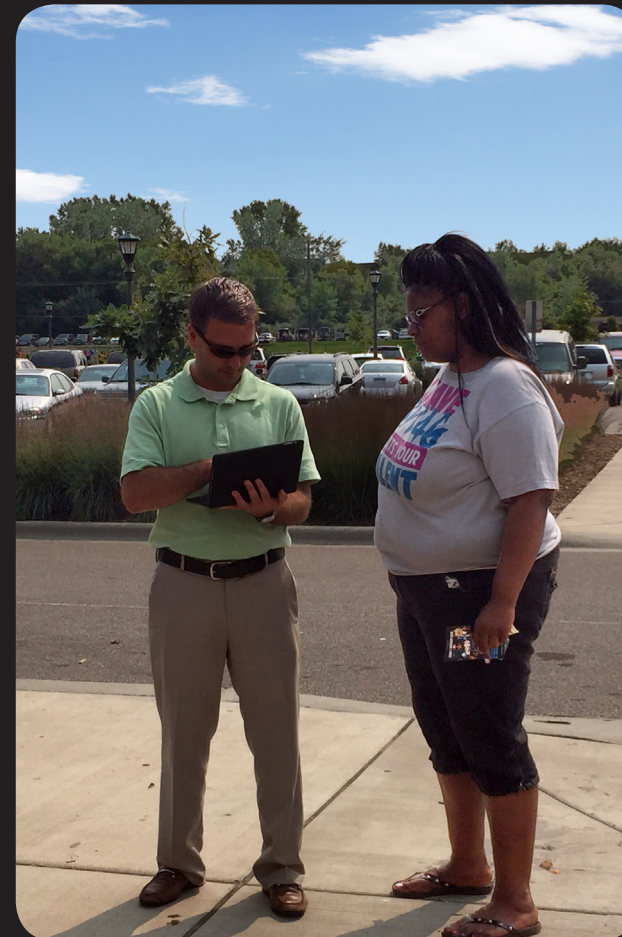



## Concept A - Jessamine Avenue





## Concept B - Wynne Avenue





# MEETING SUMMARY AND WRAP UP

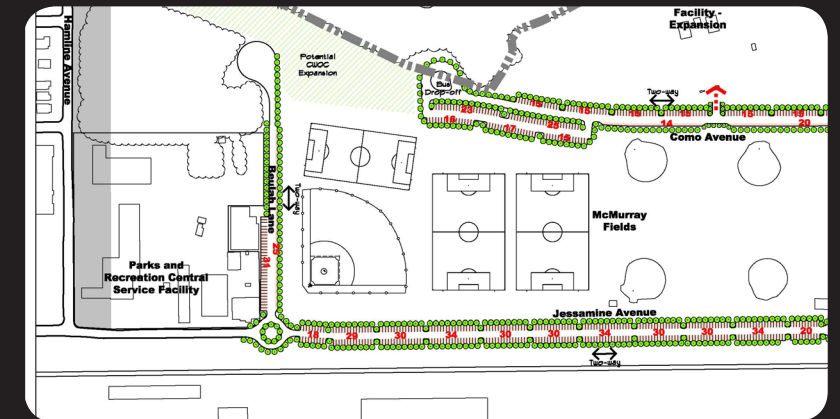
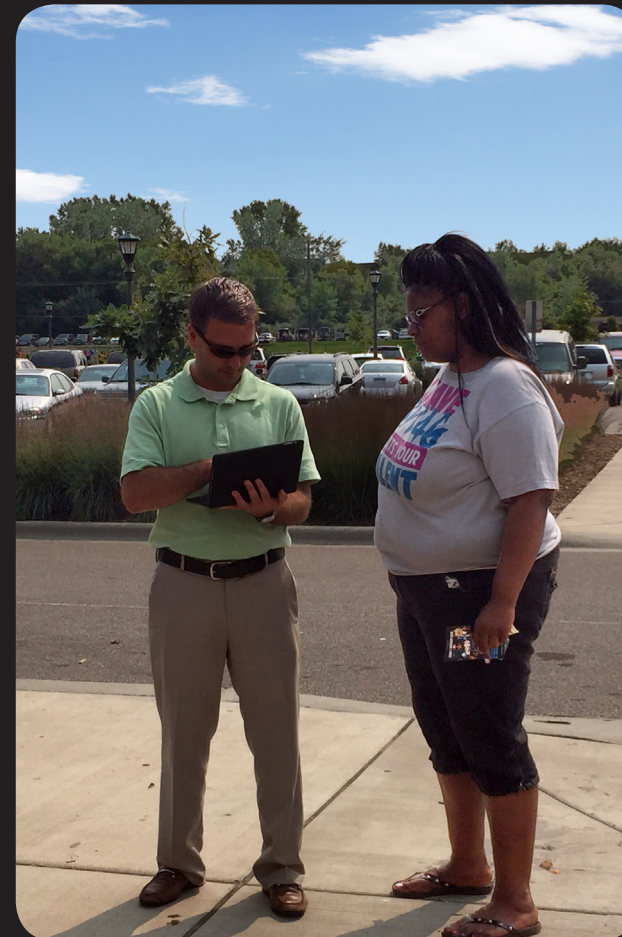



# Next Steps

**Design Workshop #2 -**

**Tuesday October 27, 2015 6:30 pm**

*THANK YOU!*