

Hillcrest Master Plan

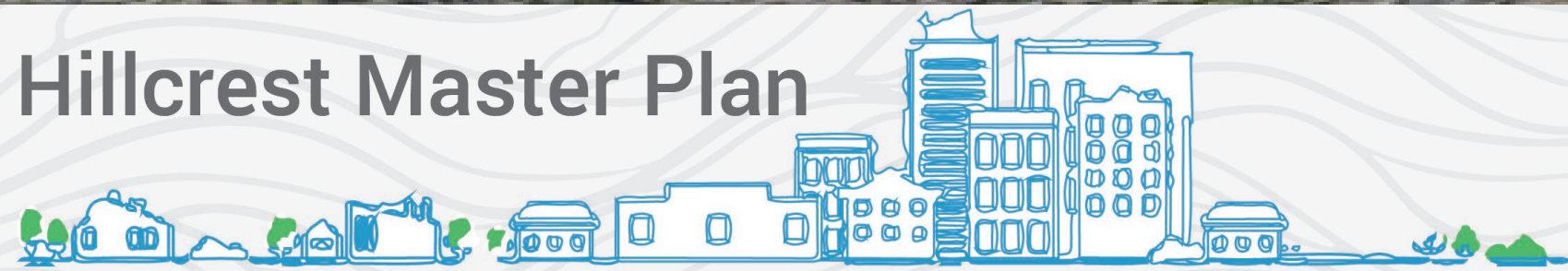

3D MASSING ILLUSTRATIONS

FEBRUARY 12, 2021



SAINT PAUL
MINNESOTA

HILLTOP SITE MASSING

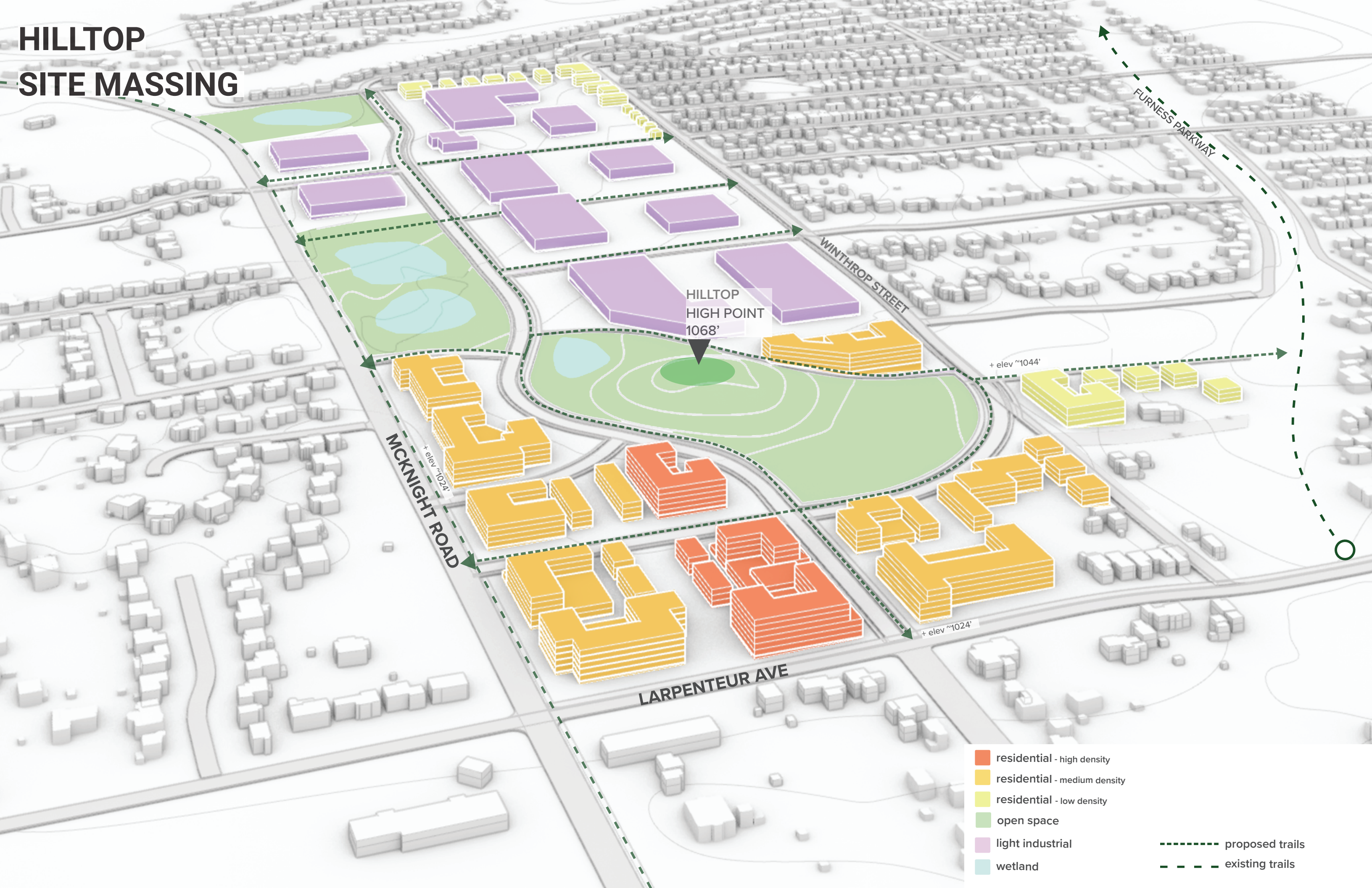

- residential - high density
- residential - medium density
- residential - low density
- open space
- light industrial
- wetland
- proposed trails
- existing trails

HILLTOP

VIEW FROM LARPENTEUR AVENUE LOOKING SOUTH



what could mid density residential look like?

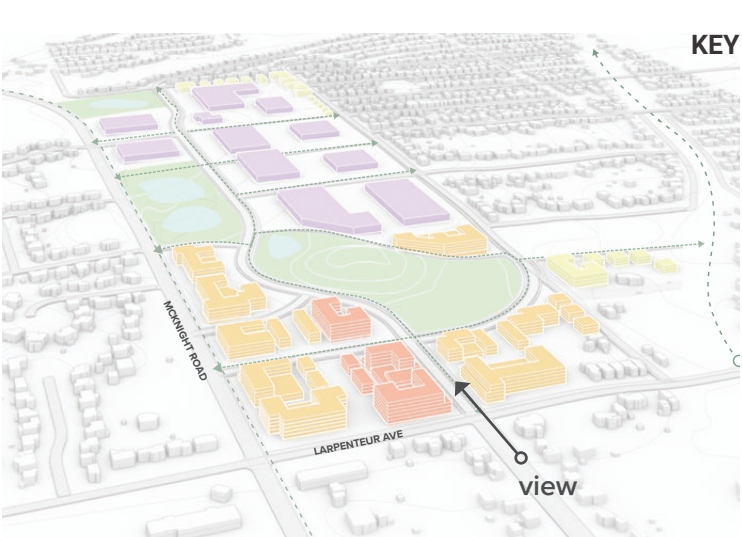

HILLTOP

VIEW FROM MCKNIGHT STREET LOOKING NORTH/NORTHWEST

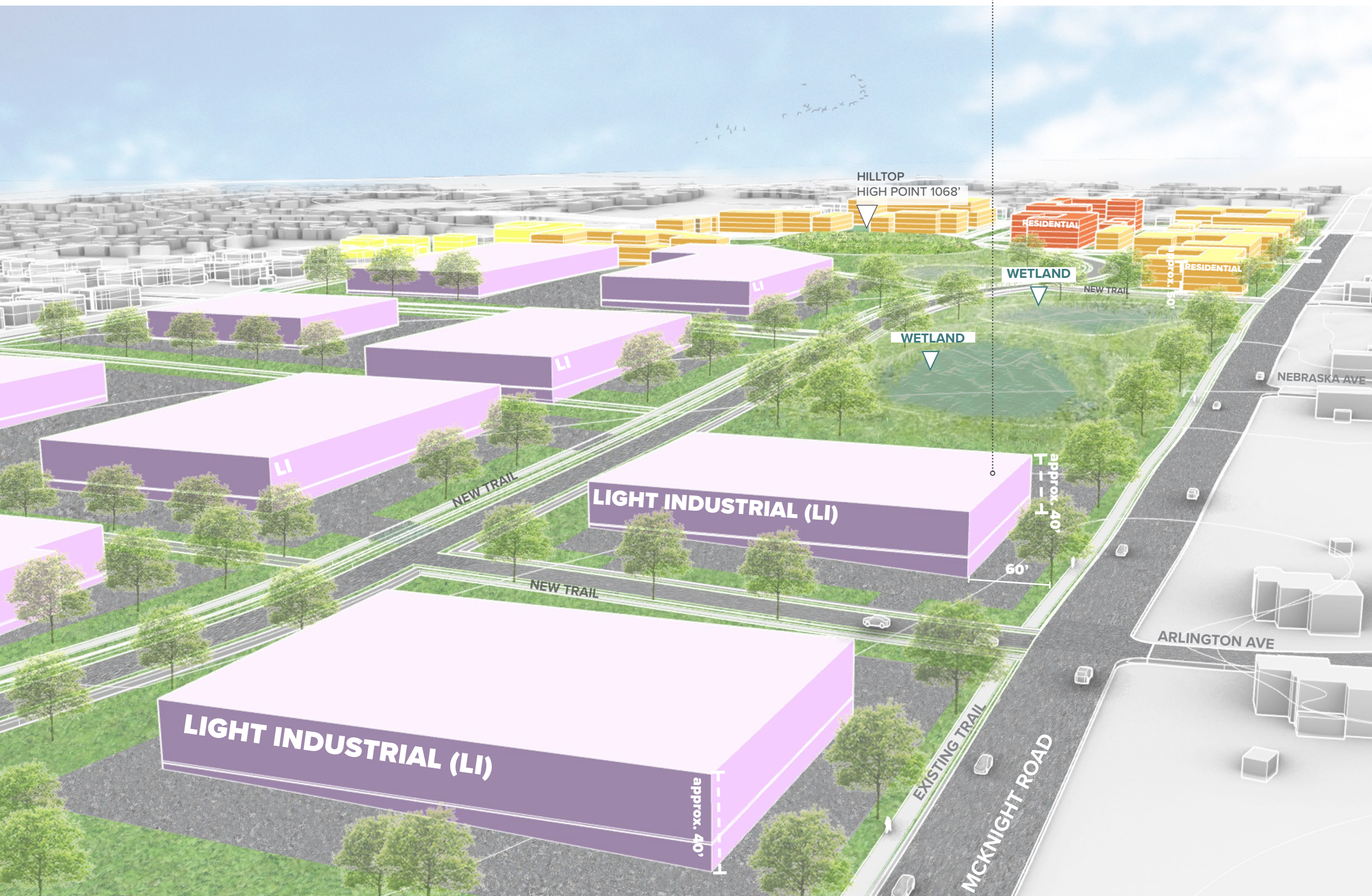

what could this light industrial look like?

BEACON'S BLUFF, SAINT PAUL

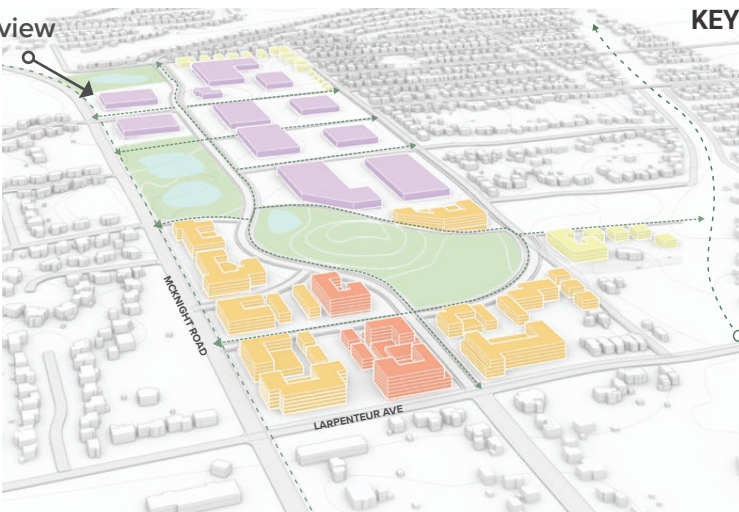

HILLTOP

VIEW FROM WINTHROP STREET LOOKING SOUTH/SOUTHEAST

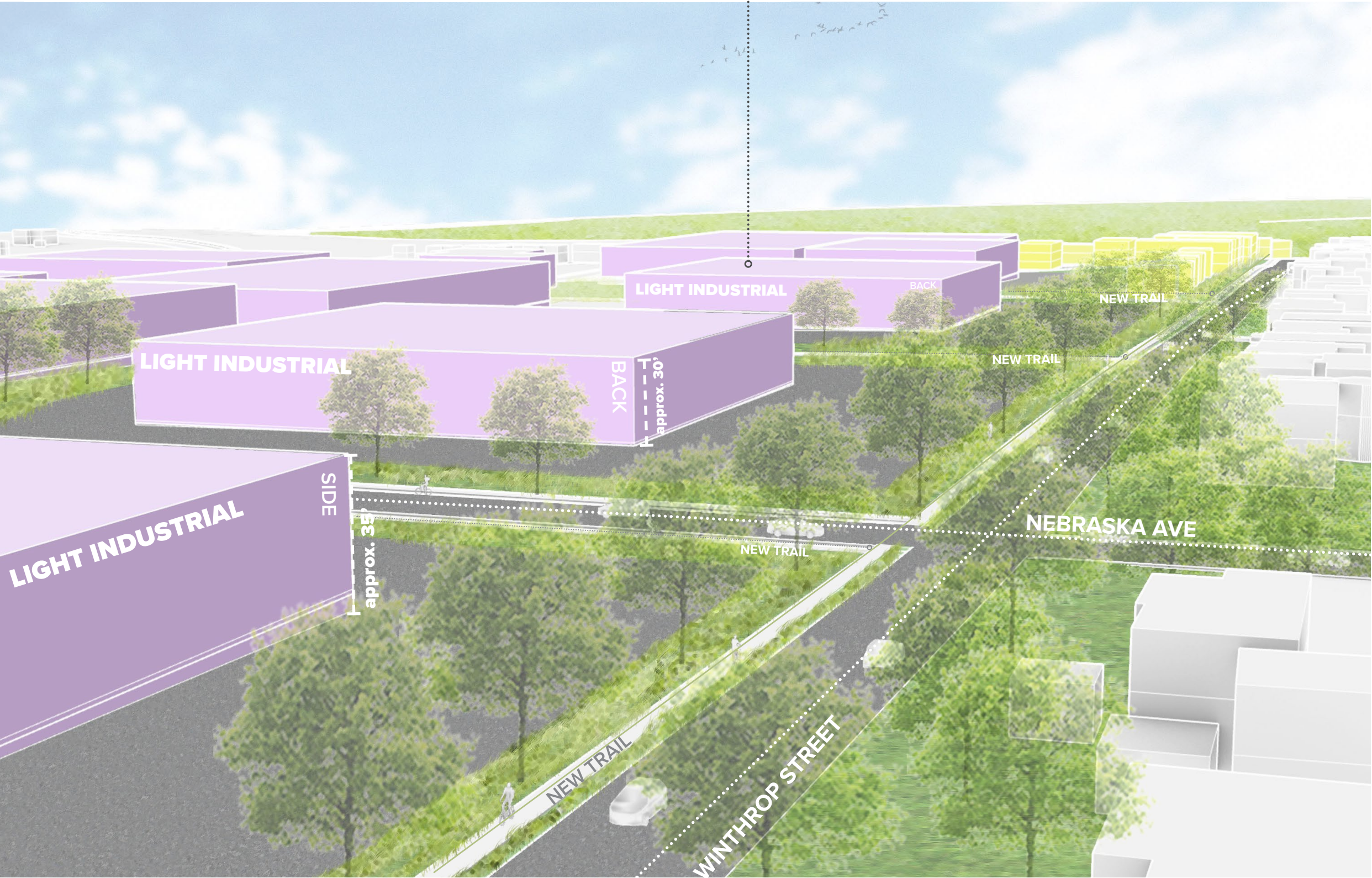

what could this light industrial look like?

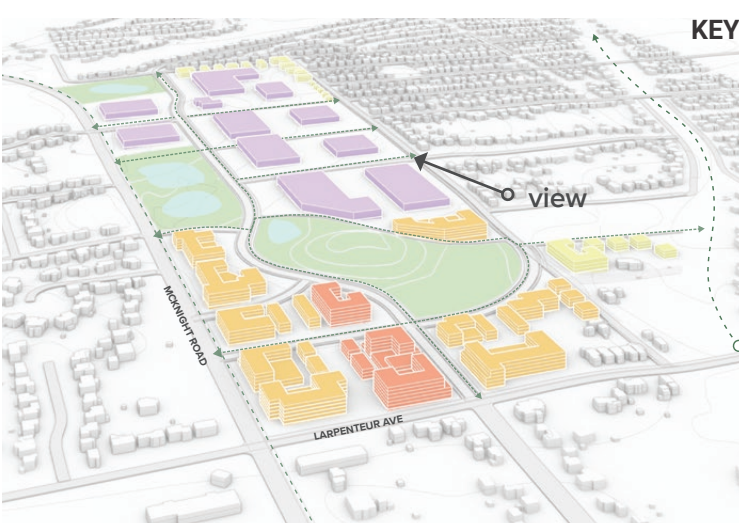

HILLTOP

VIEW FROM FURNESS TRAIL LOOKING EAST



what could mid density residential look like?

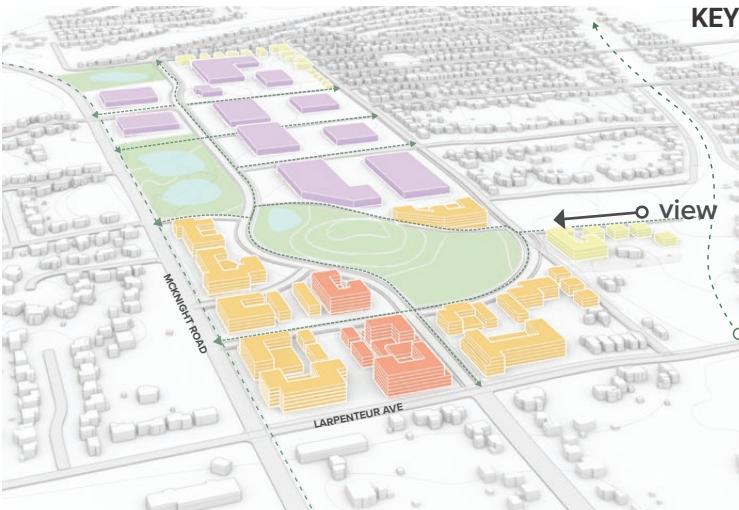

JOB FOCUS SITE MASSING

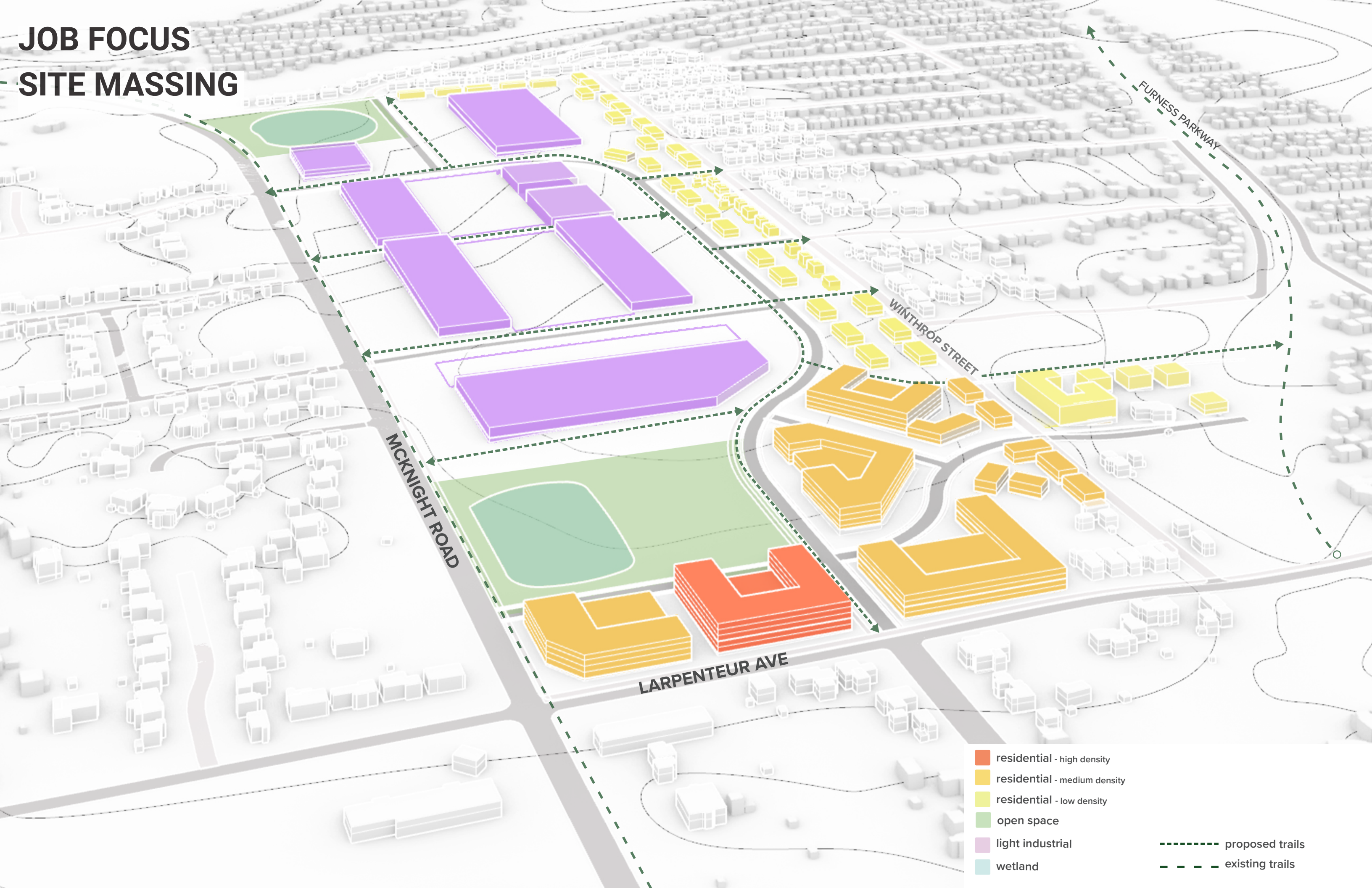

JOB FOCUS

VIEW FROM LARPENTEUR AVENUE LOOKING SOUTH

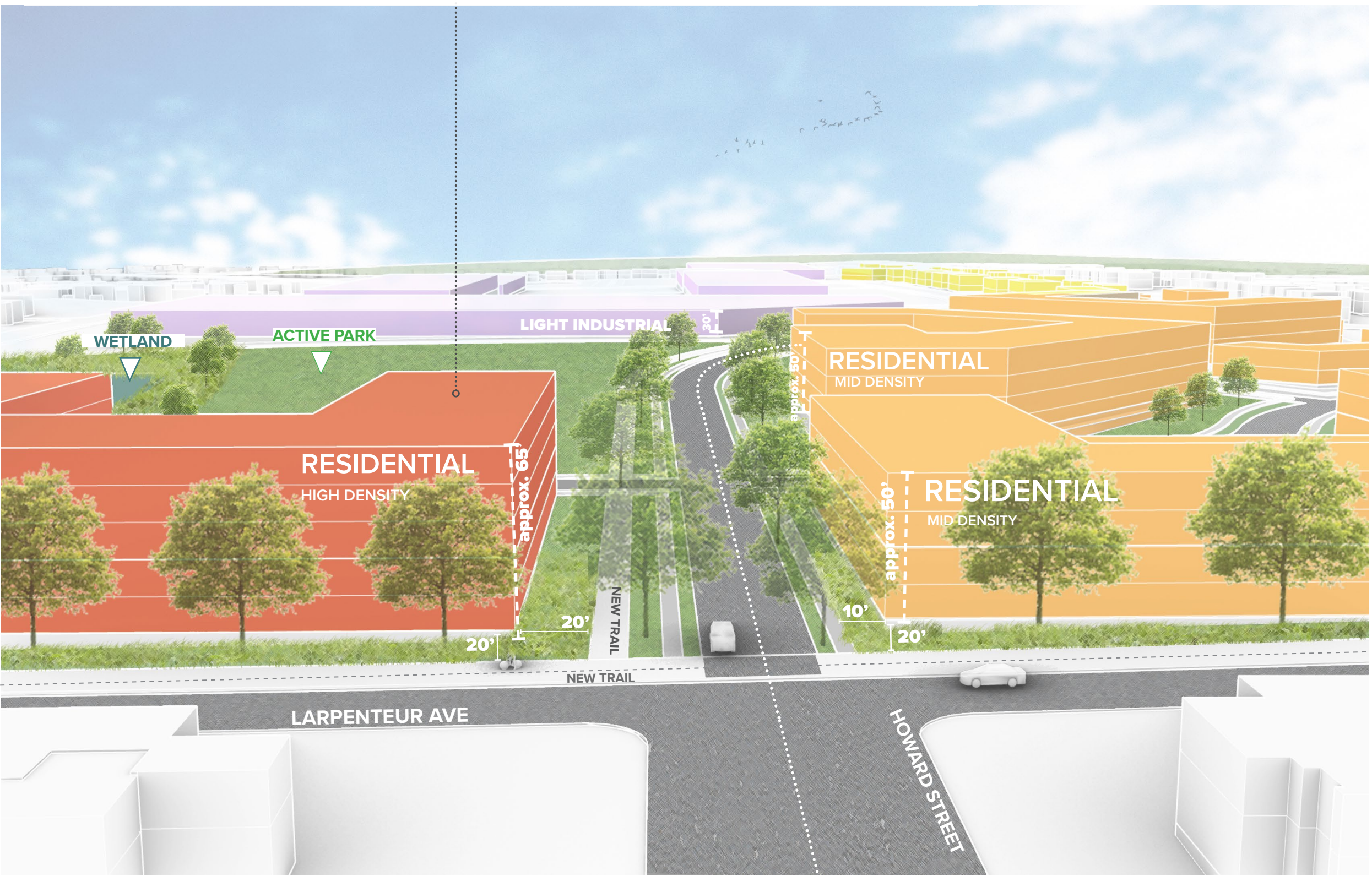

what could high density residential look like?

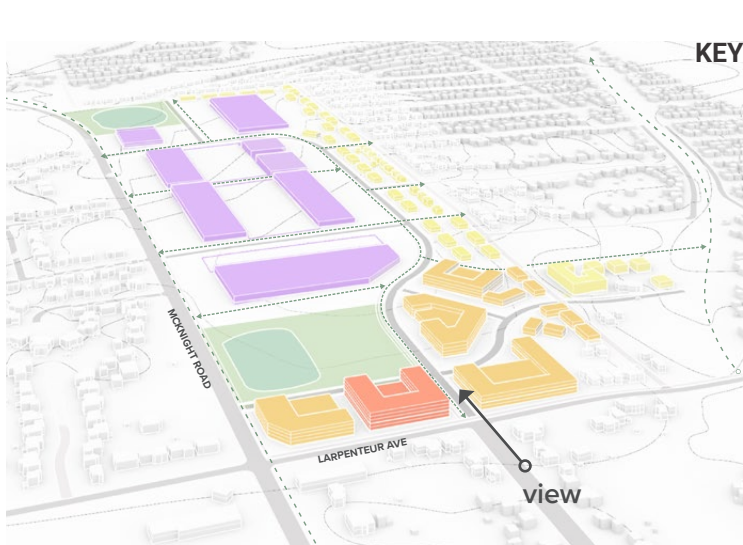

JOB FOCUS

VIEW FROM MCKNIGHT STREET LOOKING NORTH/NORTHWEST



what could this industrial look like?

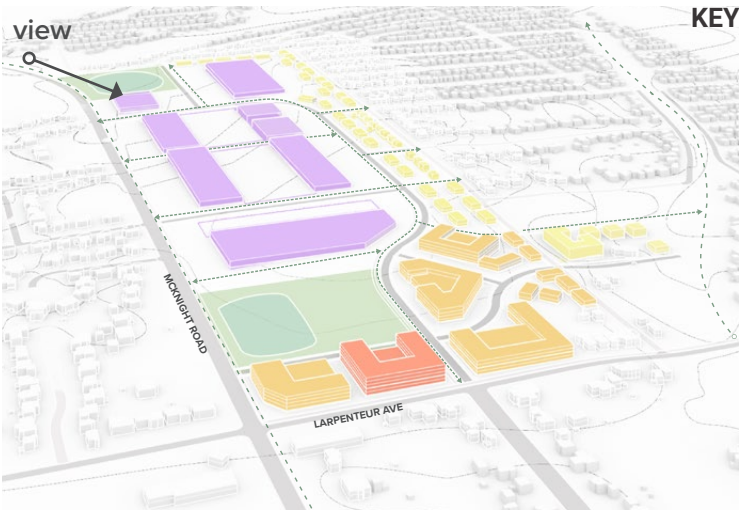

JOB FOCUS

VIEW FROM WINTHROP STREET LOOKING SOUTH/SOUTHEAST

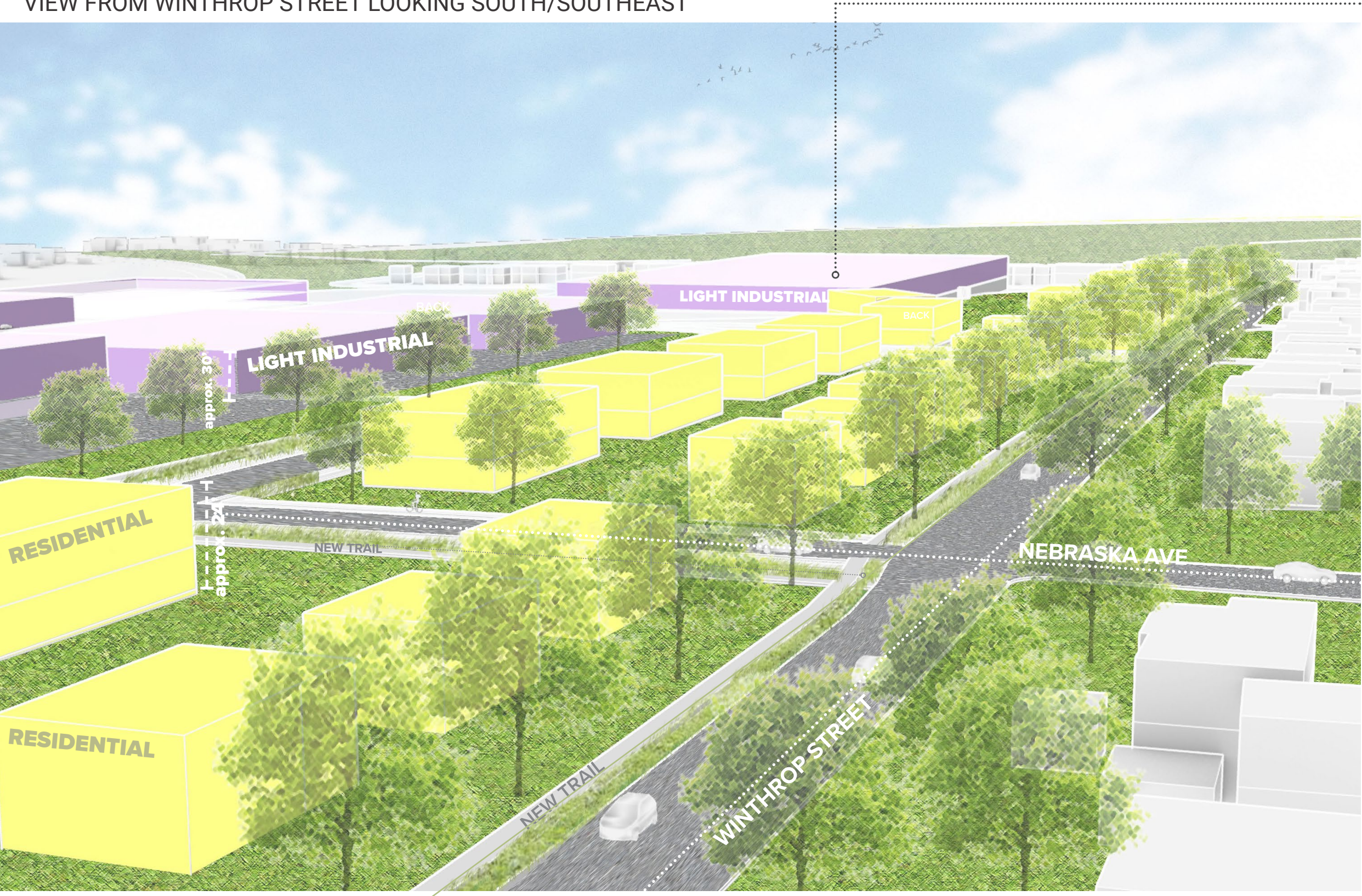

what could this low density residential look like?

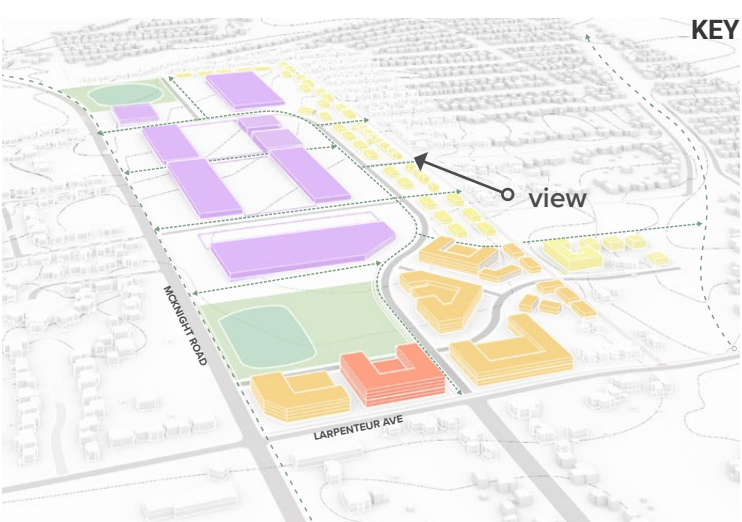

JOB FOCUS

VIEW FROM FURNESS TRAIL LOOKING EAST



what could this residential look like?

