



Hamline Play Area Community Input Options

Saint Paul Department of Parks & Recreation,
Design & Construction Division

2021 Hamline Park Renovations

Liz Hixson – October 2020

Agenda

- Status and summary of previous meetings
- Community survey summary – Alec from Hamline Midway
- Hamline Park Site Plan (concept) – and areas for construction
- Playground Options
 - Climbers
 - Swings
 - Panels
 - Colors
- Next Steps
- Questions

Status & Summary of Previous Meetings

Design & Construction

- Grant from GameTime – success! City will can utilize a discount on play equipment
- Construction will address paths and ADA access in the park
- Reserving funds for re-touching metal (fence, bench arms, bike racks), and updating the park sign
- Will incorporate the US Soccer Foundation grant to create a gathering area

Engagement

- Online survey – plan is to show images of playground options and allow people to indicate preferences
 - To promote the survey and engage directly, City staff will spend a few hours on-site with large plans and photos of proposed equipment, to share with neighbors
- Virtual open house with online presentation and section for comments,
- Will work with Hamline Midway Coalition and Friends of Hamline Park to plan and promote these outreach efforts

Community Survey Summary

Q2

The kids I bring to Hamline Park are the following ages:

Answered: 145 Skipped: 12

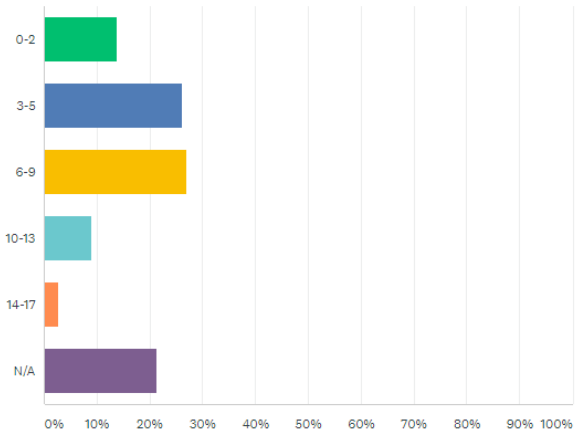

ANSWER CHOICES	RESPONSES	
0-2	13.79%	20
3-5	26.21%	38
6-9	26.90%	39
10-13	8.97%	13
14-17	2.76%	4
N/A	21.38%	31
TOTAL		145

[Comments \(38\)](#)

Q4

How far do you live from Hamline Park?

Answered: 140 Skipped: 17

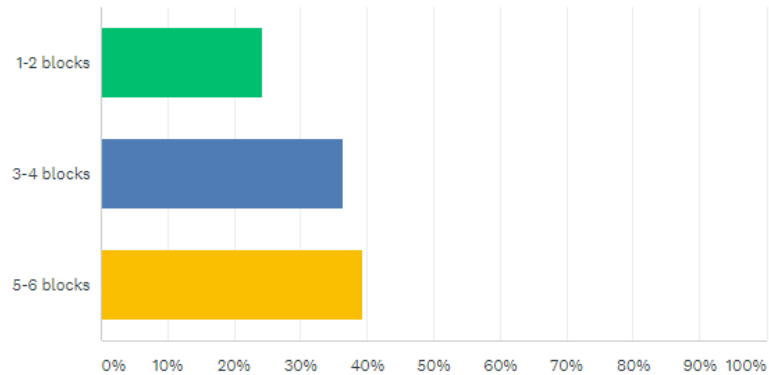

ANSWER CHOICES	RESPONSES	
1-2 blocks	24.29%	34
3-4 blocks	36.43%	51
5-6 blocks	39.29%	55
TOTAL		140

[Comments \(16\)](#)

Q6

How often do you visit Hamline Park?

Answered: 127 Skipped: 30

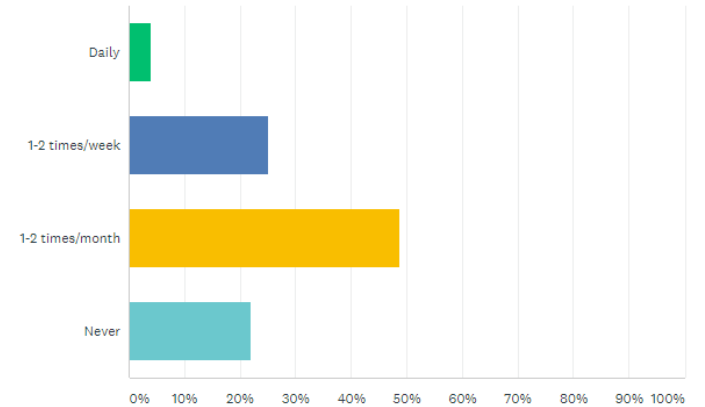

ANSWER CHOICES	RESPONSES	
Daily	3.94%	5
1-2 times/week	25.20%	32
1-2 times/month	48.82%	62
Never	22.05%	28
TOTAL		127

[Comments \(34\)](#)

A few times a year for events

Hamline Park Site Plan



SNELLING AVE

LAFOND AVE

ASBURY ST

THOMAS AVE

CS
TOP=921.9
INV=917.7
15' RCP
37.5'

CS
TOP=922.0
INV=918.0
15' RCP
37.5'

CS
TOP=921.4
INV=917.7
12' RCP
37.5'

BM2
TIN=925.30

Hamline Park Site Plan (concept)

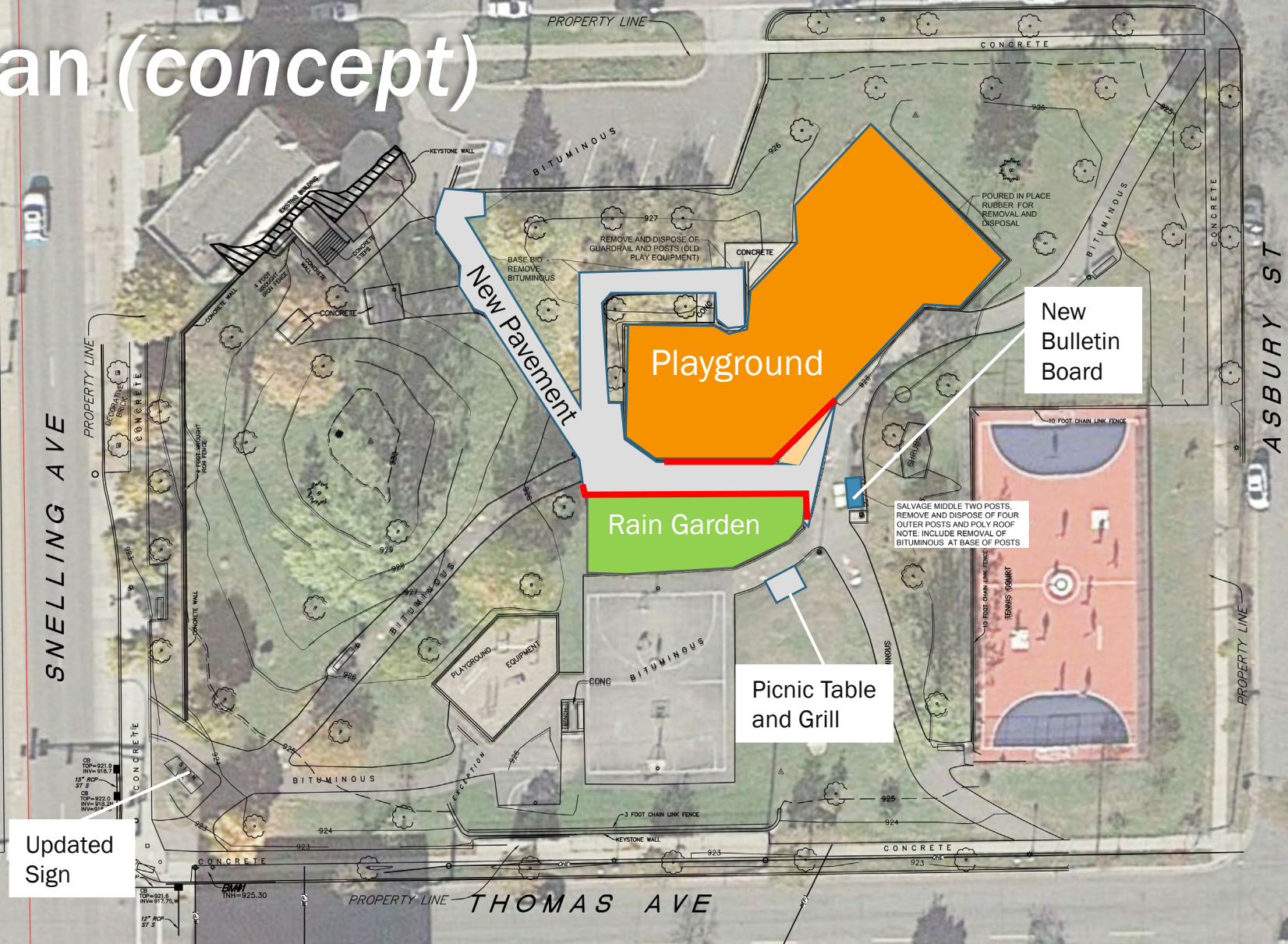

Playground Concept Plan

Climber Options – 2 to 5 years Structure

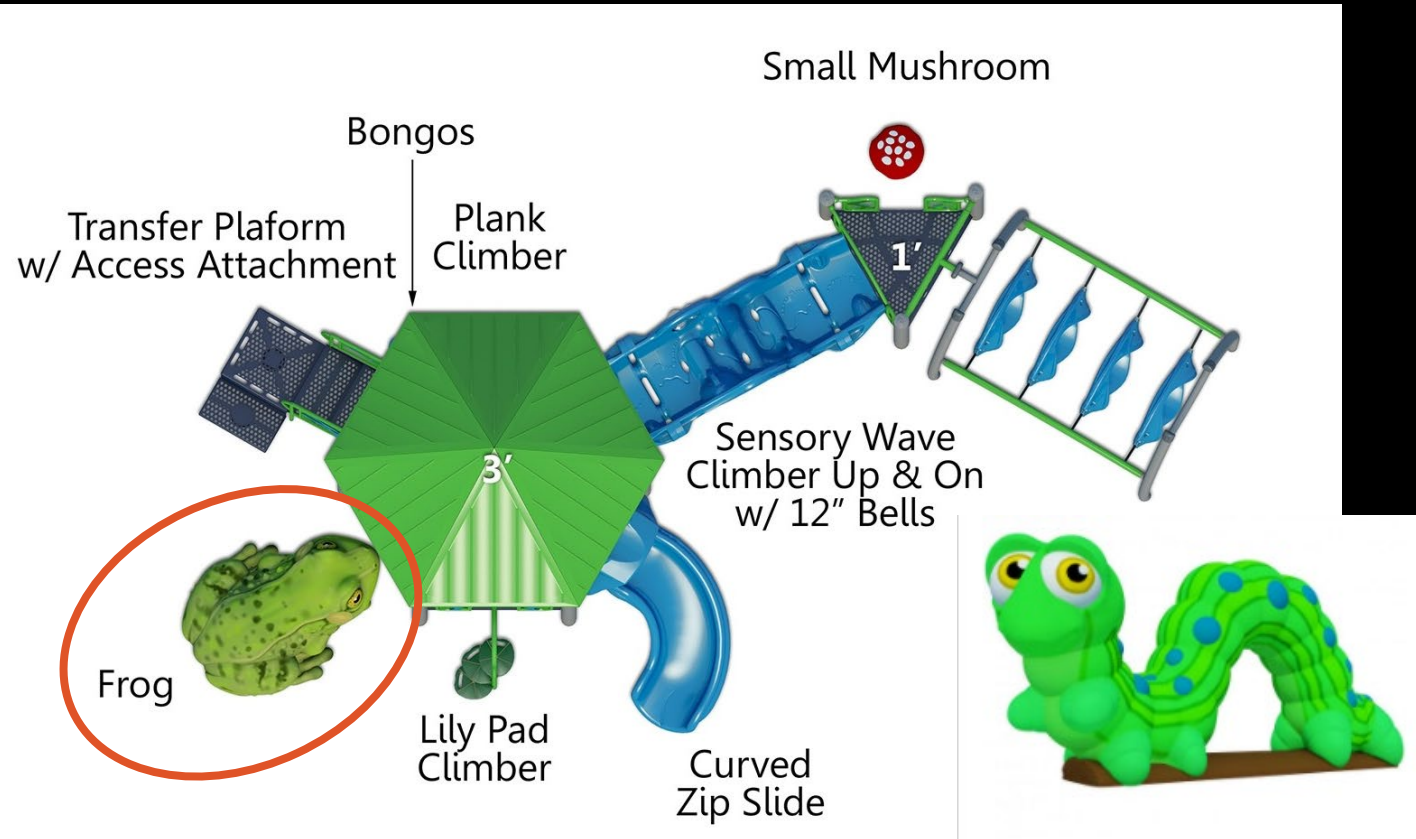

Bee on Flower



New

Ladybug



Ant on Leaf



New

Butterfly



New

Inchworm

Play Structure – 5 to 12 years



Note : These are not the final colors – we will pick

Climbers included for 5 to 12 yr Structure

Climbers, counter-clockwise from left:

- Spiral step climber
- Twister climber
- Clover leaf climber
- Erratic climber with hex net
- Twisted rail climber
- Tree climber
- Double climber
- Wavy tree climber
- Olympus climber

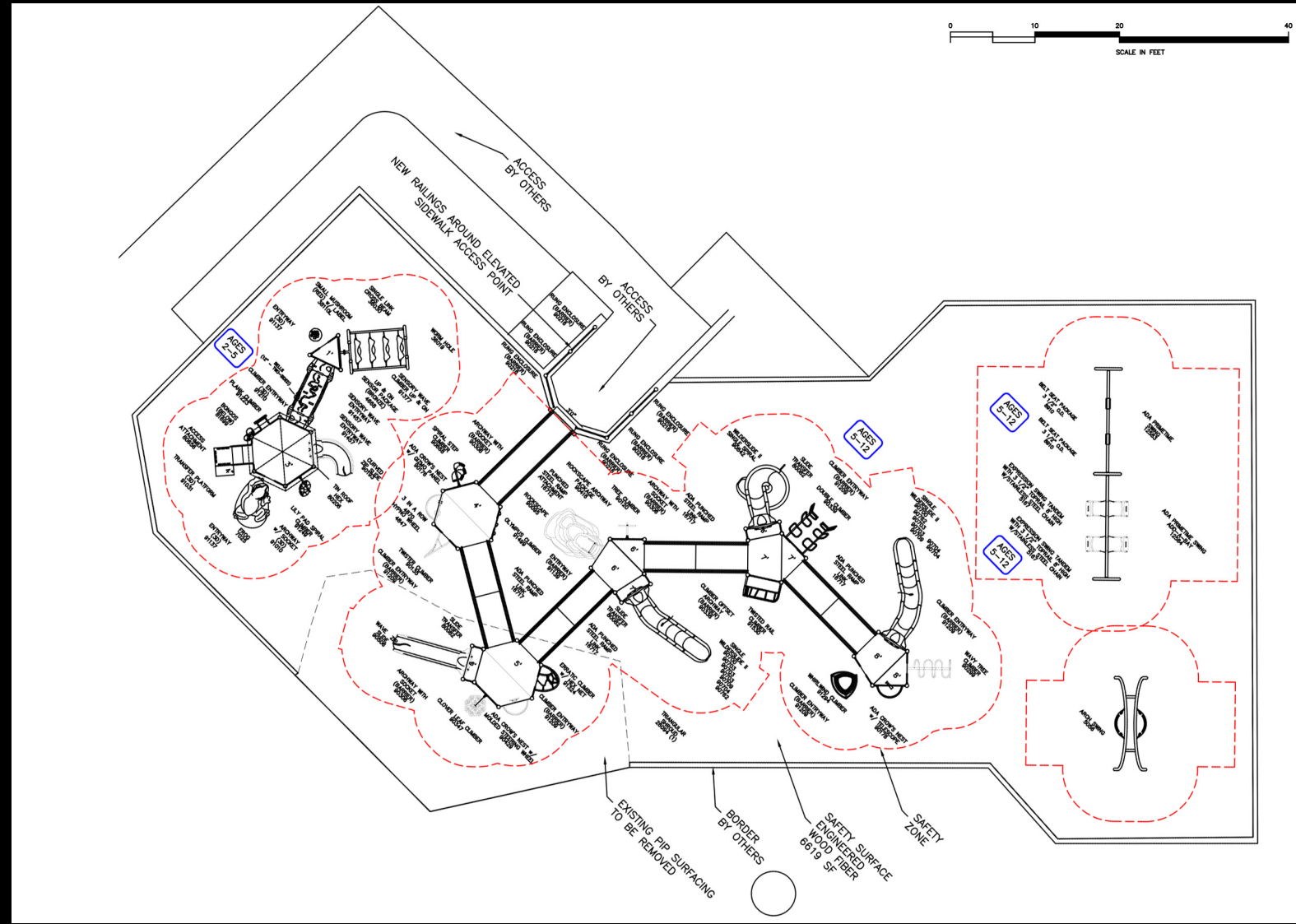

Climbers included for 5 to 12 yr Structure

Climbers, counter-clockwise from left:

- Spiral step climber
- Twister climber
- Clover leaf climber
- Erratic climber with hex net
- Twisted rail climber
- Tree climber
- Double climber
- Wavy tree climber
- Olympus climber

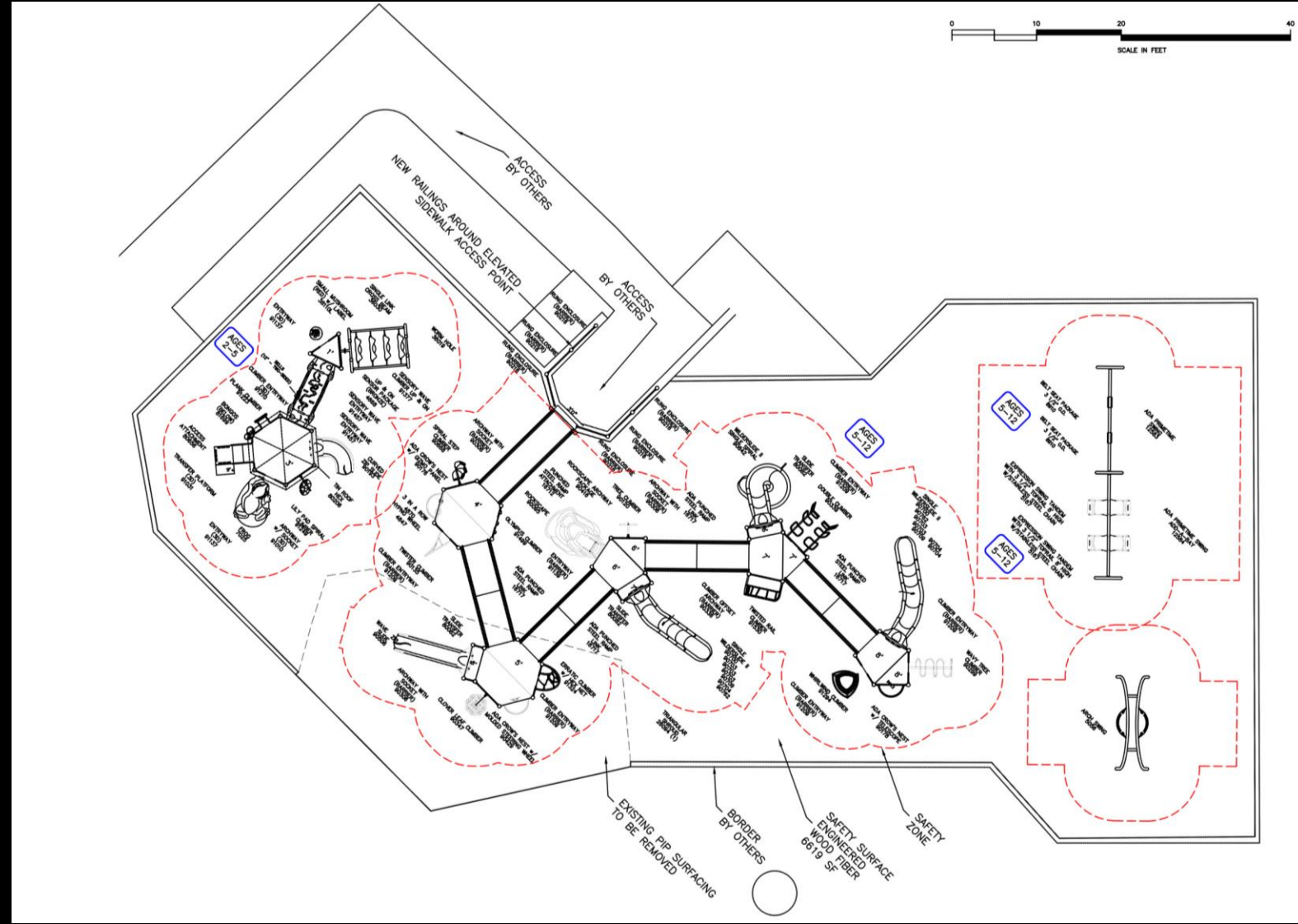

Climbers included for 5 to 12 yr Structure



Specs

Spiral Step Climber



Specs

Twister Climber



Specs

Clover Leaf Climber



Specs

Erratic Link with Hex Net - 5' 6" Thru 6' 6"

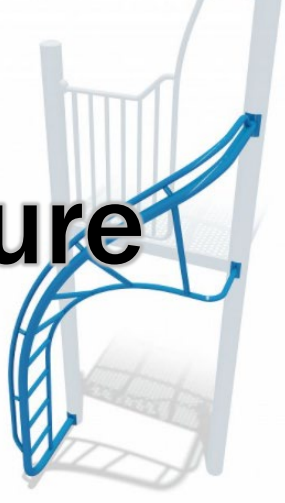

New

Twisted Rail Climber - PowerScope
\$1,980



Specs

Wavy Tree Climber



Specs

Double Climber



Specs

Tree Climber



New

Olympus Climber - Freestanding



Climbers options for 5 to 12 yr Structure



Specs

Leaf Scramble Up Climber



Specs

DNA Climber



Specs

Coral Climber 3D



Specs

Corkscrew Climber



Specs

Vert Wall Climber - 8' Deck Height



Specs

Loop Ladder Climber



Specs

Bubble Climber



Specs

Double Bubble Climber



Specs

Crazy Eight Climber



Specs

Spiral Climber

Free-standing Climbers – 5 to 12 yr Structure



Rockscape (6 ft)



Whirlwind Climber (7'-6")

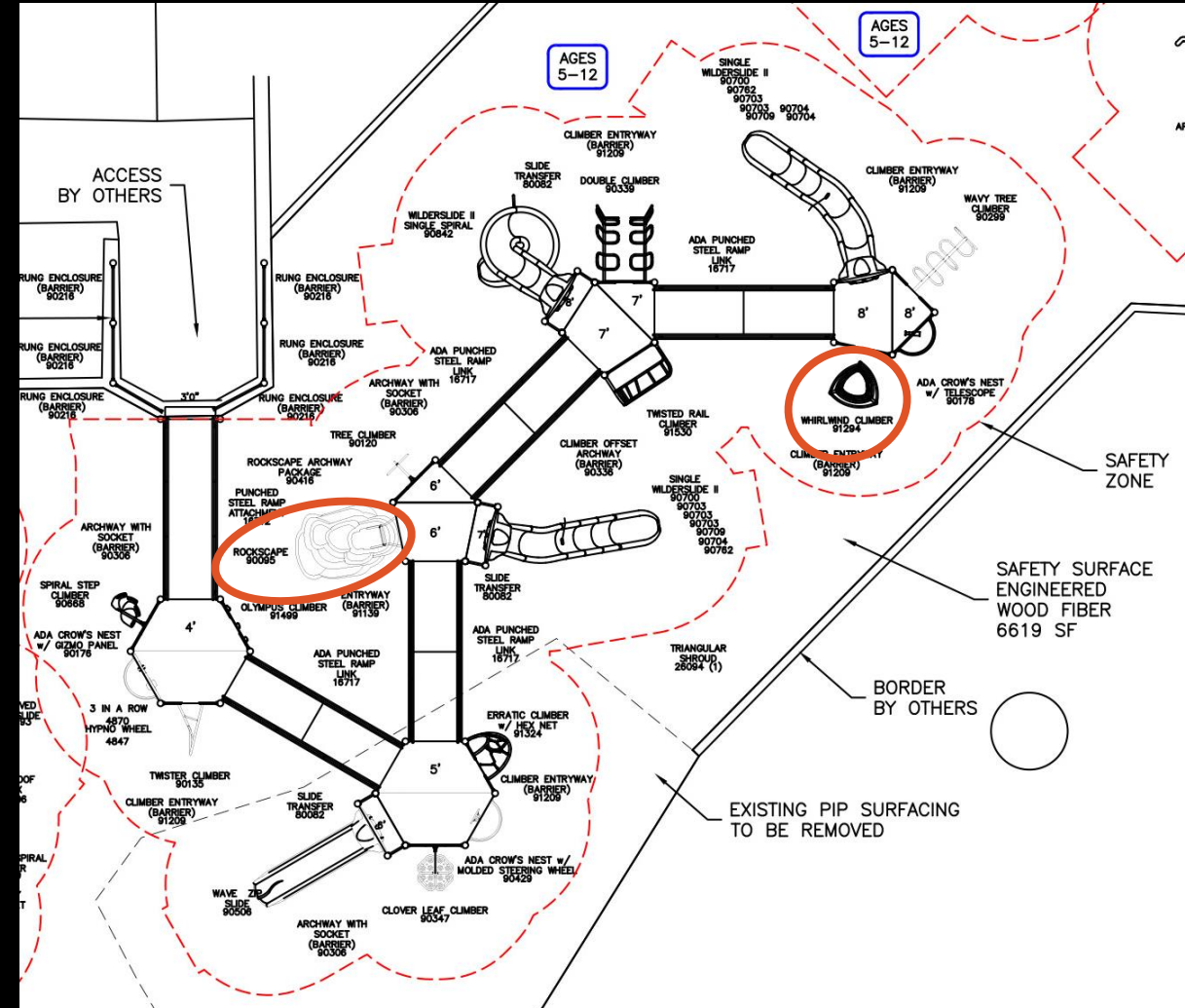

Free-standing Climbers – 5 to 12 yr Structure



Notched log climber

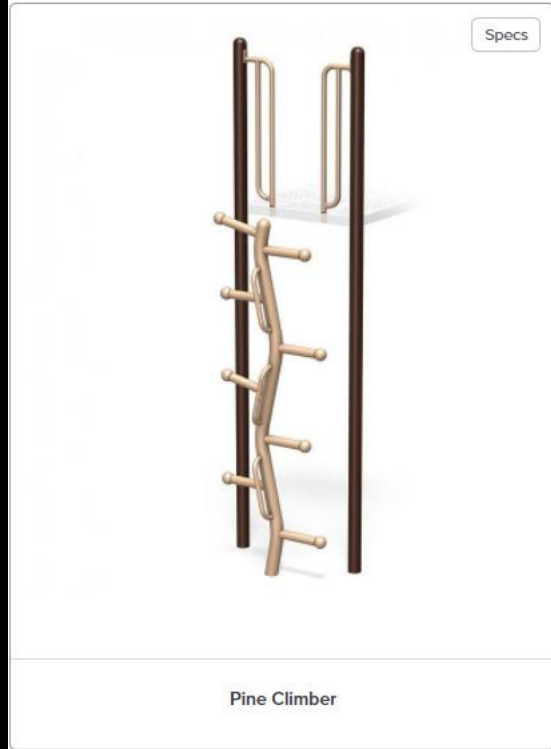

Pine climber

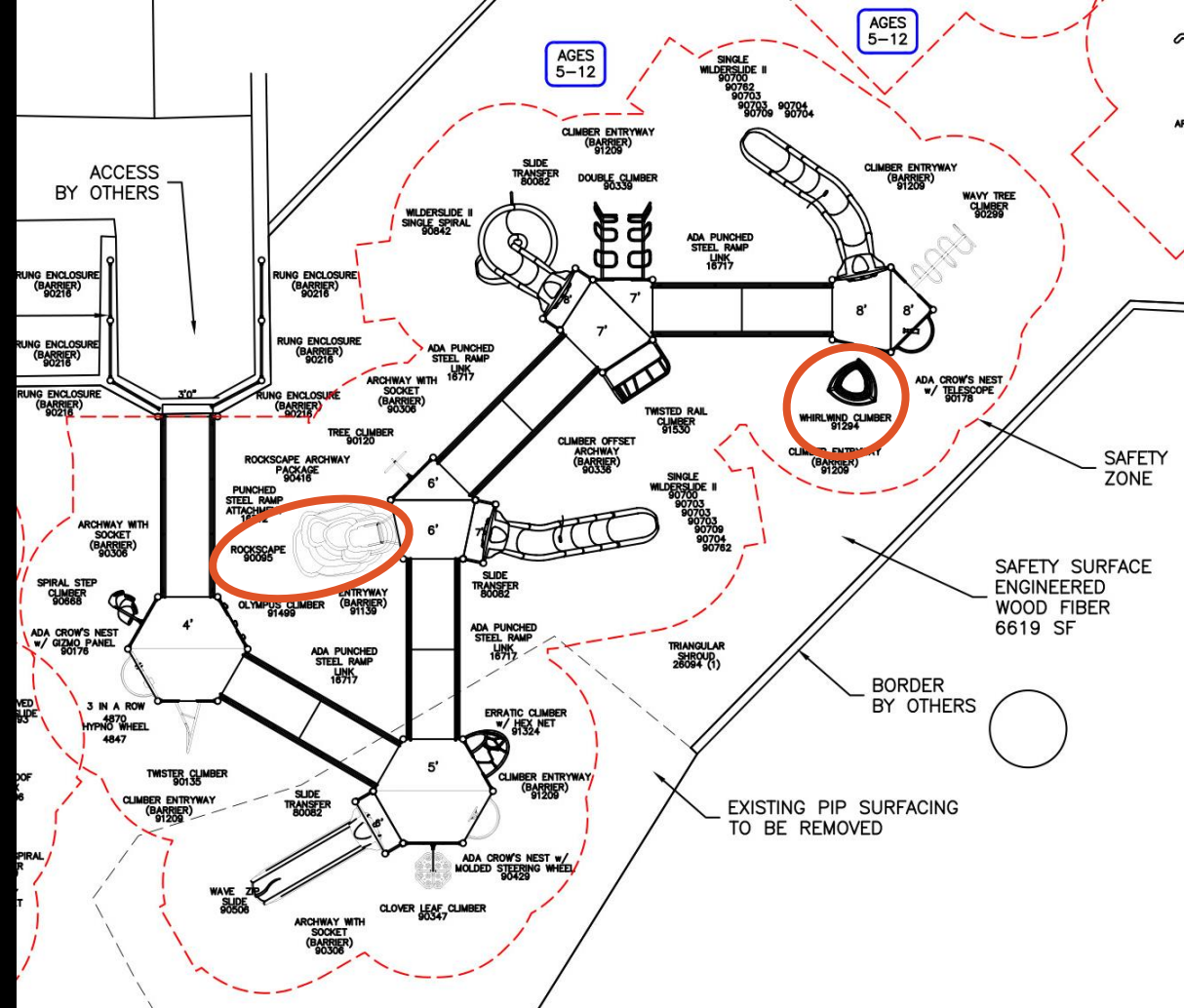

Free-standing Climbers – 5 to 12 yr Structure



Big stump climber



Large conifer climber

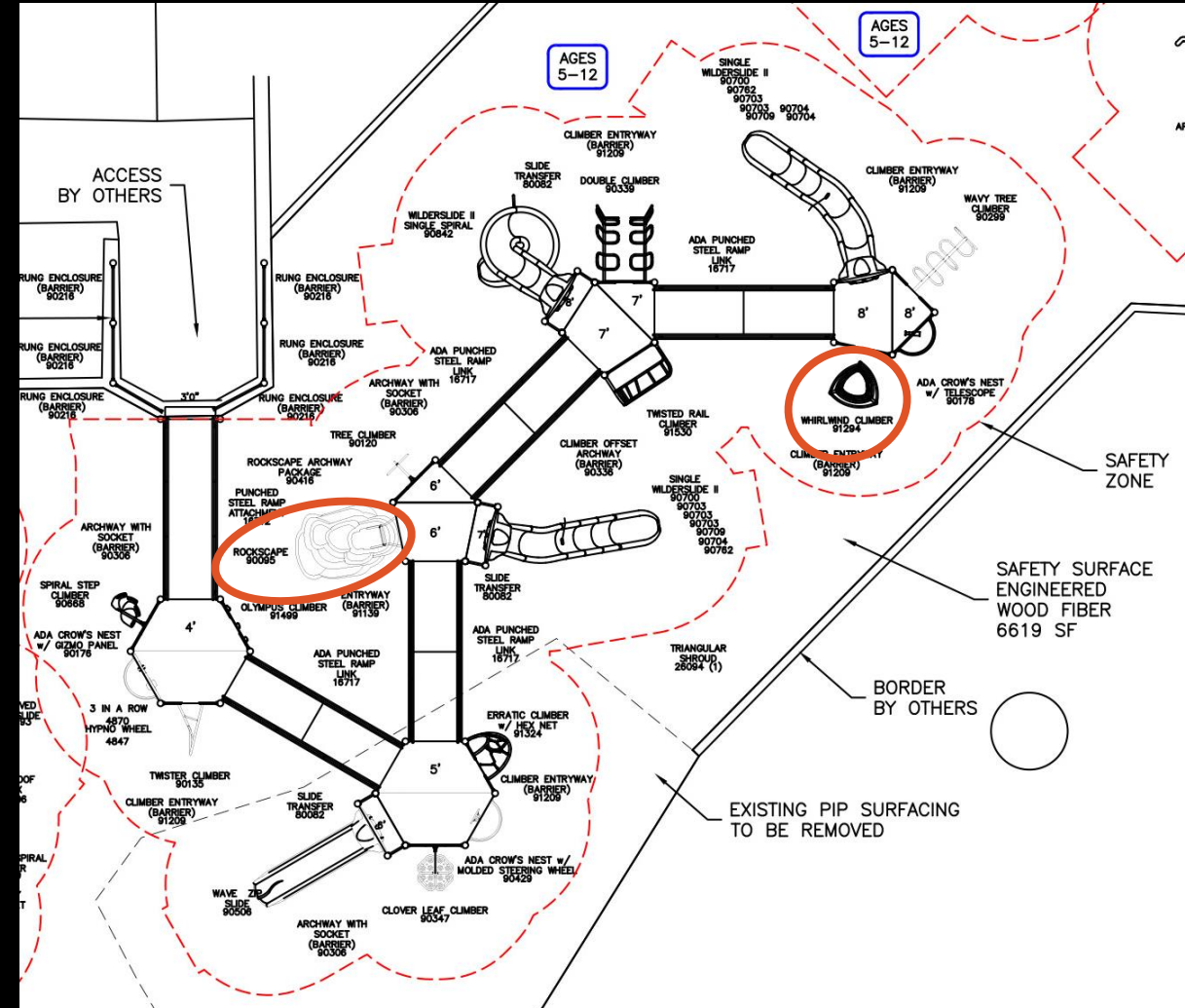

Swings from GameTime



Panels for 5 to 12 years

Panels:

- Gizmo Panel w/click wheel, answer wheel, maze wheel, echo chamber, flat mirror
- 3-in-a-row & Hypno Panel
- Choo Choo panel
- Tic Tac Toe panel
- Store front panel
- May have options to add more

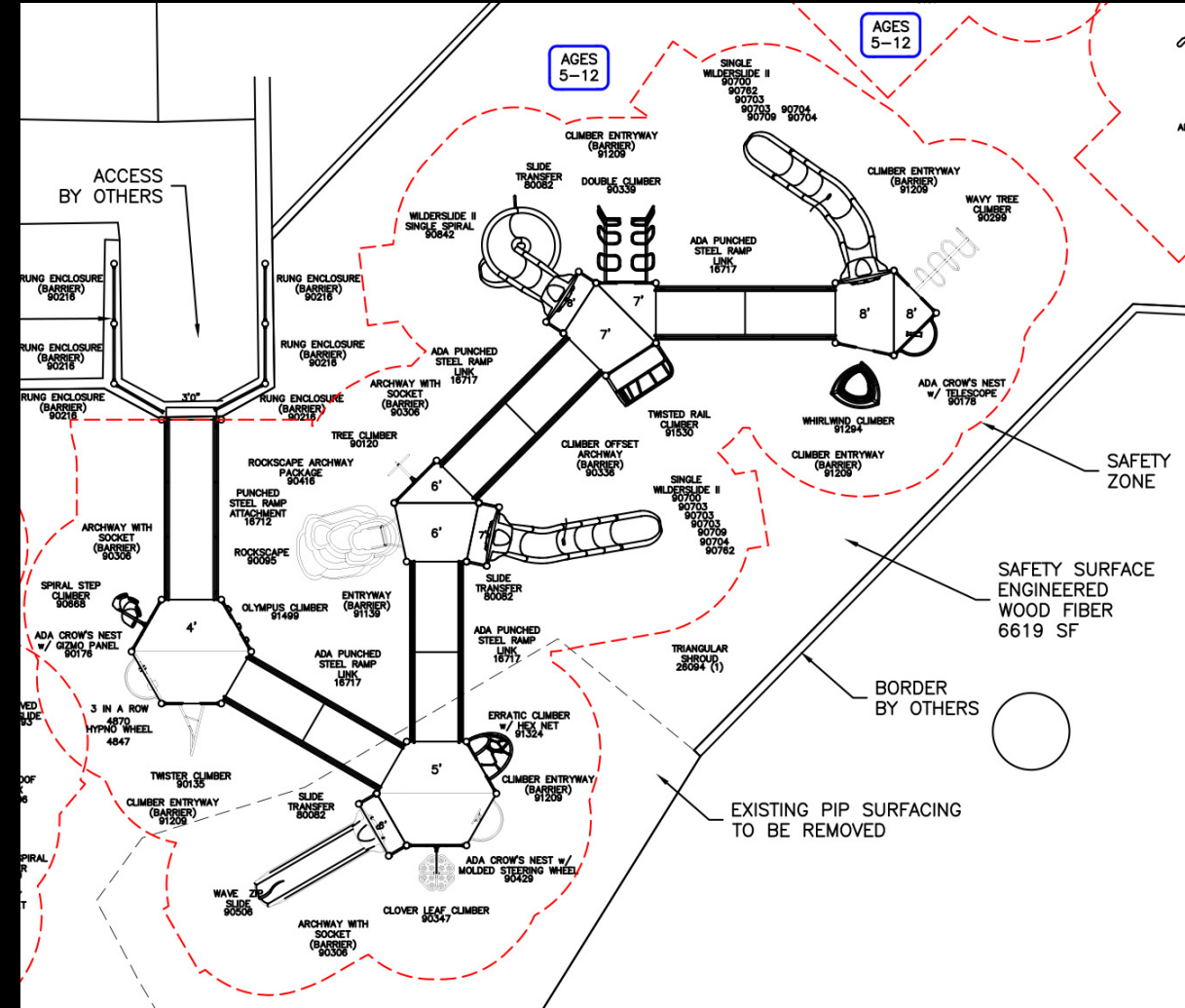

Panel Options - Examples

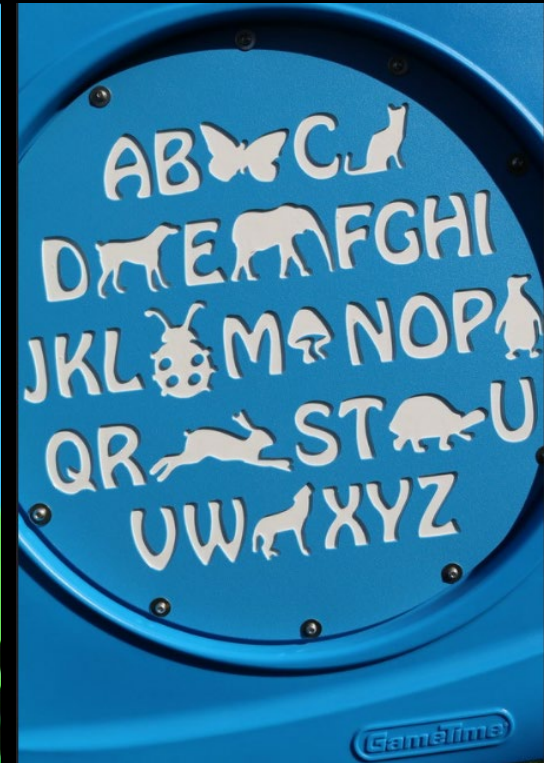

Playground color palettes

<https://www.gametime.com/color-wizard>

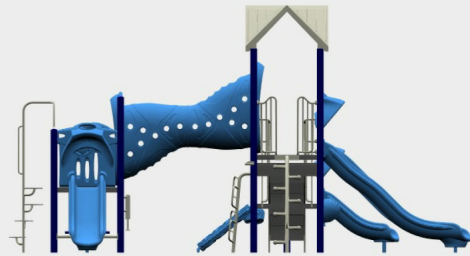

COMPONENT COLORS

Component	Color
Deck	Deck Gray
Deck Punched Steel	Punched Steel Gray
HDPE Panel	HDPE Blue
Metal	Metal Gray-Champagne
Metal Roof	Metal Gray-Champagne
Roto Plastic	Plastic Sky Blue
Tube	Plastic Sky Blue
Uprights	Metal Blue



COMPONENT COLORS

Component	Color
Deck	Deck Gray
Deck Punched Steel	Punched Steel Gray
Fabric 1	Shade Silver
HDPE	HDPE Yellow
HDPE Panel	HDPE Blue
Metal	Metal Gray-Champagne
Metal Roof	Metal Gray-Champagne
Roto Plastic	Plastic Red

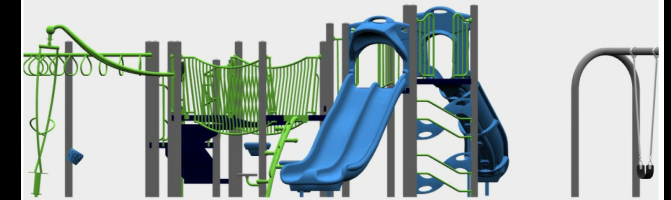

PALETTE : Atlantic



COMPONENT COLORS

Component	Color
Climber Nets	Metal Blue
Deck	Deck Blue
Deck Punched Steel	Punched Steel Blue
HDPE	HDPE Sky Blue
Metal	Metal Spring Green
Roto Plastic	Plastic Sky Blue
Uprights	Metal Metallic

Local Examples for color – Jimmy Lee/Oxford



Local Examples for color – Boyd Park



Photo: Google
Street View

Local Examples GameTime - Eastview



Photo:
Minnesota-
Wisconsin
Playground

Local Examples Game Time – Conway Park



Local Examples Game Time – Coon Rapids



Woodland Oaks Park

Photo: Minnesota-
Wisconsin Playground

Osceola Medical Center



Osceola Medical Center

Photo: Minnesota-Wisconsin Playground

Next Steps

- Month of November - Survey Monkey for community voting on preferred equipment parts. Can extend into December.
- If safe to do so, on-site early November with boards
- December or January - online open house to present final concepts (rendered playground images) and site plan

Questions

- What is missing?
- Other areas within the park that you want the City to consider?
- Other questions, needs, or concerns?

