

# CITY OF SAINT PAUL

## HERITAGE PRESERVATION COMMISSION STAFF REPORT

**FILE NAME:** 2260 Summit Avenue (University of ST. Thomas)

**APPLICANT:** Greg Fenton, BWBR

**DATE OF PER APPLICATION:** June 14, 2021

**HPC DISTRICT:** Summit Avenue West Preservation District

**PERIOD OF SIGNIFICANCE:** 1885-1938

**CATEGORY:** Vacant Lot

**WARD:** 4

**DISTRICT COUNCIL:** 14

**CLASSIFICATION:** New Construction-Preapplication

**STAFF:** George Gause

**\*This is a pre-application discussion. The HPC will take no action on this item.\***

### A. SITE DESCRIPTION:

The site is currently vacant.

### B. BACKGROUND

The University of St. Thomas proposes to construct a new science and arts educational facility on the Saint Paul campus. Location is on the 'south campus' south of Summit Avenue and west of Cretin Avenue. Building size is approximately 130,000 GSF. Construction is desired to begin in Spring 2022 pending a successful fundraising campaign. The structure has been designed so that variances will not be required. Exterior building materials will be consistent with materials in place at the adjacent St. Thomas O'Shaughnessy and Owens Science Halls.

### C. PRESERVATION PROGRAM CITATIONS:

***Summit Avenue West Heritage Preservation District Legislative Code Sec. 74-35-39.***

PRESERVATION PROGRAM CITATIONS	COMMENTS:
<b><i>§74.37 New Construction Guidelines</i></b>	
<i>(a) General Principles: These guidelines for new construction focus on general rather than specific design elements in order to encourage architectural innovation and quality design while maintaining the harmony and continuity.</i>	The design is distinguishable as new, modern design, while addressing the established continuity. The structure will relate to other university structures
<i>(b) Massing and Scale: New construction should conform to the massing, volume, height, facade proportions and scale of existing surrounding</i>	The structure is compatible with other surrounding structures.
<i>(c) Materials and Details: (3) The materials and details of new college buildings should relate to the materials and details of nearby contributing college buildings. The College of St. Thomas presents cream-colored Kasota stone buildings to the Summit Avenue streetscape.</i>	Materials will correspond to buildings on the campus.
<i>(d) Building Elements: (1) Roofs. The skyline or profile of new construction should relate to the predominant roof shape of existing nearby buildings.</i>	Roofline will correspond to buildings on the campus.
<i>(d) Building Elements: (2) Windows and doors. The proportion, size, rhythm and detailing of windows and doors should be compatible with that of existing nearby buildings.</i>	Windows will be will correspond to buildings on the campus.

- End -

# University of St. Thomas STEAM - HPC Informal Review







SUMMIT AVENUE





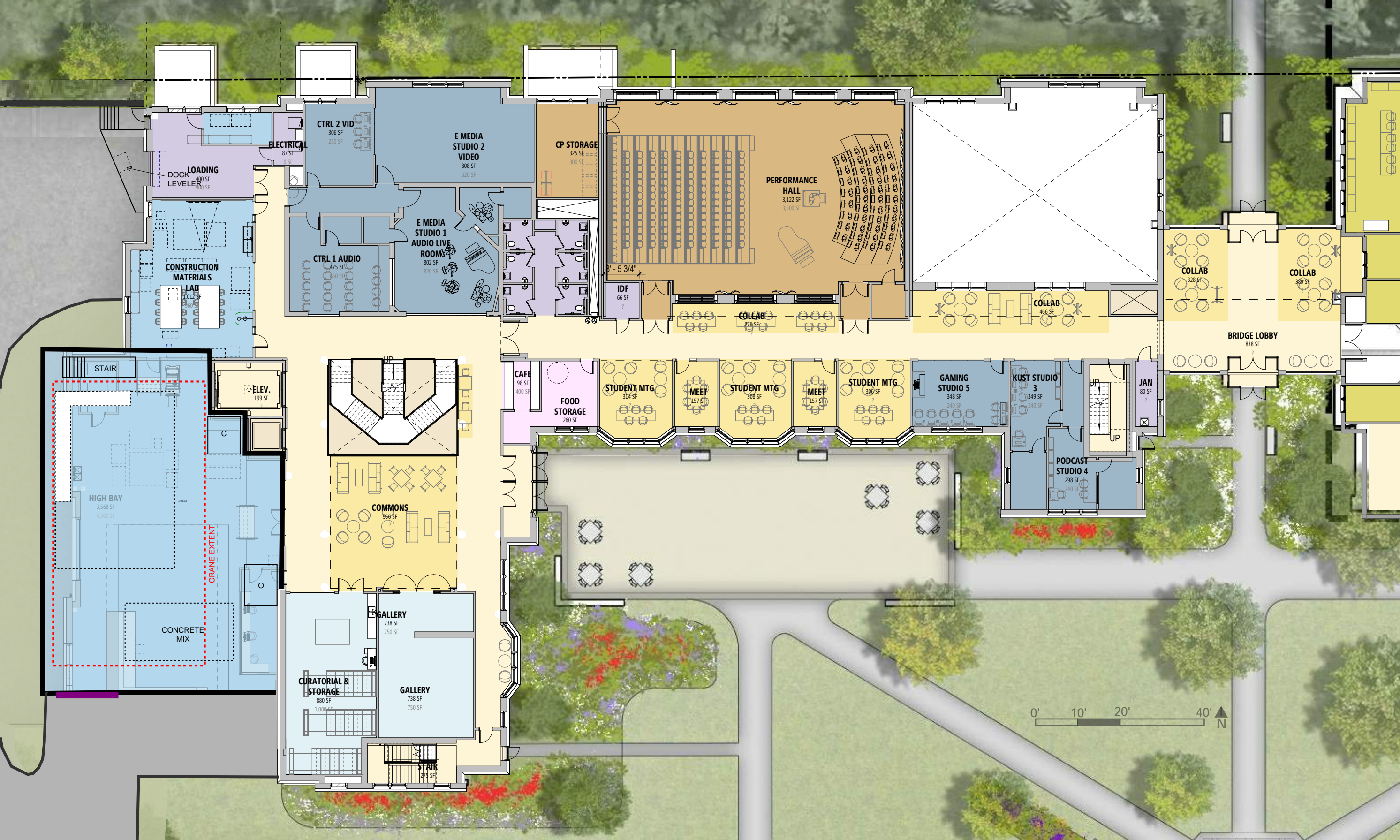





EXTERIOR MATERIALS:  
Kasota Stone veneer  
Aluminum window systems  
Cast stone detailing  
Glazing  
Slate tile roofing

