

TWIN LANTERN STYLE STANDARD DETAIL TYPE 2L14

ST PAUL PATINA
GREEN COLOR

BLACK COLOR

22.5"
TWIN CAPITAL
ON 4"X14"
TENON

ST PAUL
BROWN COLOR

HOLOPHANE ARLINGTON POSTTOP
OR EQUIVALENT
IN 100W/150W EQ. OUTPUT

SECTION A-A

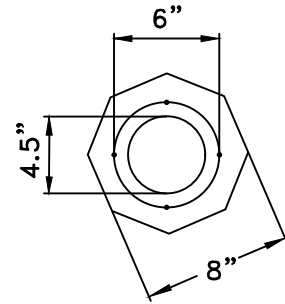

SECTION B-B

SLOTS FOR 1" BOLTS
ON 15" BOLT CIRCLE

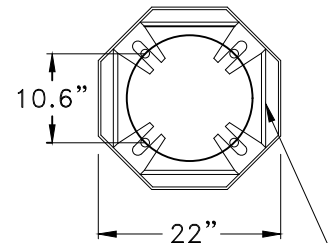

OCTAL BASE
ANCHOR RING

145.5"

17'

NO SCALE

NOTE: TWIN ARM
SHALL BE ORIENTED
PARALLEL TO THE ROADWAY.

6.5"

22.5"

CITY OF
SAINT PAUL
20XX

FOR FOUNDATION DETAIL
SEE ST PAUL STANDARD
SHEET 5008

5'

ø2'



I hereby certify that this plan, specification or report was prepared by me or under my direct supervision and that I am a duly Licensed Professional Engineer under the laws of the State of Minnesota.

BENJAMIN J. HAWKINS

Date: _____ Lic. No. 49104

APPROVED

CITY ENGINEER

CITY OF ST PAUL DEPARTMENT OF PUBLIC WORKS
TWIN LANTERN STYLE
STANDARD DETAIL
TYPE 2L14

DATE OF REVISION:
AUGUST 2021

STANDARD PLATE NO. 5059