

TWIN LANTERN STYLE STANDARD DETAIL TYPE 2L14

ST PAUL PATINA GREEN COLOR

BLACK COLOR

HOLOPHANE ARLINGTON POSTTOP OR EQUIVALENT IN 100W/150W EQ. OUTPUT

22.5"
TWIN CAPITAL
ON 4"X14"
TENON

SECTION A-A

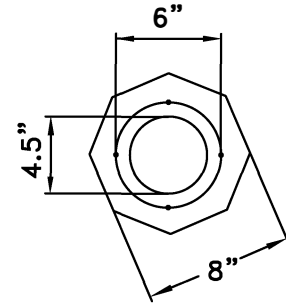

ST PAUL BROWN COLOR

145.5"

17'

SECTION B-B

SLOTS FOR 1" BOLTS
ON 15" BOLT CIRCLE

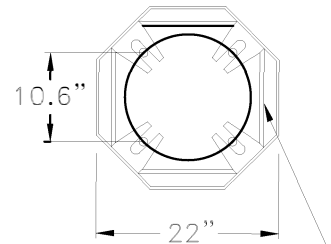

NO SCALE

NOTE: TWIN ARM
SHALL BE ORIENTED
PARALLEL TO THE ROADWAY.

6.5"

22.5" B B

OCTAL BASE
ANCHOR RING

FOR FOUNDATION DETAIL
SEE ST PAUL STANDARD
SHEET 5008

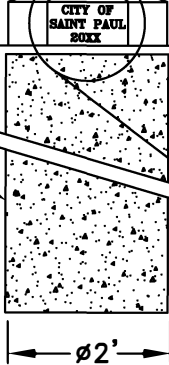

I hereby certify that this plan, specification or report was prepared by me or under my direct supervision and that I am a duly licensed Professional Engineer under the laws of the State of Minnesota.

B. Hawkins
BENJAMIN J. HAWKINS

Date: 12/19/23 Lic. No. 49104

APPROVED

Mark Pater

12/19/23

CITY ENGINEER

CITY OF ST PAUL DEPARTMENT OF PUBLIC WORKS
TWIN LANTERN STYLE
STANDARD DETAIL
TYPE 2L14

DATE OF REVISION:
DECEMBER
2023

STANDARD
PLATE
NO.
5059