

RESIDENTIAL PIPE CONNECTION ABANDONMENT – PARTIALLY LINED TUNNEL, STD PLATE 2701

NOTES:

1. REFER TO STANDARD SPECIFICATIONS FOR CONSTRUCTING AND REPAIRING PRIVATE SEWER CONNECTIONS FOR FURTHER INFORMATION AND DETAILS. IF THERE ARE CONFLICTS BETWEEN THE SPECIFICATION AND STANDARD PLATE, THE STANDARD PLATE GOVERNS.
2. THIS PLATE IS FOR STORM OR SANITARY CONNECTION ABANDONMENTS FOR RESIDENTIAL PROPERTIES (SINGLE FAMILY OR DUPLEX).
3. CONTRACTOR TO SUBMIT A AND B TO CITY TWO WEEKS BEFORE CONSTRUCTION, AND C POST CONSTRUCTION:
  - A. WORK PLAN AND SCHEDULE.
  - B. MATERIAL SHOP DRAWINGS AND SPECIFICATIONS.
  - C. POST-CONSTRUCTION PHOTOS SHOWING ALL PIPE, BULKHEADS, AND CONNECTIONS.

I hereby certify that this plan, specification or report was prepared by me or under my direct supervision and that I am a duly Licensed Professional Engineer under the laws of the State of Minnesota

*Aaron D. Hass*  
AARON D. HASS

Date 05-10-2024 Lic. No. 26424

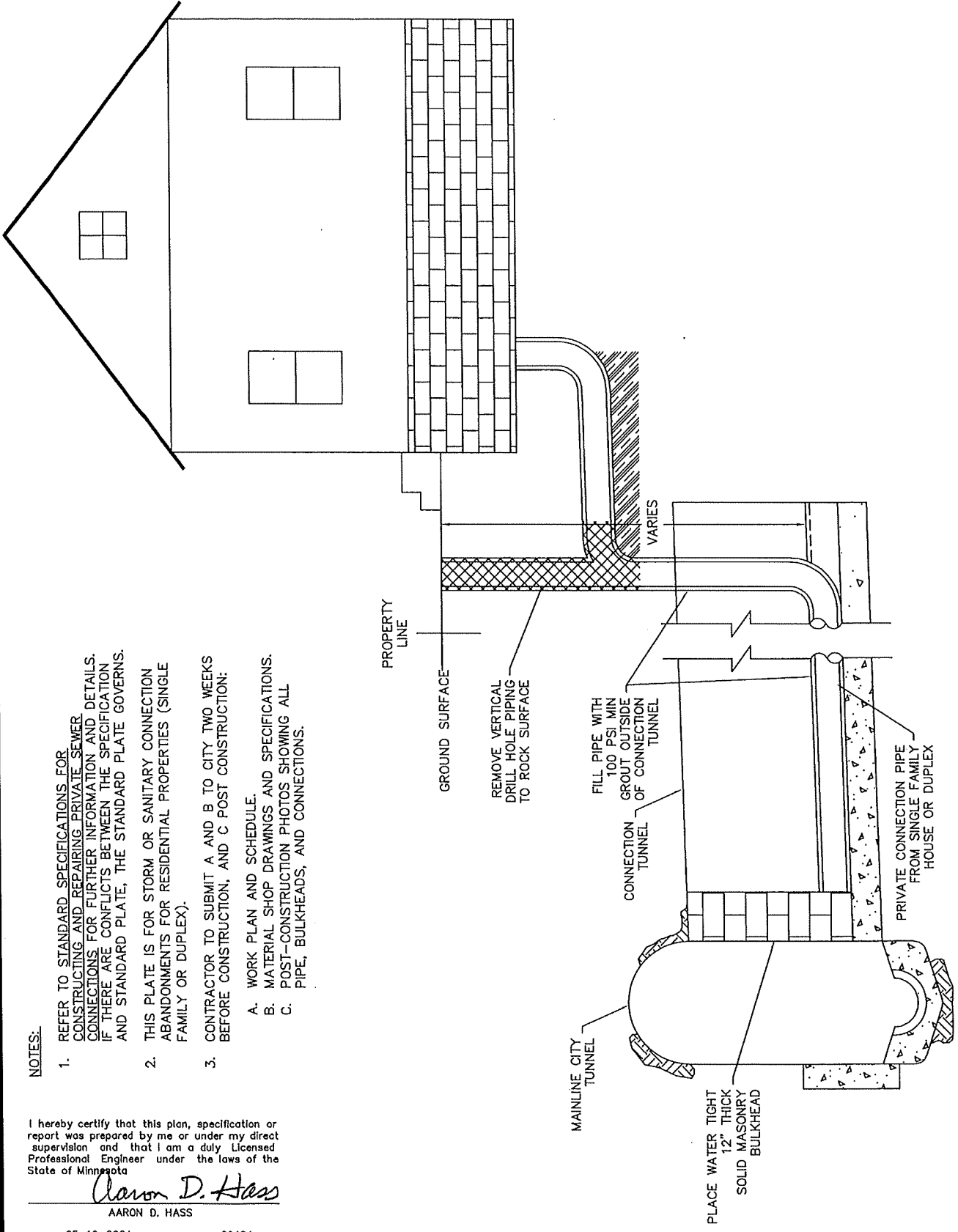

APPROVED  
*Nick [Signature]*  
CITY ENGINEER

CITY OF ST. PAUL  
DEPARTMENT OF PUBLIC WORKS  
RESIDENTIAL PIPE CONNECTION ABANDONMENT  
PARTIALLY LINED TUNNEL

Date of Revision  
MAY 2024

Standard Plate No.  
2701