



SAINT PAUL
SAFETY & INSPECTIONS

375 Jackson Street, Suite 220
Saint Paul, Minnesota 55101-1806
Phone: 651-266-8989 Fax: 651-266-8951
Visit our website at www.stpaulgov/dsi

Zoning Addendum — Site and Floor Plans

Please attach the following documents:

- a. Floor Plan Pertaining to Licensed Area (Please see examples below)
 - I. Drawn to scale
 - II. Showing dimensions RSFG
 - III. Furniture
 - IV. All spaces/rooms labeled for use Including ingress and egress
 - IV. Showing placement of all equipment (e.g., kitchen equipment, worktables, entertainment devices, etc.)
- b. Site Plan Pertaining to Licensed Property (Please see example below)
 - I. Drawn to scale
 - II. Showing dimensions
 - III. Showing all property lines
 - IV. Showing the parking lot
 - v. Label all rooms/spaces

Floor Plan

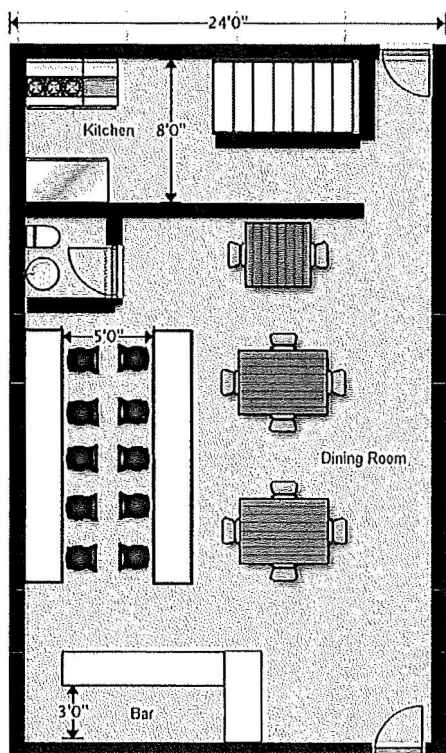

Site Plan

