

Play Equipment



Traditional Swings



Monkey Bars



Play-mounds



Tree Grove

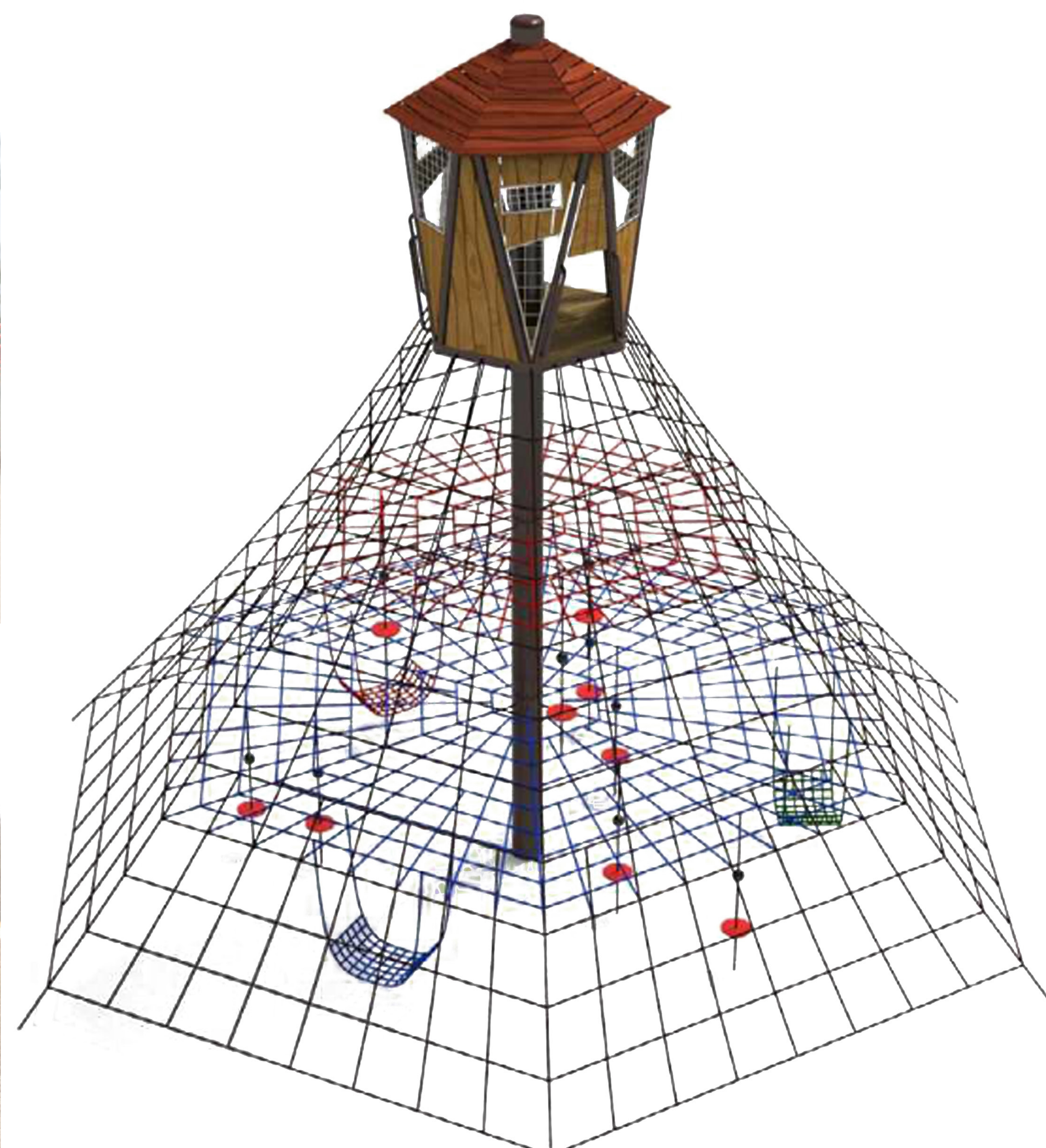

Skytower (w/slide) (5-12 yr old)



Play House (2-5 yr old)



Key Ideas:

- Keep existing play container - utilize for swings & 2-5 play area
- Looped path around play area connecting to other play spaces
- Picnic and seating around play space
- Use existing trees for shade
- Tree grove for seating, informal nature play, and buffer from picnic area
- Signature play element

- Existing Restroom and Drinking Fountain
- Grass
- Picnic Table
- Proposed Trees
- Bike Racks & Fix-it Station
- ADA Picnic Table
- Park Sign
- 5' Concrete Path
- Rubber Surfacing
- Artificial Turf Play-mounds
- Bench
- 2-5 Play House
- Tree Grove
- Sand
- Monkey Bars
- Bench
- Proposed Overstory Trees
- 5-12 Play Element
- Swinging Bench

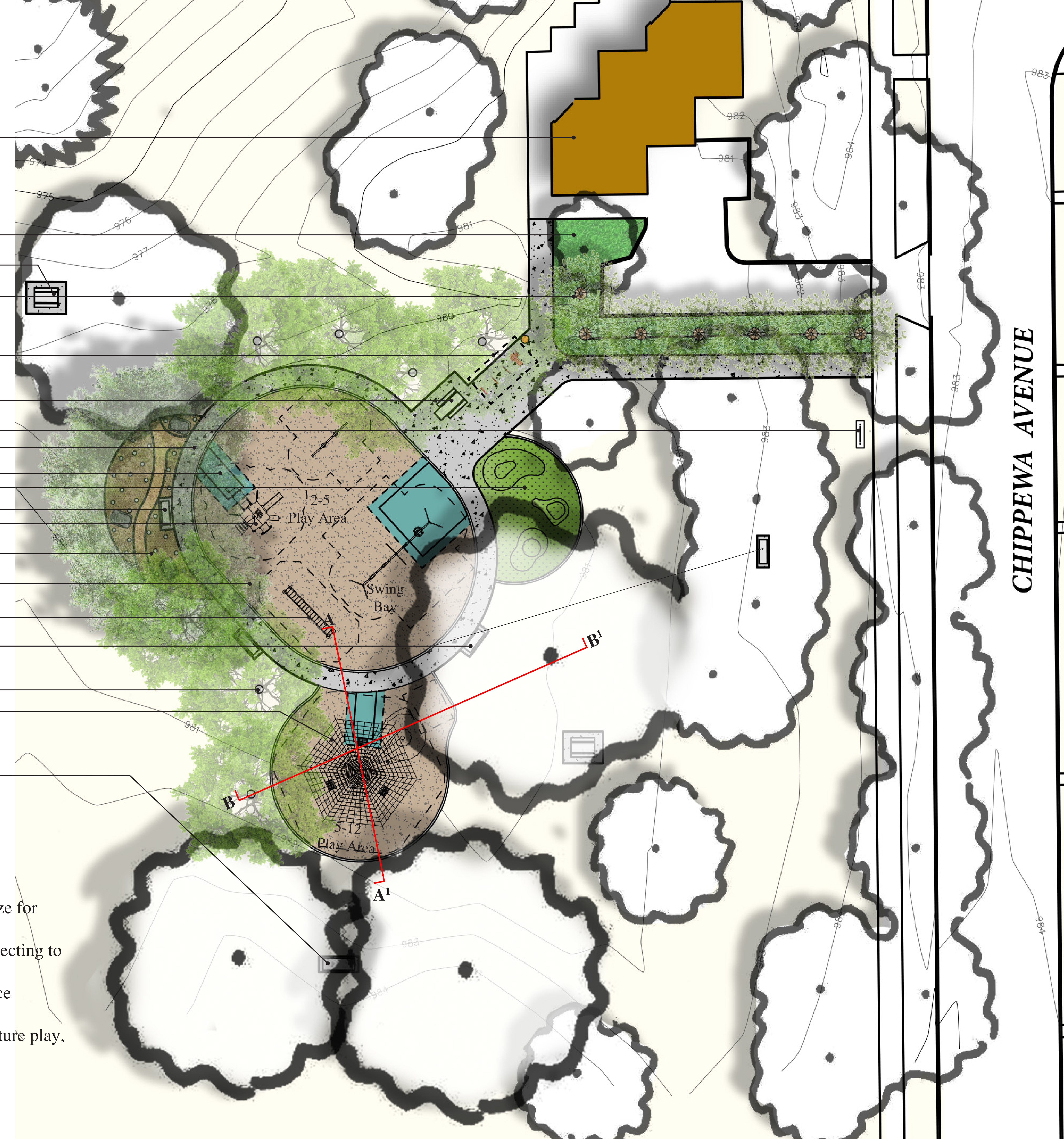

Cherokee Regional Park Play Area Improvements

-Final Concept-

February 16, 2017

Project Manager: Cheeneng Yang | Alice Messer
 Contact: 651-266-6414 | 651-266-6412
 Email: Cheeneng.Yang@ci.stpaul.mn.us | Alice.Messer@ci.stpaul.mn.us



Saint Paul Parks and Recreation

Section A

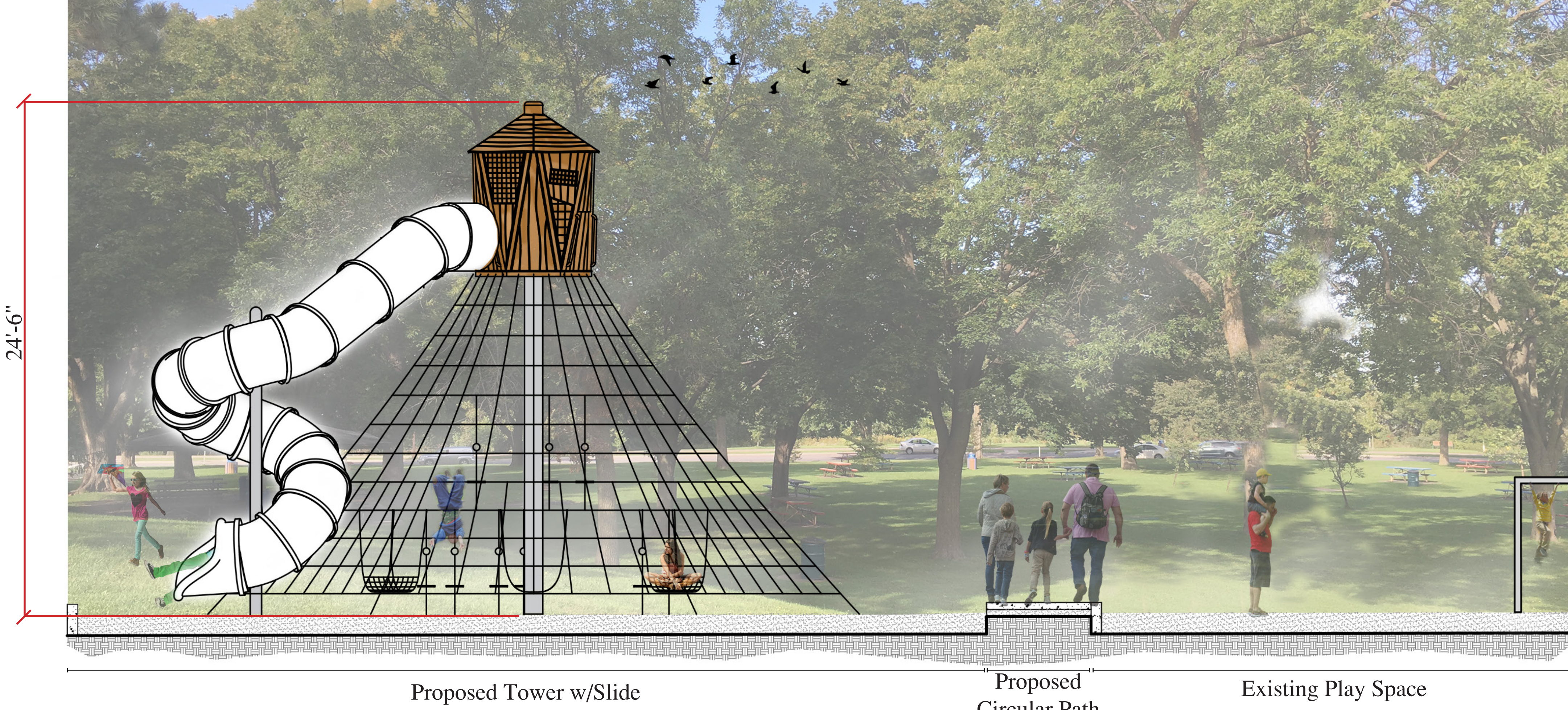
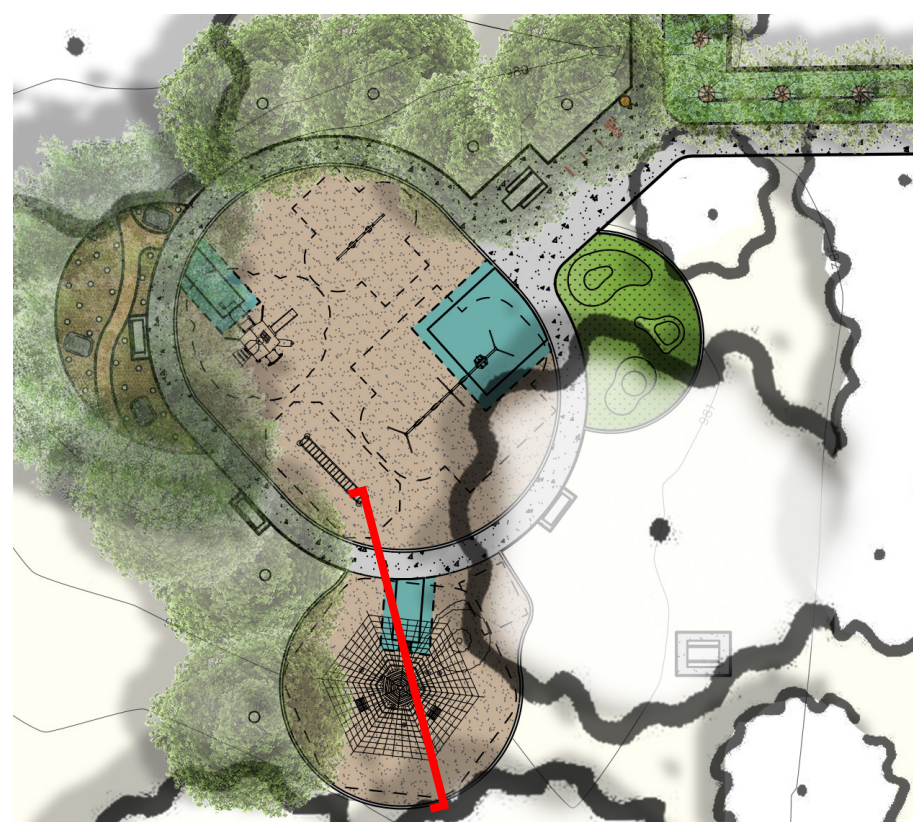

Section B

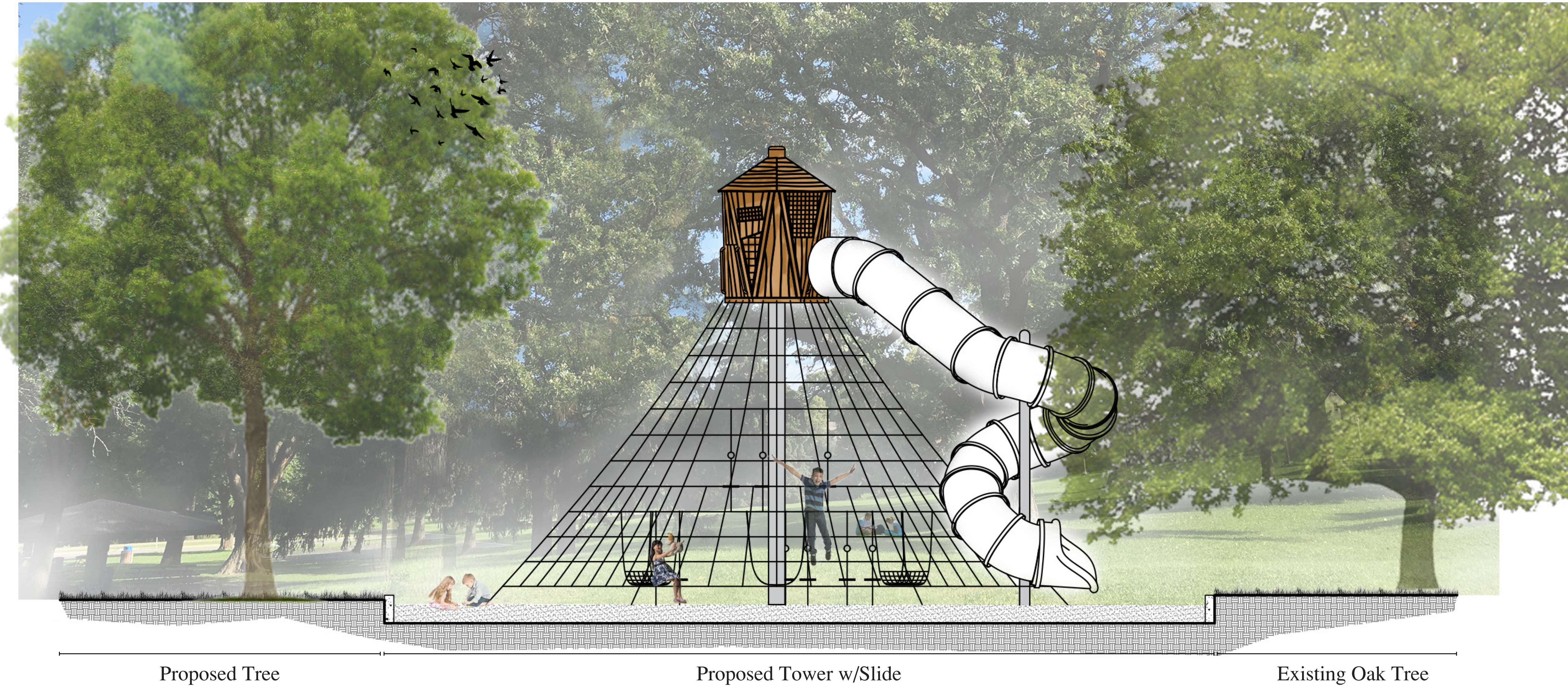
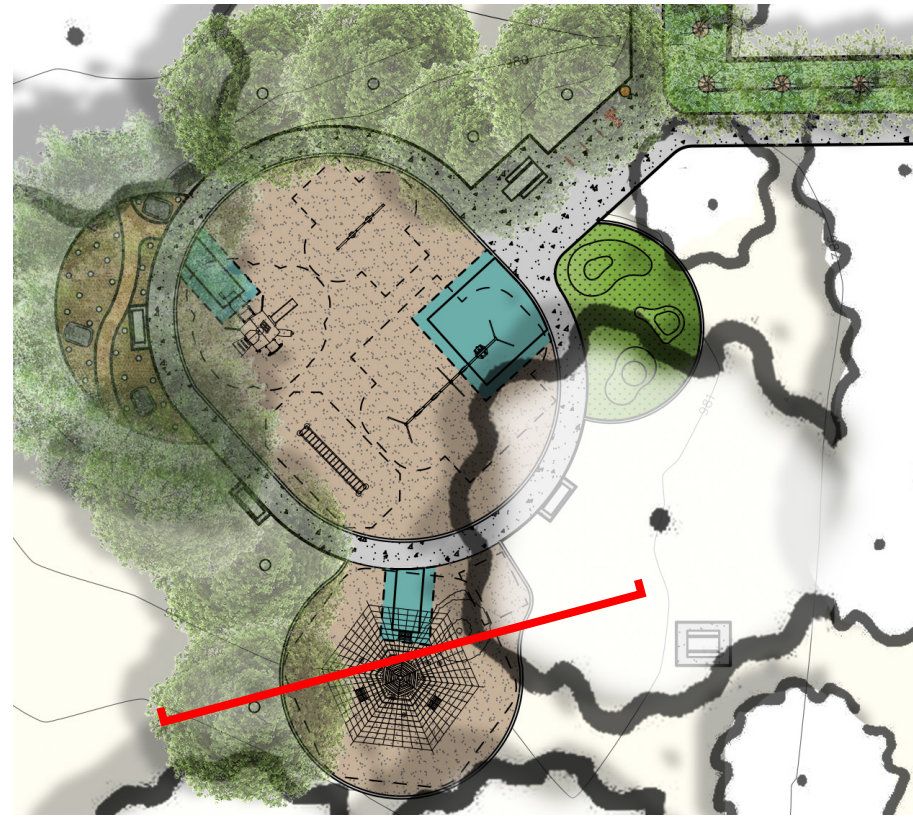

Cherokee Regional Park Play Area Improvements

-Sections-

February 16, 2017

Project Manager: Cheeneng Yang | Alice Messer
 Contact: 651-266-6414 | 651-266-6412
 Email: Cheeneng.Yang@ci.stpaul.mn.us | Alice.Messer@ci.stpaul.mn.us

