

SITE PLAN

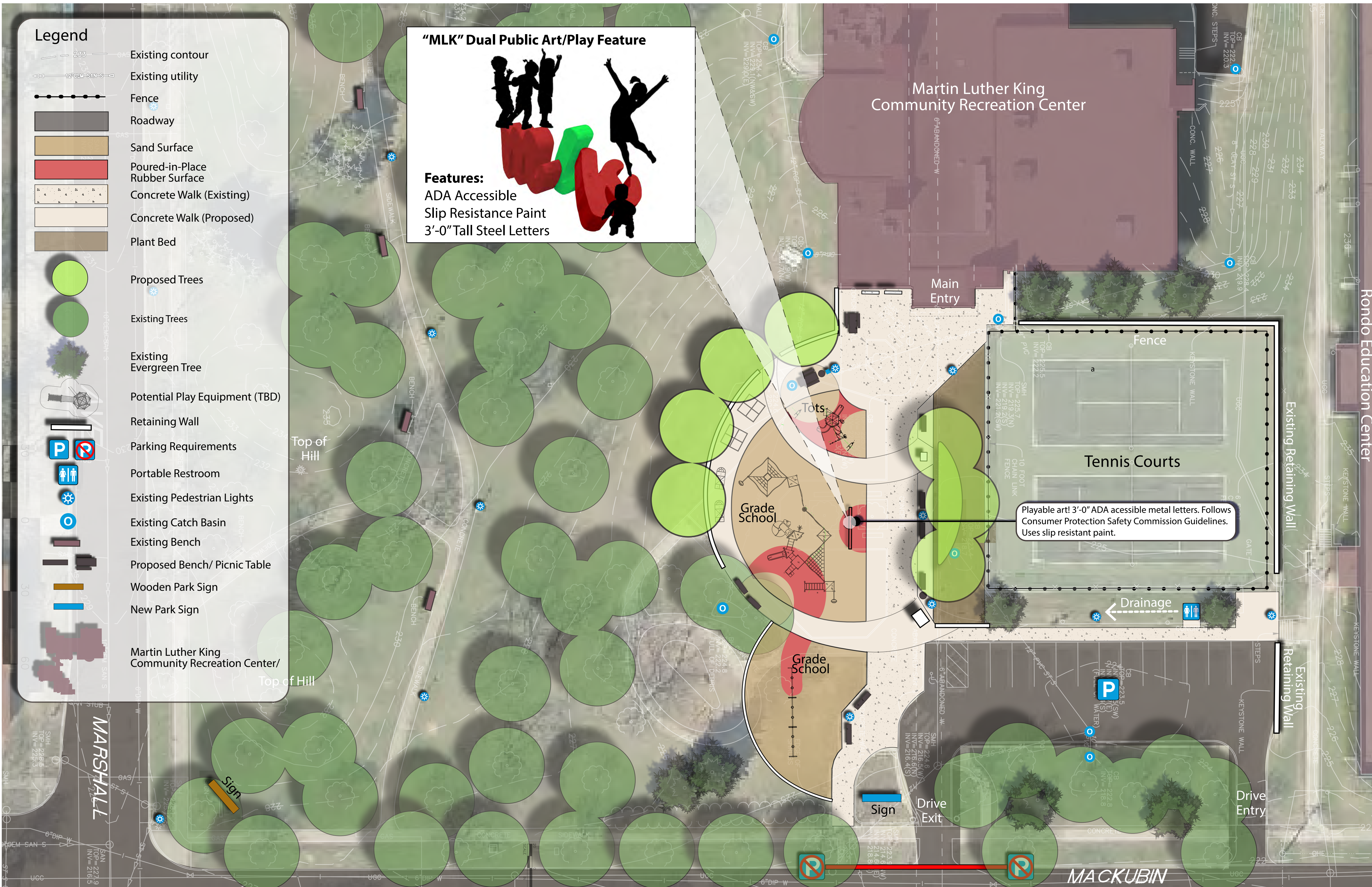

Rondo Education Center



Saint Paul Parks and Recreation

Project Manager: Brett Hussong
 Contact: 651-266-6420
 Email: brett.hussong@ci.stpaul.mn.us

MARTIN LUTHER KING Play Area Improvements

Site Plan

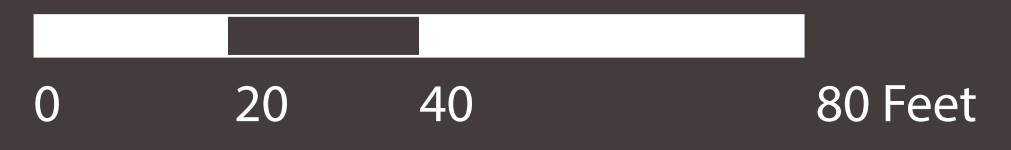

April 2016



Slip
Tripping
Structure
playground.com
This structure
has been designed
for children
with disabilities
and designed
to be accessible
to all children
and families.

Welcome

