

# SITE PLAN

LAKE AND LAND SURVEYING, INC.

1200 Centre Pointe Curve, Suite 275

Mendota Heights, Minnesota 55120

Phone: 651-776-6211

Survey Made For:  
 Mr. Charles Belcher  
 1346 Arcade Street  
 St. Paul, MN 55106

Legal Description  
 Lots 12 and 13, Block 7,  
 LANES PHALEN GROVE ADDITION,  
 Ramsey County Minnesota.

Site Address: 1346 Arcade Street, St Paul, MN 55106

### NOTES:

- Denotes 12 inch Common Spike set with washer stamped RLS 16464 or as noted.
- Denotes Iron Monument found size, type, & R.L.S. as noted.
- Denotes Gas Meter
- Denotes Overhead Wire
- Denotes Manhole Cover
- Denotes Power Pole
- Denotes Wood Fence
- Denotes Concrete Surface

AREA: 11,208 SQ. FT. OR 0.26 ACRES  
 BASIS OF BEARINGS: ASSUMED  
 LAKE & LAND SURVEYING. JOB NO. 2019.009-PP

I certify that this survey, plan or report was prepared by me or under my direct supervision, and that I am a duly Registered Land Surveyor under the laws of the State of Minnesota.

*Jonathan L. Faraci*

Revised February 26, 2020  
 October 21, 2019

Jonathan L. Faraci  
 Registered Land Surveyor & Registered Engineer  
 Minnesota Registration No. 16464

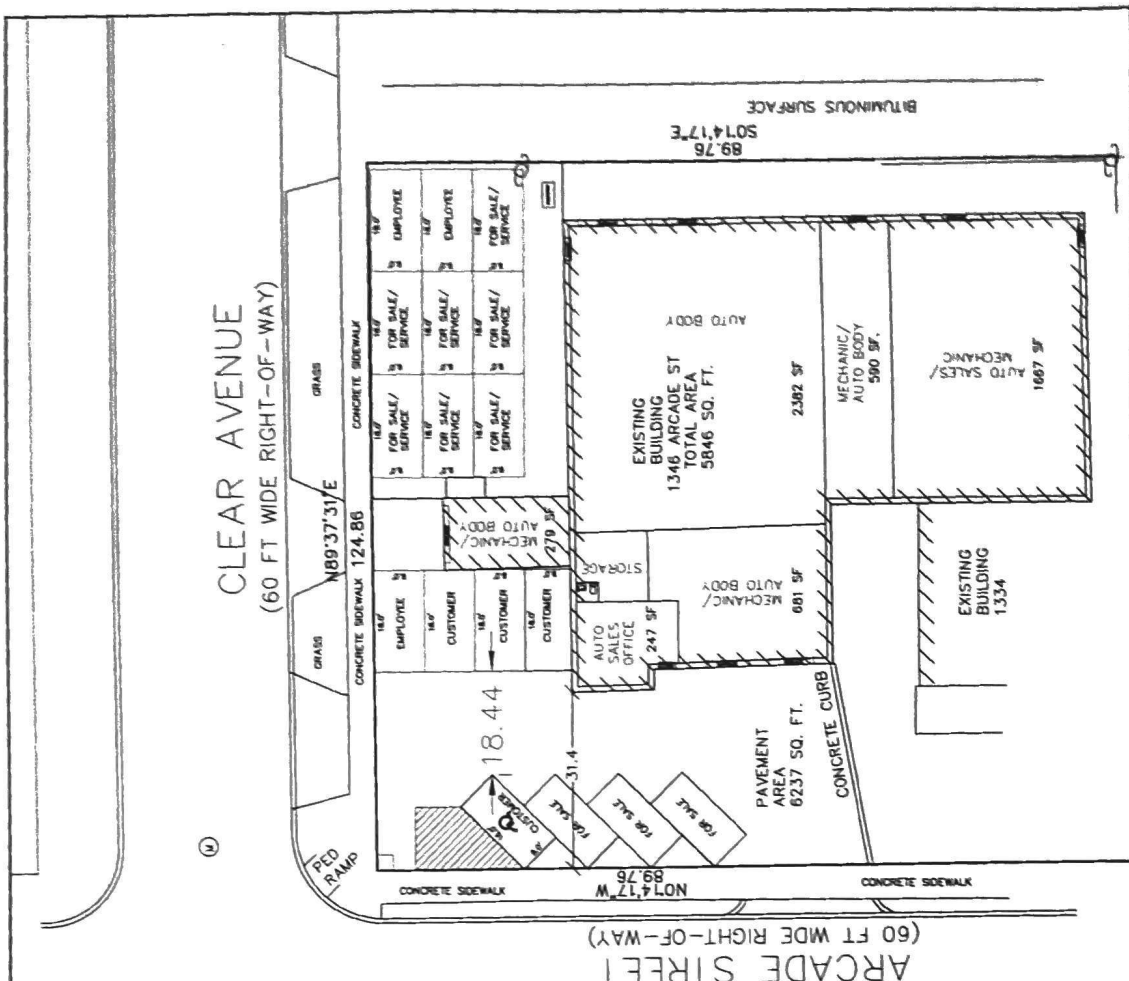

ARCADIE STREET  
 (60 FT WIDE RIGHT-OF-WAY)

SCALE  
 1 inch = 20 ft.