

March 15 Open House & Open Saint Paul Results

Jobs and Businesses

5 Questions:

- * What types of jobs (office, retail, hospitality) would you like to see as part of the larger stadium site?
- * What types of specific uses would you like to see on the redevelopment site (i.e. medical office, entertainment, types of service)
- * Are there any business types that have not been mentioned that you think should be included on the site?
- * How important is it for small, local, and/or minority owned businesses to part of the new retail?
- * How important is local hiring for new jobs on the site? (i.e. local hiring can be based on zip codes of area residents)

Key Points: Jobs and Businesses

- There were 5 comments indicating a preference for creating new living wage/high wage jobs.
- 10 comments indicated a preference for new businesses to be local.
- 10 comments mentioned food services. (E.g. restaurants, coops, groceries) with many of the respondents specifying that they do not want new chain restaurants.
- 5 responses mentioned affordability in regards to new services and the rent for new businesses.

Jobs and Businesses Vote Totals

How important is it for small, local, and/or minority owned businesses to part of the new retail?

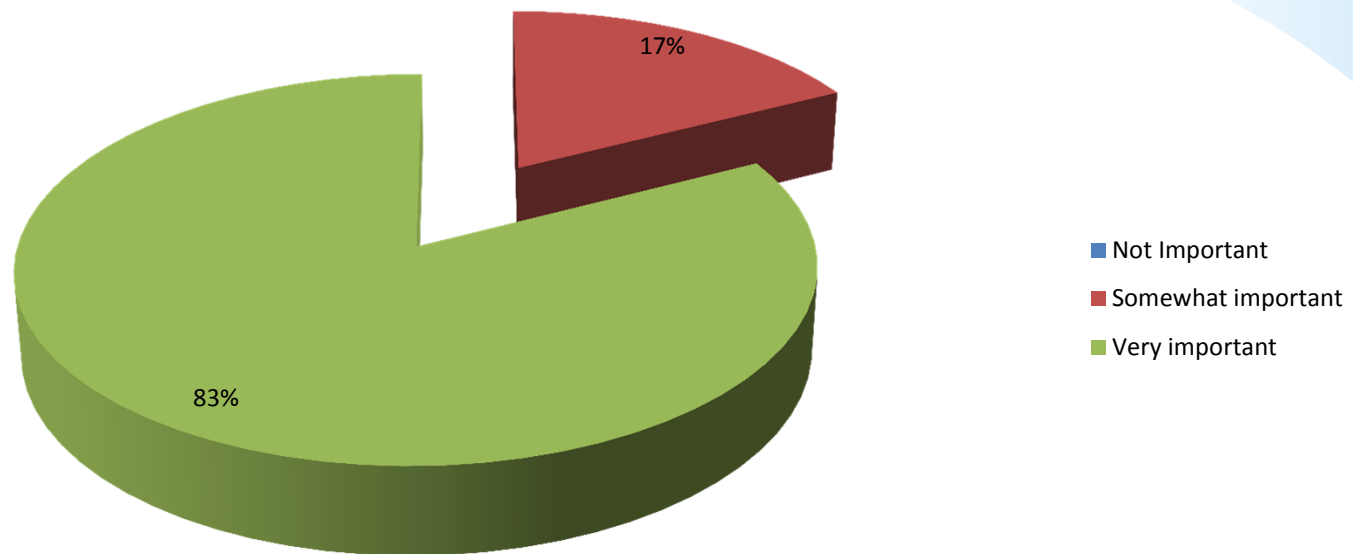

| Not Important | Somewhat important | Very important |
|---------------|--------------------|----------------|
| | 7 | 33 |

Jobs and Businesses Vote Totals

How important is local hiring for new jobs on the site? (i.e. local hiring can be based on zip codes of area residents)

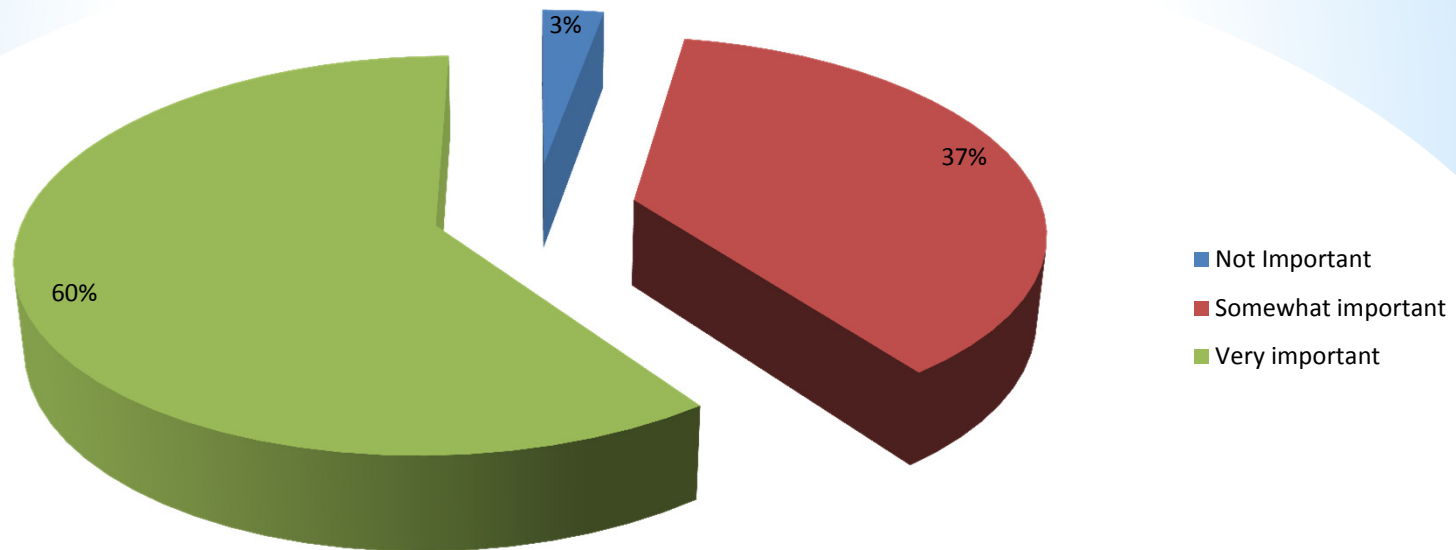

| Not Important | Somewhat important | Very important |
|---------------|--------------------|----------------|
| 1 | 13 | 21 |

Comment: Does local zip codes include transit shed?

Master Plan Concepts

- *What do you like about the concepts you have seen?
- *How do you feel about the layout for the whole site?
- *What do you have concerns about?

Master Plan Concepts key points

- * 12 comments - concern about the scale of the new development specifically in regards to the height of the new office buildings and doubts about the demand for the amount of proposed office space.
- * 3 comments - supportive of the proposed scale of the new structures.
- * 3 comments - identified green space as a desirable feature of the master plan concepts. One comment suggested building a land bridge to increase the amount of open space on the site.
- * 4 comments - identified the lack of parking as an issue and concern.

Master plan: office concerns

- * Great design, but it will be a challenge to get a developer to build that many square feet of office.
- * I have no problem with the stadium design. I have a big problem with RK midway's ideas for mega office towers and diminished retail. Midway shopping center needs reinvestment.
- * Who is going to build a big office building if there is no parking.
- * The office high rises detract from all the other positives. So unnecessary and dense.
- * Height of the buildings are too tall. They dwarf the single family homes in the area.
- * These buildings will cast huge shadows on the homes already there.
- * Office building height.
- * Spruce tree center has been 4/5 empty for 20 years. What informs that these office buildings will have demand? Is it build it and they will come?
- * Some building seem to tall. Keep to less then 6 stories?
- * Keep height of buildings to neighborhood context.
- * Buildings that RK midway proposes are way too large for this area.
- * Proposed office and hotel buildings seem too big (tall)

Stadium Concepts

- *What do you like about the stadium concepts you have seen?
- *What do you think about the stadium architecture, size, and the buildings connection to the street?
- *What do you have concerns about regarding the stadium?

Stadium Concepts

- * 18 comments about the stadium were generally positive. I.e. “Love it!”
“The design looks great”
- * 8 comments expressed concerns about traffic and parking.
- * 6 comments inquired about sustainability aspects of the stadium, specifically if solar and noise could be harnessed for the production of renewable energy, if the stadium would be zero waste, and if grey water could be reused on the site.
- * 4 comments expressed a favorable disposition in regards to the size of the stadium.
- * 3 comments were generally negative I.e. “I don’t like it”

Types of Uses

- *What do you think about the proposed mix of land uses on the site?
- *Would you like to see affordable housing located on the site?
- *Which of these would you like to see built first?

Types of Uses Key Points

- *The “a brewery” comment received 8 votes in support of the idea.
- *The “we don’t need another gym” received one vote with a similar comment “I think the YWCA covers us working out” also present on the boards.

Types of Uses

Would you like to see affordable housing located on the site?

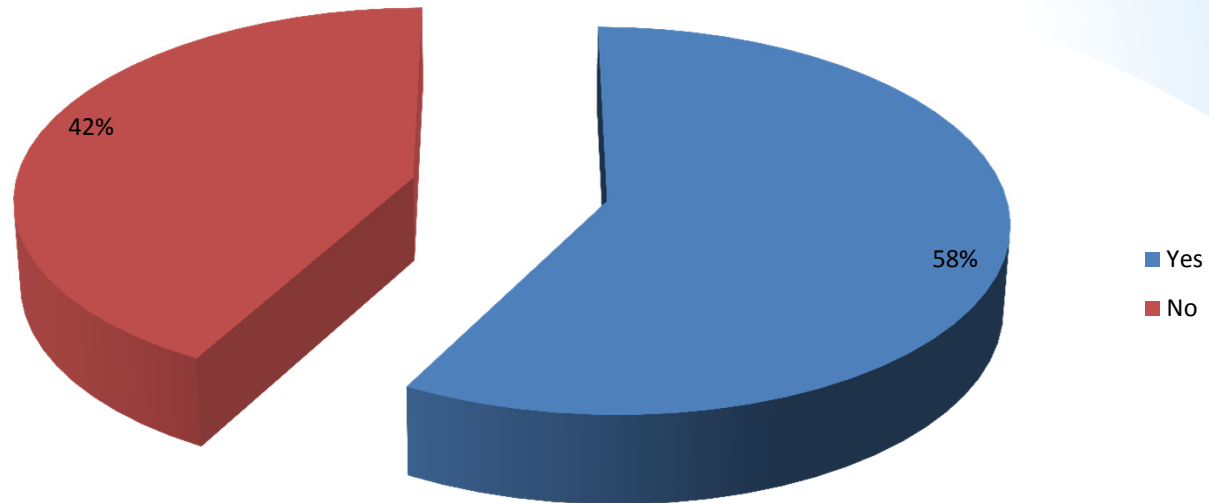

| Yes | No |
|-----|----|
| 22 | 16 |

Types of Uses

Which of these would you like to see built first?

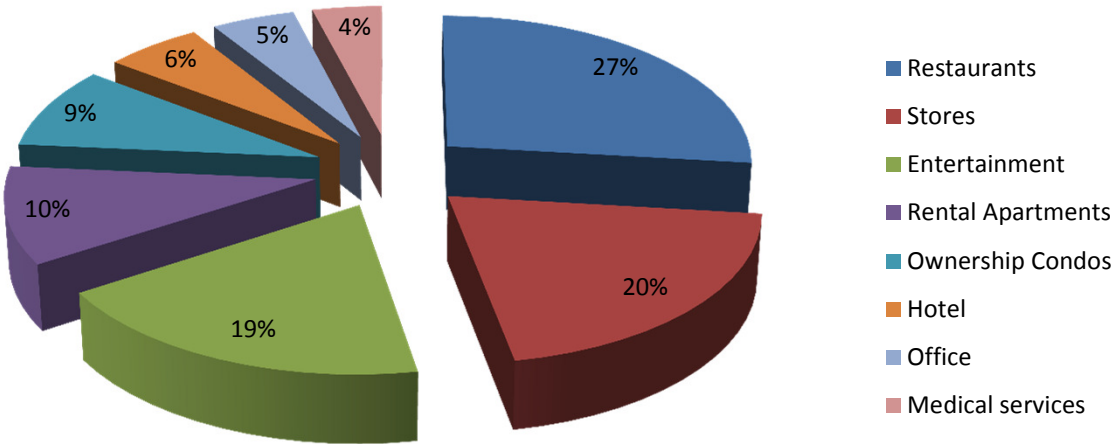

| | |
|-------------------|----|
| Restaurants | 33 |
| Stores | 25 |
| Entertainment | 23 |
| Rental Apartments | 13 |
| Ownership Condos | 11 |
| Hotel | 7 |
| Office | 6 |
| Medical services | 5 |

Community Character and Public Life

- *What do you think of the proposed green spaces and street environments?
- *What type of spaces would you like to see/do in these spaces?
- *How can these spaces reflect the community's character?
- *What elements of the streetscapes are most important to include?

Community Character and Public Life

- *“Music festivals” (3 votes) was the most popular activity that people would like to do in the spaces.
- *“Free winter ice skating” (2 votes) and “Ice rink in winter? Farmers market! Pick-up soccer/ultimate/etc.” (votes)
- *3 comments mentioned diversity as a way to ensure that spaces reflect the community’s character.

Community Character and Public Life

What elements of the streetscapes are most important to include?

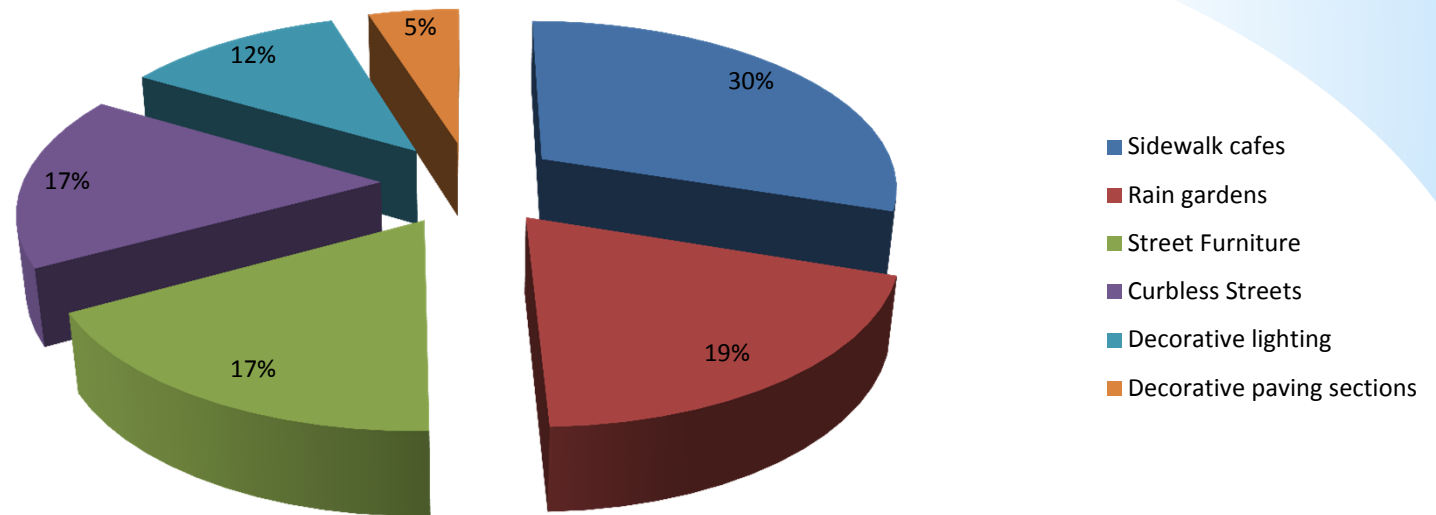

| What elements of the streetscapes are most important to include? | |
|--|----|
| Sidewalk cafes | 31 |
| Rain gardens | 20 |
| Street Furniture | 18 |
| Curbless Streets | 17 |
| Decorative lighting | 12 |
| Decorative paving sections | 5 |

Getting There

- * How well does the full site plan encourage walking, biking, and transit use - both for game days and non-game days?
- * What do you think about how traffic, vehicle entry points, and parking are proposed to be handled?
- * What would make this a safe area for people to walk?

Getting There Key Points

- * 19 comments - pertained to bike infrastructure and routes, which include comments stating the respondent's desire for protected bike lanes and adequate bike parking.
- * 6 comments - expressed concern about that there isn't adequate parking. 2 comments called for limiting parking.
- * 4 comments - identified lighting as being an important aspect in making sure that this is an area where people want to walk.
- * 8 comments - identified specific improvements to the pedestrian infrastructure to make this an area where people want to walk such as, wider sidewalks with narrower traffic lanes, better timed signals, and traffic calming features.

Public Art

- * How can public art reflect and connect with the surrounding neighborhoods?
- * Which kinds of public art do you think would be the best fit for this site?

Public Art: key points

- * 7 comments called for using local artists as a means to reflect and connect with the surrounding neighborhood.
- * 3 comments called for multicultural art to be present on the site.

Public Art

Which kinds of public art do you think would be the best fit for this site?

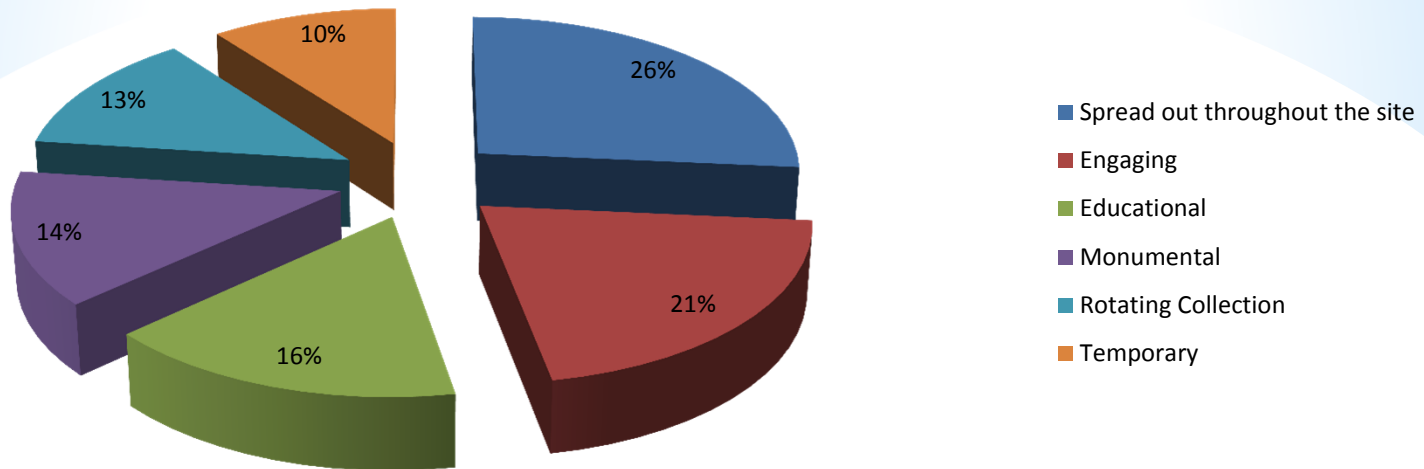

Which kinds of public art do you think would be the best fit for this site?

Spread out throughout the site

23

Engaging

18

Educational

14

Monumental

12

Rotating Collection

11

Temporary

9

Stormwater and Public Art

- * Does this statement reflect your vision for the Snelling Midway Area. "Creatively using open space to manage storm water." why or why not.
- * Do you agree with this statement? If the children enjoy being there then the adults will follow. Why or why not.
- * What images does this reflect for you? "Public art incorporated into green space"

Key points

- A strong majority envision creatively using open space to manage storm water.
- There were mixed perspectives about whether if children enjoy being there, adults will follow.

Stormwater and Public Art

What images does this reflect for you? “Public art incorporated into green space”



10 votes



12 votes



13 votes



4 votes

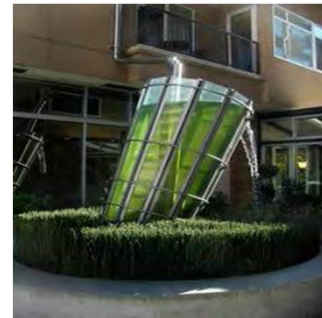

5 votes

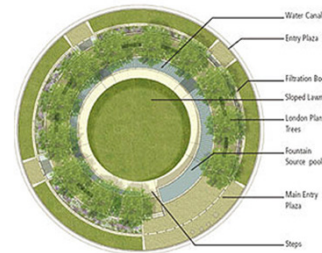

5 votes



5 votes

Overall Vision and other topics

- *What goals do you think this site will accomplish?
- *What other topics are important to pay attention to?

Key points

- 5 comments indicate that they hope the site will become a new “destination”
- 4 comments indicate the impacts that the redevelopment could have on the surrounding communities are important to pay attention to. (I.e. housing prices and gentrification)

Technical Advisory Committee Stormwater Workshop

Snelling-Midway Redevelopment Site
January 26, 2016





Strategic Stormwater Solutions for Transit-Oriented Development

FINAL REPORT

SAINT PAUL, MN

DECEMBER 23, 2013

Snelling-Midway CAC 3/31/16

Rainfall as a Resource

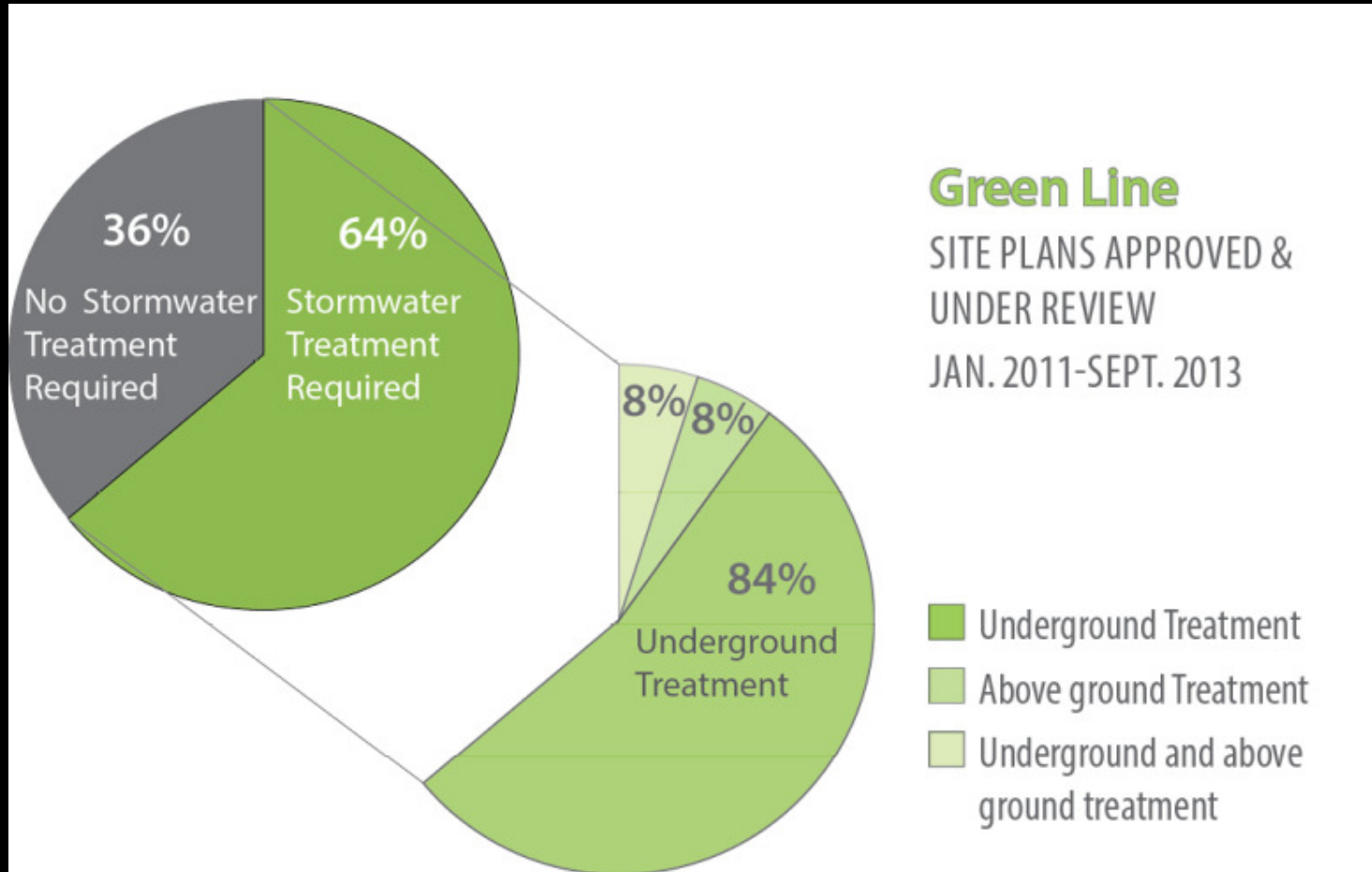

DEFINITION OF SSGI

SHARED

STACKED

GREEN
INFRASTRUCTURE

GREEN
INFRASTRUCTURE
ELEMENT IS
SHARED BETWEEN
MULTIPLE
PROPERTY
OWNERS

- PRIVATE-PRIVATE
- PRIVATE-PUBLIC
- PUBLIC-PUBLIC

PROVIDES ADDED
VALUE BEYOND
STORMWATER
MANAGEMENT BY
CONTRIBUTING TO
TRIPLE BOTTOM
LINE

- ECONOMIC
- SOCIAL
- ENVIRONMENTAL

USES LANDSCAPE
FEATURES AND/
OR NATURAL
PROCESSES TO:

- MANAGE
STORMWATER
- PROVIDE
ENVIRONMENTAL
BENEFITS

Stormwater - Early Evaluation

2013 "Bus Barn"

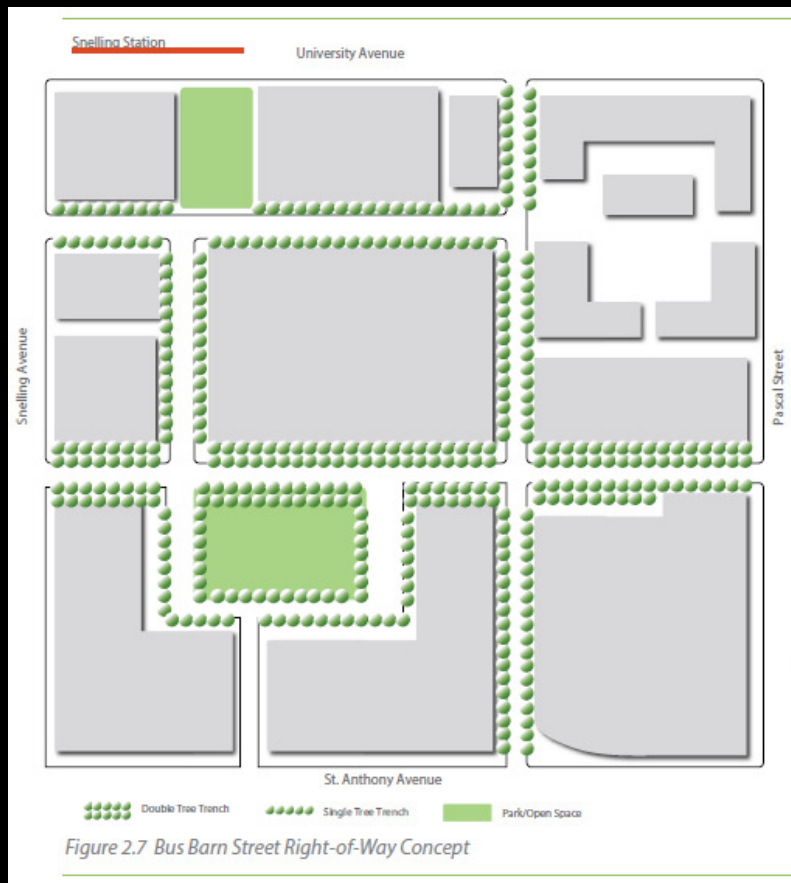

2014 "Smart Site"



Stormwater Workshop Approach

- **Purpose:**
 - Catalyze comprehensive stormwater planning for the Midway site.
- **Goals/Outcomes:**
 - Facilitate discussion of stormwater options; capture TAC priorities
 - Develop narrative and visual suggestions for Midway site Master Plan
 - Collect ideas to test with CAC and community via topic tables



Workshop Focus

- Inform site planning process
- Inclusive ideas - whole site
- Inspire creativity
- Innovate - think big

Workshop Structure

- Showcase precedent projects
- Key questions and statements
 - Also for public input
- Hands-on visioning exercise



Public Open House Meeting

STORMWATER

RESIDENTIAL
METAL ROOFING (e.g., asphalt shingles) Surface
PERMEABLE SURFACE (e.g., grass)

COMMERCIAL
UNDESIRABLE SURF (e.g., asphalt or concrete) Surface
PERMEABLE SURFACE (e.g., grass)

RESIDENTIAL
WOOD SHAKES (e.g., cedar) Surface
PERMEABLE SURFACE (e.g., grass)

COMMERCIAL
UNDESIRABLE SURF (e.g., asphalt or concrete) Surface
PERMEABLE SURFACE (e.g., grass)

Polluted rainwater runoff carries dirt, oil, and trash to the Mississippi River.

Managing stormwater with green infrastructure can help reduce pollution in the Mississippi River.

COMPLETE THIS SENTENCE:
Stormwater could enhance redevelopment by _____.
WRITE ANSWER ON POST-IT AND PLACE ON TABLE

WHICH STORMWATER MANAGEMENT APPROACH DO YOU PREFER?
PLACE DOT BELOW PICTURE

| | | | |
|--------------------------------------|------------------------------------|---------------------------------------|--------------------------------|
| INTERACTIVE WATER FEATURE | PERMANENT WATER FEATURE | INTERMITTENT WATER FEATURE | RAIN GARDENS |
| TREE TRENCH | PERMEABLE PAVEMENT | ABOVE GROUND CISTERN | UNDERGROUND CISTERN |

Shelling-Midway CAC 3/31/16

Interactive Approach

Real-time Polling

- Name one thing you want to get out of today's workshop.
- Which stormwater management approach do you prefer?
- Stormwater could enhance redevelopment by:
- What idea from today's workshop would you like to see in the master plan?

Results

Snelling-Midway
Redevelopment Site:
Stormwater Workshop
January 26, 2016

Poll Results



Interactive Approach

Real-time Polling

- Name one thing you want to get out of today's workshop.
- Which stormwater management approach do you prefer?
- Stormwater could enhance redevelopment by:
- What idea from today's workshop would you like to see in the master plan?

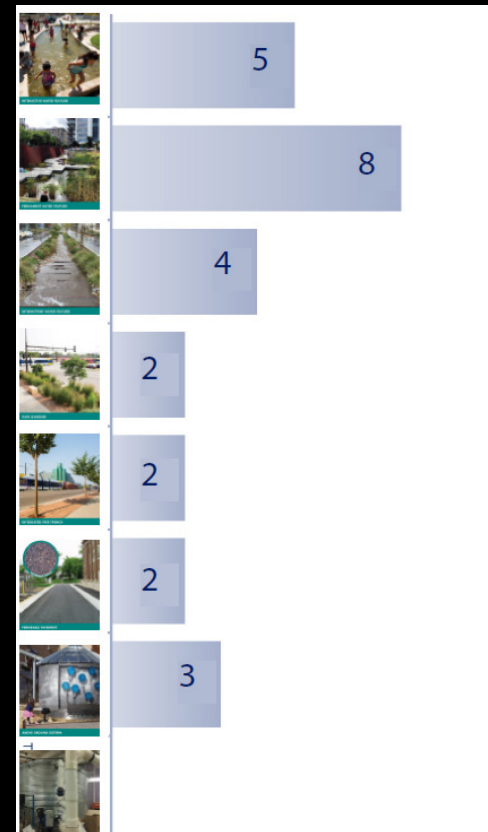

Interactive Approach

Real-time Polling

- Name one thing you want to get out of today's workshop.
- Which stormwater management approach do you prefer?
- Stormwater could enhance redevelopment by:
- What idea from today's workshop would you like to see in the master plan?



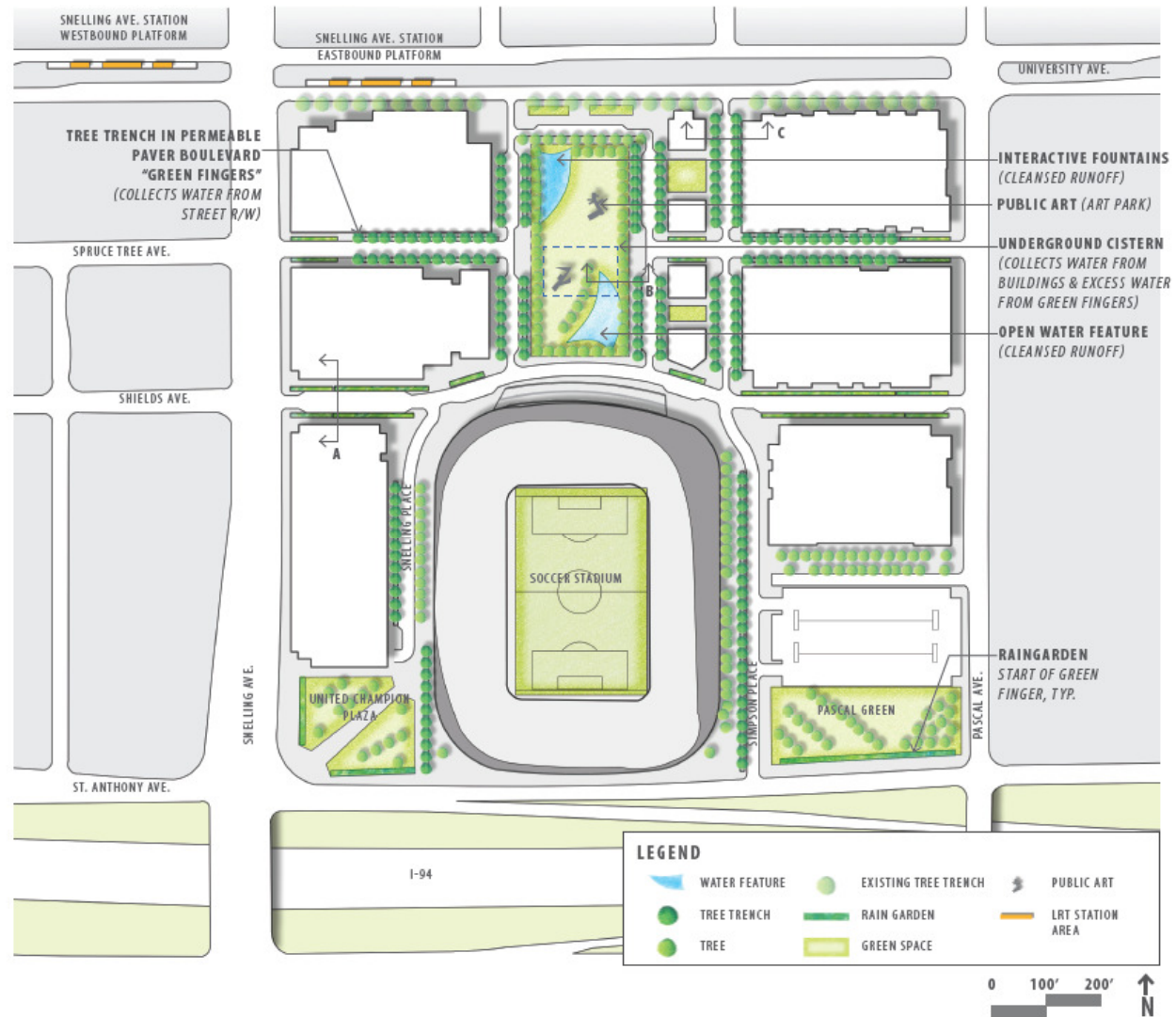

SRE Major District with Green Fingers Concept Plan
 Consulting Group, Inc. Snelling-Midway SSGI
 9130 | 160224 St. Paul, Minnesota

Figure 1

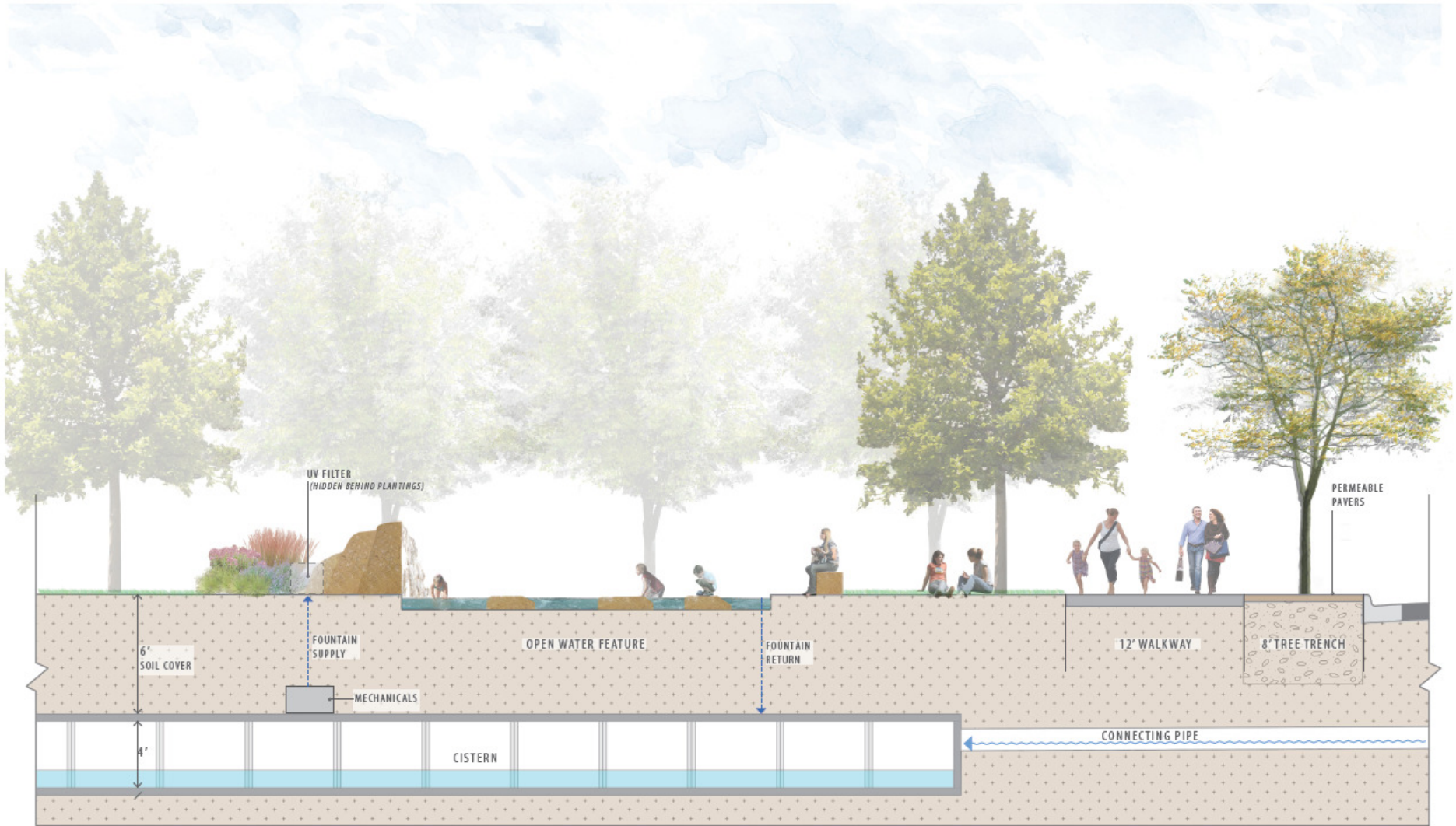

SRI Consulting Group, Inc. 9130 | 160224
Section B - Park with Open Water Feature and Underground Cistern
 Snelling-Midway SSGI
 St. Paul, Minnesota

Figure 6

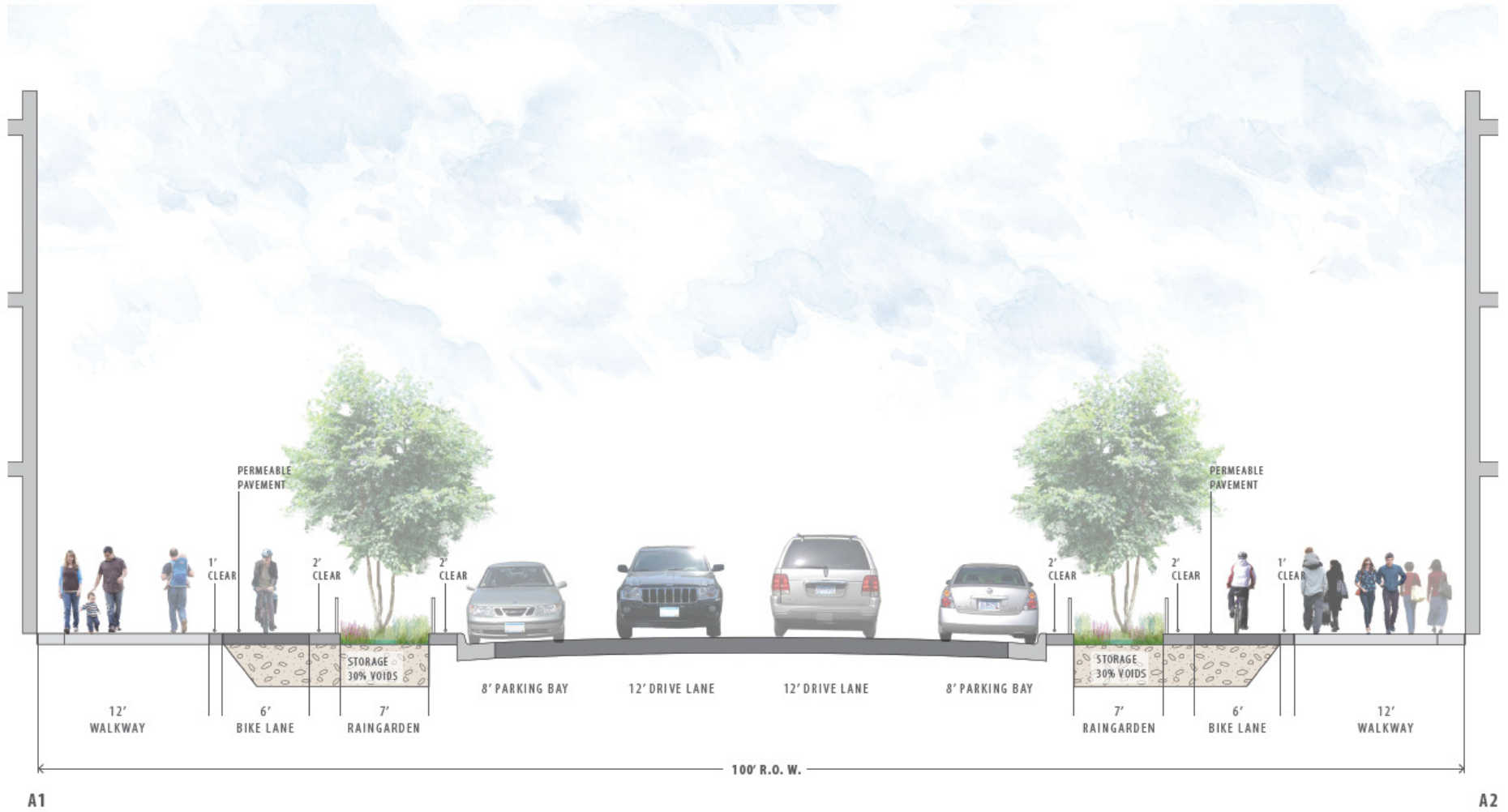

SRE Section A - Shields Avenue
 Consulting Group, Inc. Snelling-Midway SSGI
 9130 | 160224 St. Paul, Minnesota

Figure 5

LANDSCAPE: SUSTAINABILITY AND STORMWATER INITIATIVES

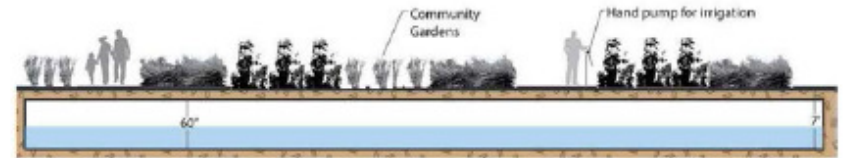
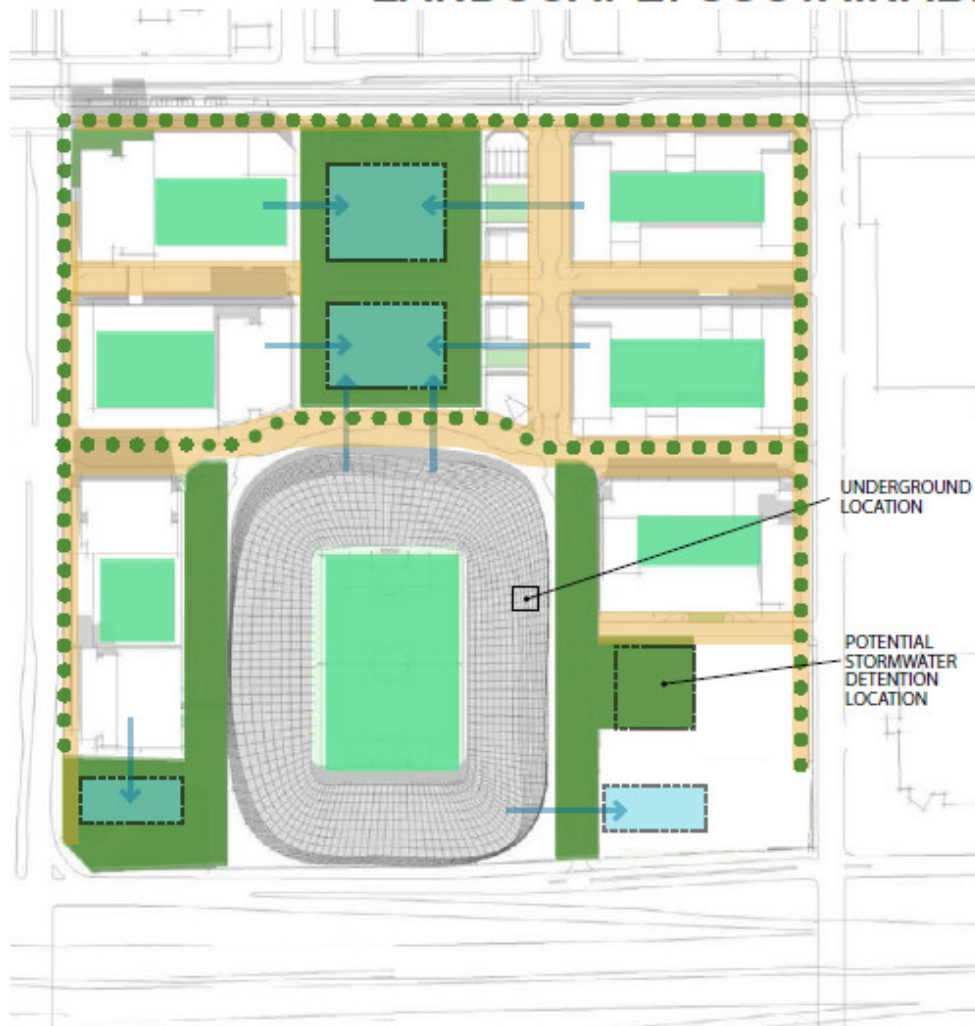

- PERVIOUS SURFACE/
PAVING/LANDSCAPE
- GREEN ROOF
- PERMEABLE PAVING
SURFACE
- IRRIGATION CISTERN
- SIDEWALK LANDSCAPE/
RAIN GARDEN
- POTENTIAL CENTRALIZED
GREY WATER RECYCLING
STATION

Technical Advisory Committee Stormwater Workshop

Snelling-Midway Redevelopment Site
January 26, 2016



Snelling Midway CAC

Update on Transportation Study and AUAR

March 31, 2016



TOPICS

- Transportation Study: Inputs and Assumptions
 - Stadium Capacity
 - Event Timing
 - Master Plan and Phasing of Development
 - Direction of Approach
 - Modal Split
 - Parking Locations
- Transportation Study: Next Steps
 - Continue modelling (including pedestrian and bicycle movements)
 - Developing recommendations and mitigation plan
- AUAR
 - Keys Items and Status
 - Schedule Review



Transportation Study

...



Inputs and Assumptions

- Stadium Capacity
 - 20,000 at open (2018)
 - 25,500 maximum
- Game Times
 - Weekday evenings
 - Saturday afternoons
- Master Plan
 - Trip generation based on square footage of commercial and retail space, number of residential units, and hotel rooms. Assume no new development at year of stadium open (2018)



Direction of Approach (Events)

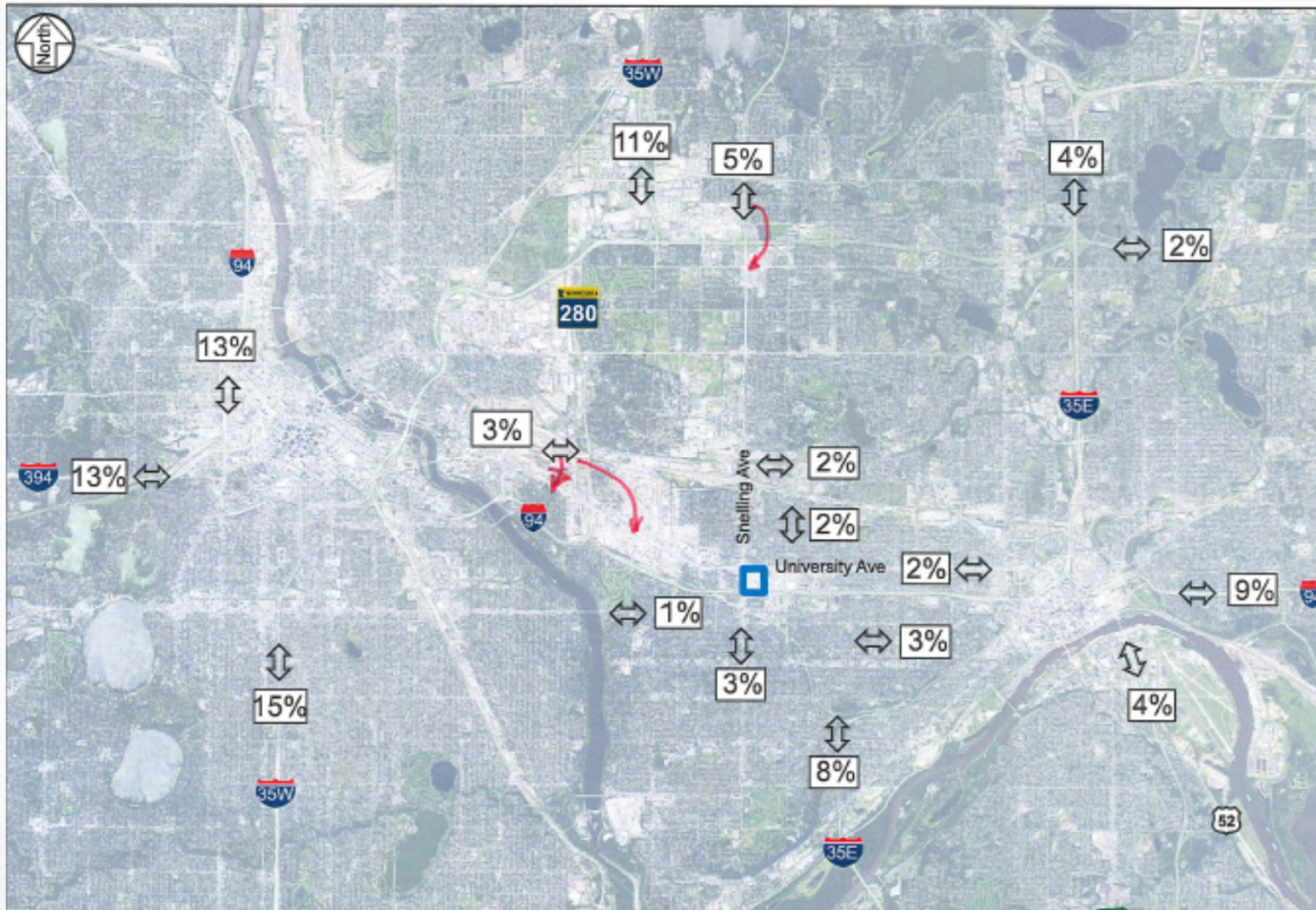

Inputs and Assumptions

- Modal Split and Parking
 - Finalizing assumptions for stadium and non-stadium development
 - Looking at multiple options for parking and getting to and from game
 - Regular route transit/A Line BRT/Green Line LRT
 - Shuttles/charters/express buses
 - Remote parking locations
 - Onsite parking
 - Metro Transit studying how to maximize system capacity

Next Steps

- Continue Modeling of Scenarios:
 - 2018 vs. 2035 (Build-out)
 - Events vs. Development Scenarios
 - Pedestrian and bicycle movement at key intersections
- Recommendations and Mitigation Plan
 - Changes to site access?
 - ROW alignment and design?
 - Operational considerations?
 - Other?

AUAR

...



Key Items and Status

- Transportation Study
 - Aiming for initial findings in May
- Noise Analysis
 - Stadium/event noise
 - Traffic-related noise
 - Working with MPCA
 - Aiming for completion of analysis by end of April
- Air Quality
 - Primarily related to traffic
 - Working with MPCA
- Light Impacts



Schedule Review

- Scoping EAW
 - Comment period closed March 23
 - Final “Order for Review” and responses to comments no later than April 15
- Draft AUAR and Mitigation Plan
 - Anticipated publication date of May 31
 - Comments through June 30
 - Public meeting prior to June 10 Planning Commission Public Hearing on Stadium Site Plan and Master Plan
- Final AUAR and Mitigation Plan
 - Anticipated mid-July, along with responses to comments received
 - 10-day Agency objection period
 - Final adoption by City before end of July



Questions?



[Obligatory Clip Art]