



Saint Paul Minnesota

Soccer Stadium Development Site

FACT SHEET: Community Vision for Snelling-Midway

The City of Saint Paul's plan for ongoing development around Allianz Field

The City of Saint Paul supports developments like Allianz Field to ensure our city works for our families, businesses, and cultural communities for years to come. The new soccer stadium is the centerpiece of the Midway Development District.

Working with property owners, developers, and the community, the City is working to build up an urban village for the community around the stadium which includes retail, office, residential, and public open spaces.

VISION FOR THE MIDWAY DEVELOPMENT DISTRICT

In addition to the construction plan that had guided Allianz Field, the City of Saint Paul has worked with property owners and architects to develop a plan for the full Midway Development District. This plan covers the full 34.5-acre site, with the expectation that projects under this plan will take place in phases over time.

Five primary principles guide the plan for the Midway Development District, and will guide future developments on the site:

- 1. A Walkable Neighborhood Focused on Transit**
The Midway Development District prioritizes direct, convenient, and safe pedestrian connections to nearby Green Line LRT and A-Line BRT stations.
- 2. Fitting into the Neighborhood**
The plan reconnects the street grid with walkable blocks to help the site fit into the walkable blocks of the neighborhoods surrounding the Midway Development District.
- 3. Public Open Spaces**
The Midway Development District plan emphasizes the creation of new public open spaces, and the connection of these new spaces to transit and pedestrian routes, and to existing parks and public spaces.



Speculative rendering of the Midway Redevelopment District



Saint Paul Minnesota

Soccer Stadium Development Site

4. **Diverse and Mixed-Use Developments**

New developments at Snelling-Midway will represent a mix of uses, from soccer at Allianz Field to office space, restaurants, retail, residential, entertainment, hotel, and open space. Across these various possible uses, the Midway Development District will prioritize sidewalk-level developments that interact with pedestrian activity and the surrounding area.

5.

Sustainable Development

The Midway Development District has been planned with sustainability in mind. Underneath the site, the City of Saint Paul has constructed a unique stormwater management system, the largest and smartest of its kind, which will recycle rainwater for Allianz Field and other future site developments.

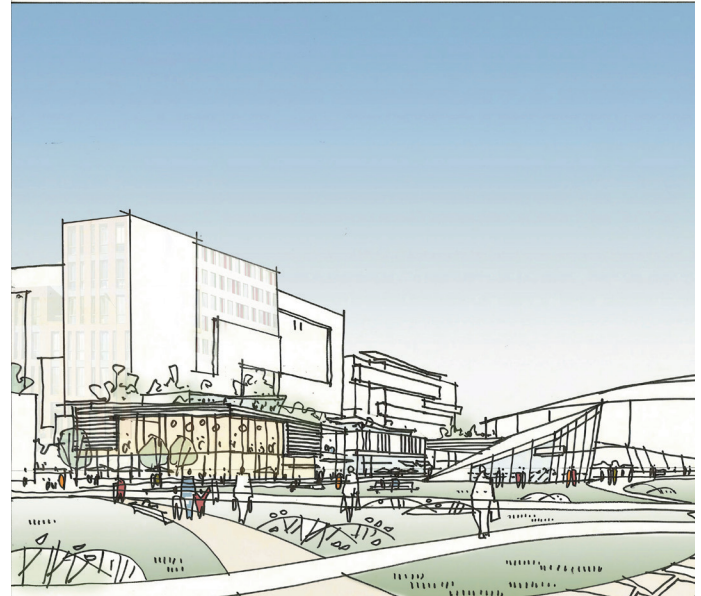

Speculative rendering of the Midway Redevelopment District

COMMUNITY ENGAGEMENT ON SNELLING-MIDWAY

Throughout the development of the plans for Allianz Field and the Midway Development District, community engagement and input have helped shape the priorities of the plans.

Feedback has been received through multiple channels, including:

- The Alternative Urban Areawide Review (AUAR) environmental review process
- The Snelling-Midway Community Advisory Committee
- Community open house events
- Online engagement efforts
- The Snelling-Midway Jobs Strategy Workgroup