



Saint Paul Minnesota

Soccer Stadium Development Site

FACT SHEET: Safe and Sustainable Transportation

The City of Saint Paul's Transportation Management Plan for Allianz Field

As part of the development of the new soccer stadium, a Transportation Management Plan (TMP) has been developed by the City of Saint Paul to help **safely move 20,000 people to and from the stadium on game days**, and to ensure a **positive experience for both fans and those who live, work, and operate businesses in the area**.

Through jobs, public spaces, visitors to local businesses, and more, the soccer stadium project brings our community together to support a positive vision for the future of our neighborhood. Key to that vision is a community where **transit, biking, walking and rolling are safe and accessible options** for city residents, commuters, and visitors.

This transportation plan builds on our successes – with the **Green Line LRT, A Line BRT, and improved bike and pedestrian facilities** – to ensure safe and sustainable transportation options connecting our community to the region for years to come.

Community input (received through the Snelling-Midway Master Plan process and the Alternative Urban Arapawide Review) identified three key concerns which have shaped the TMP:

- Minimize negative traffic impacts to surrounding neighborhoods
- Ensure bicycle and pedestrian safety for children, residents, and visitors
- Manage parking for the stadium and in the surrounding communities

Transportation experts with experience designing and managing transportation plans at other Minnesota sports facilities – including partners from Ramsey County, Metro Transit, and the Minnesota Department of Transportation – worked with the City of Saint Paul to put the values received from the community into action.

Community input established the guiding vision and principles of the TMP, and ongoing public input will help ensure those outcomes are achieved.

Through ongoing feedback from community and transportation partners, the TMP will be modified as needed to ensure a safe and positive experience for city residents, businesses, and fans alike.





Saint Paul Minnesota

Soccer Stadium Development Site

FACT SHEET: Safe and Sustainable Transportation

The City of Saint Paul's Transportation Management Plan for Allianz Field

TRANSPORTATION PLAN SUMMARY

As prioritized by community input and our vision for our city, the TMP prioritizes **safe and sustainable transportation options** including the Green Line Light Rail Train, the A Line Bus Rapid Transit line, local bus service, bikes, walking, and rolling for fans traveling to the new soccer stadium.

In addition to these primary methods, the plan encourages the use of park-and-ride lots outside of the Snelling-Midway neighborhood, with shuttle service to the soccer stadium, and taxi/ride share services.

To facilitate bus arrival and departure, taxi and ride share operations, and safe bike and pedestrian access, **some roadways immediately bordering the stadium site will have limited access on game days**. These controlled roadways will help ensure that pedestrian, bike, and vehicle access to area businesses will not be impeded.

Saint Paul Police will manage traffic control and safety on game days, including officers helping to direct pedestrian and vehicle traffic at certain key intersections. Metro Transit will assist with transit passenger boarding, drawing on their **expertise and learned experience managing high demand for transit for events at Target Field, U.S. Bank Stadium, and TFC Bank Stadium**.

Minnesota United will communicate directly to ticket holders and other fans traveling to the stadium. The team will encourage fans to make use of transit, park-and-ride, and other priority travel modes outlined above, and will encourage ticket-holders planning to park in the area to pre-purchase parking in a designated spot to reduce traffic circling and congestion.

The transportation plan includes significant, ongoing outreach and public education to ensure the safety of the community, including efforts to partner with the community to ensure a safe, positive game day experience for fans, residents, and business owners.

Anticipated Travel Modes

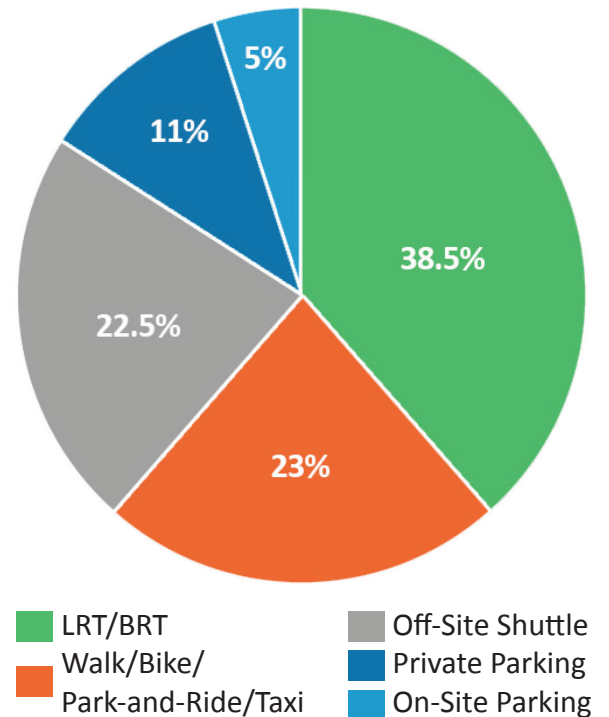



Saint Paul Minnesota

Soccer Stadium Development Site

FACT SHEET: Safe and Sustainable Transportation

Light Rail, Bus, and Shuttle Service

LRT and BRT Waiting Areas

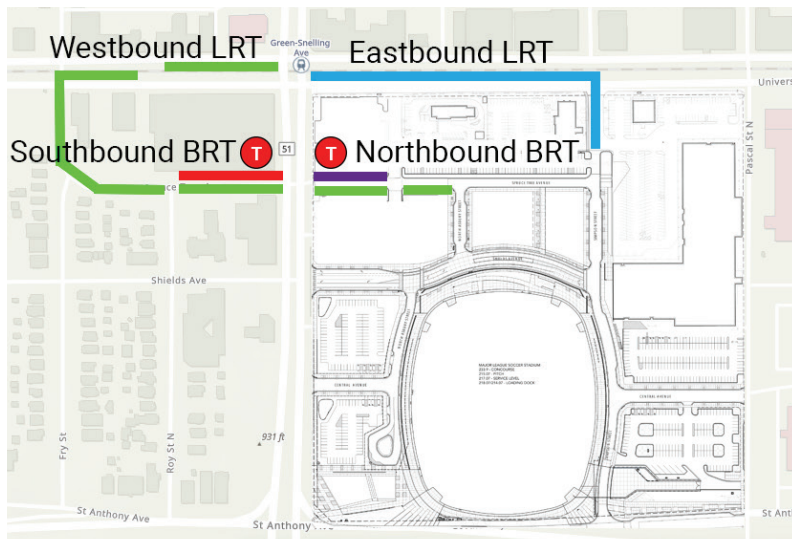

The map at left shows where lines will be managed for fans departing Allianz Field on the Green Line LRT and A Line BRT. Pedestrian right-of-way will be maintained along these routes. The green lines correspond with Westbound LRT, and the blue line with Eastbound LRT. The red lines correlate with Southbound BRT, and the purple lines with Northbound BRT.

The map below details local and shuttle bus service to Allianz Field, and how they will be routed with respect to the new stadium site.

Local Bus and Shuttle Routes and Stops

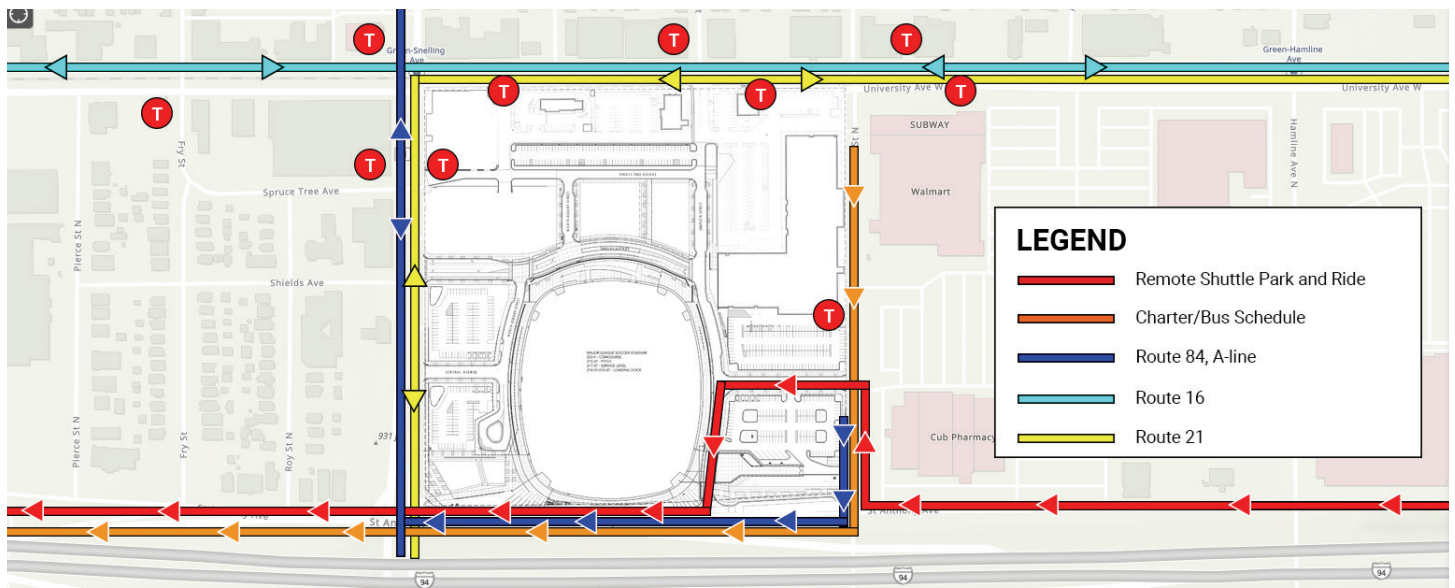



Saint Paul Minnesota

Soccer Stadium Development Site

FACT SHEET: Safe and Sustainable Transportation

Walk, Bike, and Roll

Pedestrian Routes

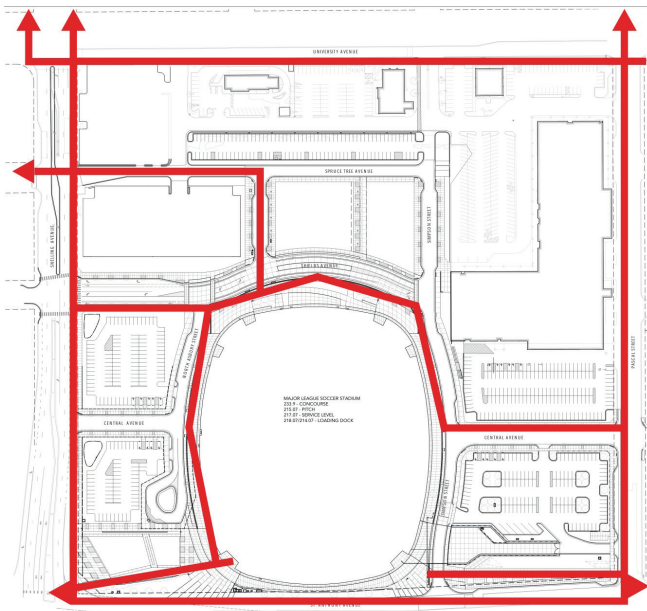

The map at left details the major pedestrian paths leading in, out, and through the new stadium site.

The map below details the priority bike routes in and out of the stadium, marked in blue, and the locations of 400 bike parking spots available on-site, in green.

Cyclists traveling north and south are encouraged to use the Pascal Street bike lanes. Cyclists traveling to or from the east are also encouraged to utilize Pascal to connect to bike facilities along Charles Avenue or Marshall Avenue.

Bike Routes

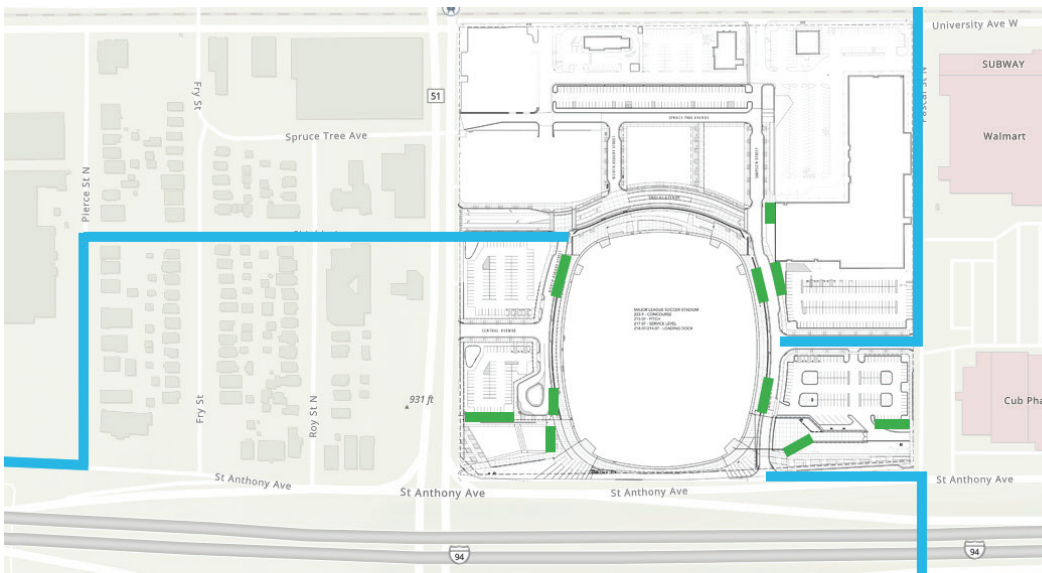

Cyclists traveling to or from the west are encouraged to utilize the bikeway on St. Anthony Avenue.



Saint Paul Minnesota

Soccer Stadium Development Site

FACT SHEET: Safe and Sustainable Transportation

Road Restrictions and Ride Share

The map below indicates planned roadway restrictions in the area surrounding Allianz Field on game days. These restrictions will help make sure that local access is maintained for residents, businesses, and workers in the area. The area colored green below will be restricted to maintain accessible for residents and businesses; the area in purple will be restricted to those needing access to the immediate area, such as the Spruce Tree parking ramp.

These roadway restrictions will also help manage pick-up and drop-off for taxis and ride share services, to minimize the impact of this vehicle traffic on the surrounding area. The zone designated for pick-up and drop-off can be seen below in blue.

Gameday Road Restrictions

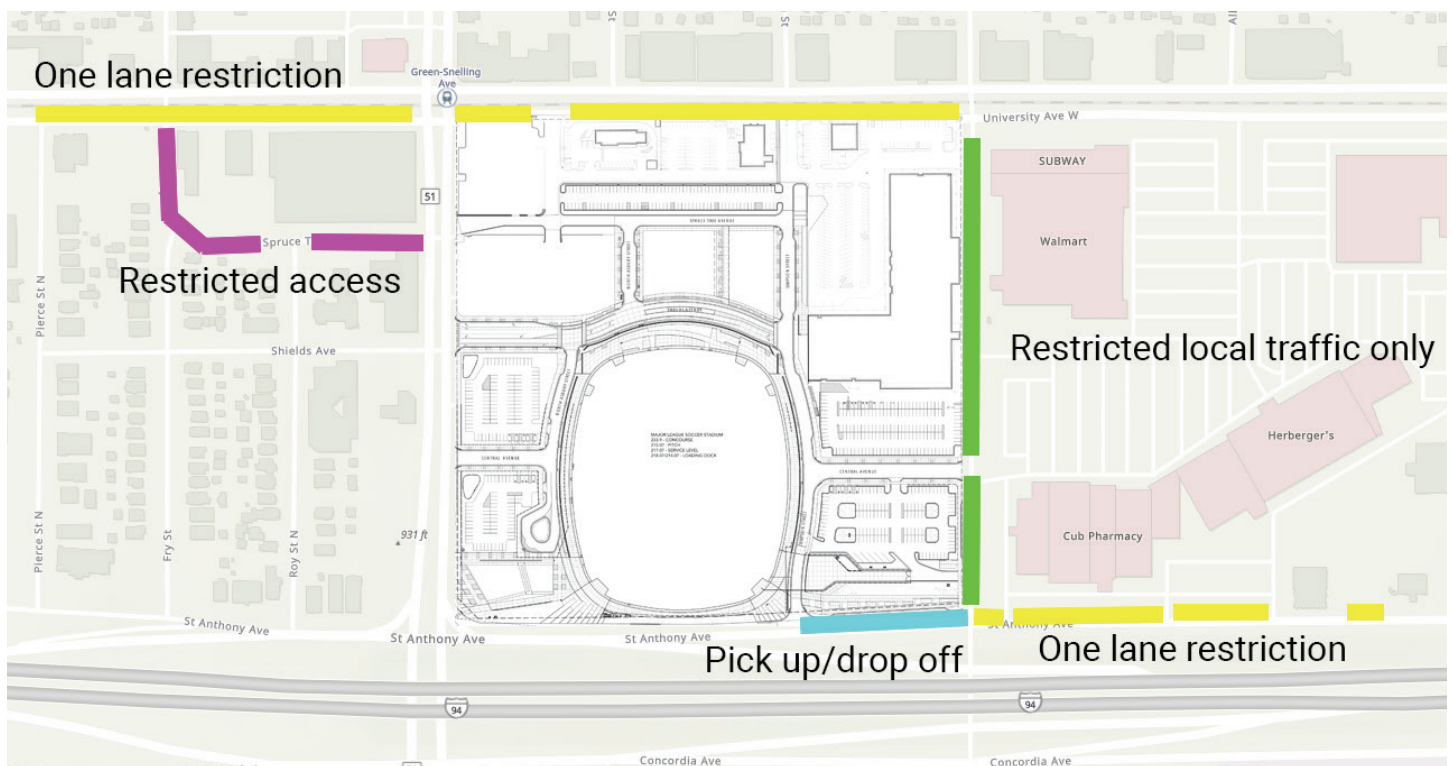



Saint Paul Minnesota

Soccer Stadium Development Site

FACT SHEET: Safe and Sustainable Transportation

On-Site and Nearby Parking

On-Site Parking

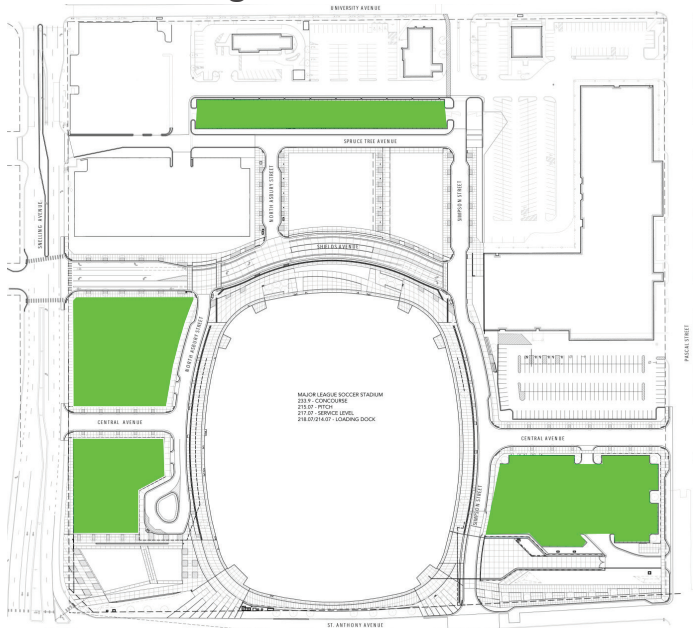

The map at left indicates the limited, restricted on-site parking at Allianz Field. The use of these limited spaces has been pre-designated by Minnesota United.

The map below details some of the nearby, private parking which Minnesota United has entered into an agreement to sell directly to fans. The use of these limited spaces will be managed by Minnesota United through agreements to sell these spots directly to fans.

Minnesota United is encouraging fans who plan to park in the area of Allianz Field to

Area Private Parking

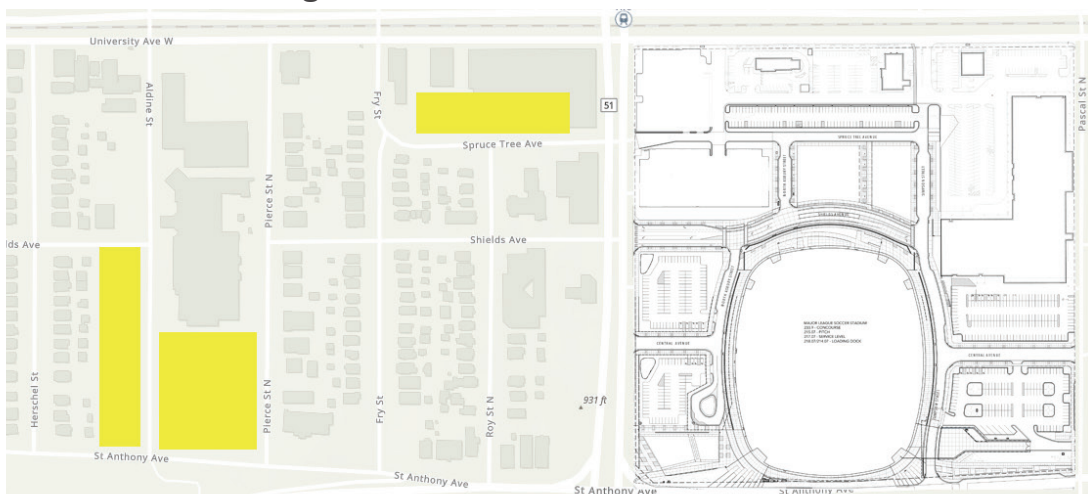

have a clear plan determined before the game, including pre-purchasing parking direct from Minnesota United.